

M5_Capitol 1 for KLRD TR

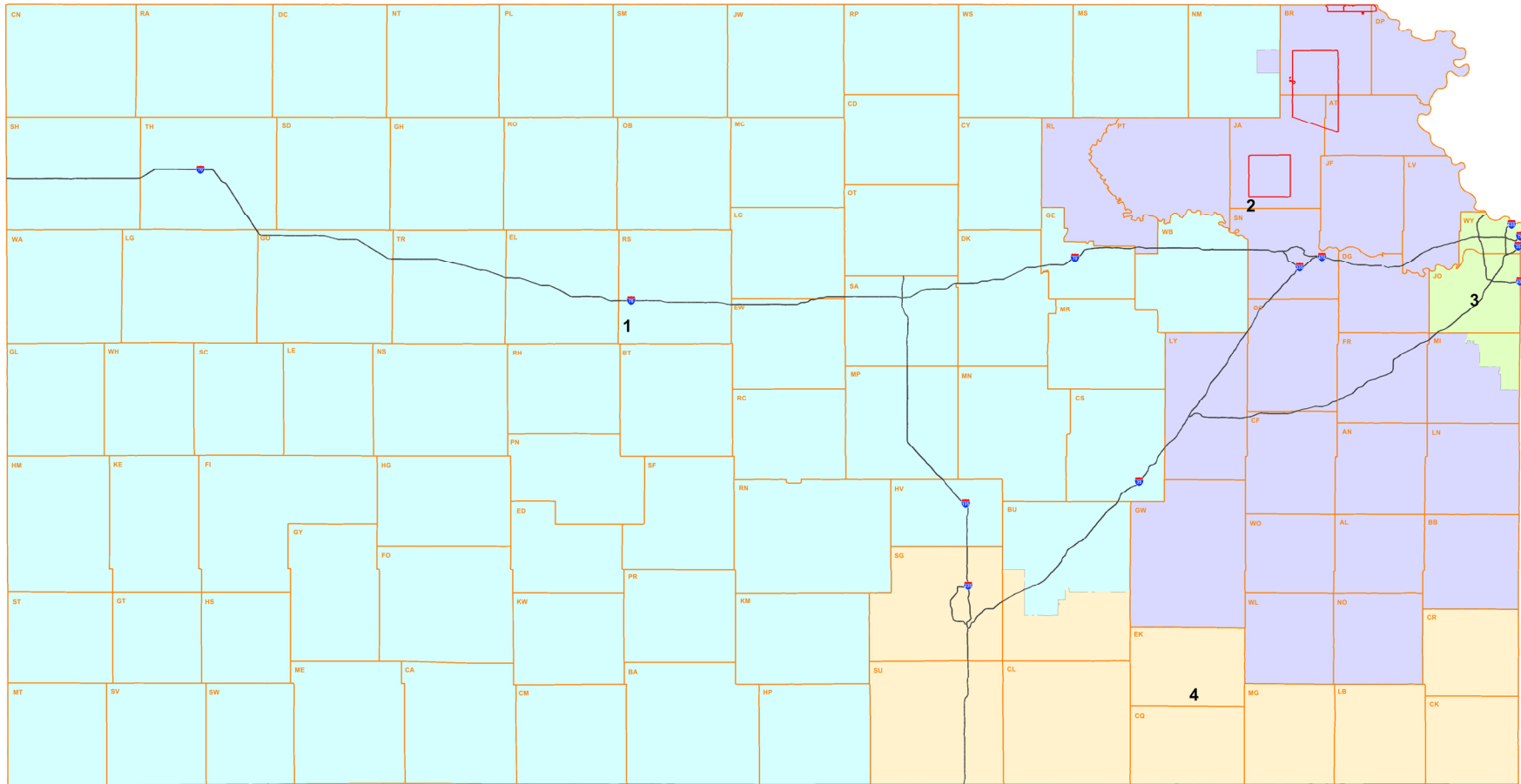

District	Population	Deviation	% Deviation
1	713275	-5	-0%
2	713282	2	0%
3	713282	2	0%
4	713279	-1	-0%

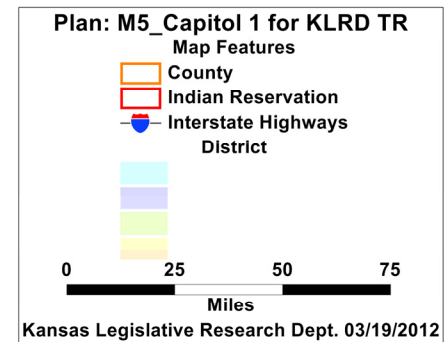

M5_Capitol 1 for KLRD TR

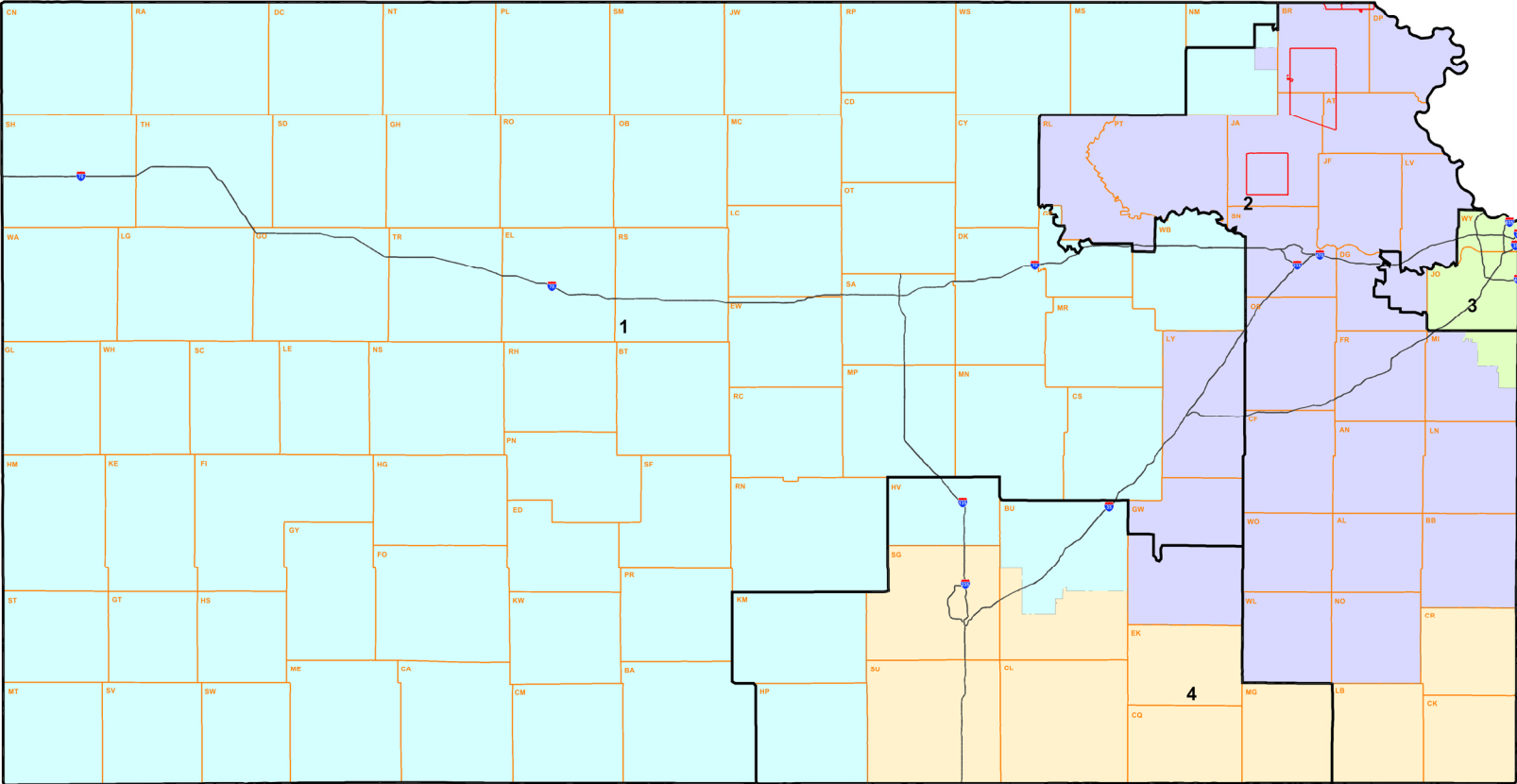

Black Lines Show Boundaries of Existing 2002 Congressional Districts.

Plan: M5_Capitol 1 for KLRD TR
Map Features

- County
- Indian Reservation
- Congressional Dist
- Interstate Highways

District

-
-
-
-

0 25 50 75
 Miles

Kansas Legislative Research Dept. 03/19/2012

M5_Capitol 1 for KLRD TR Detail of Butler County

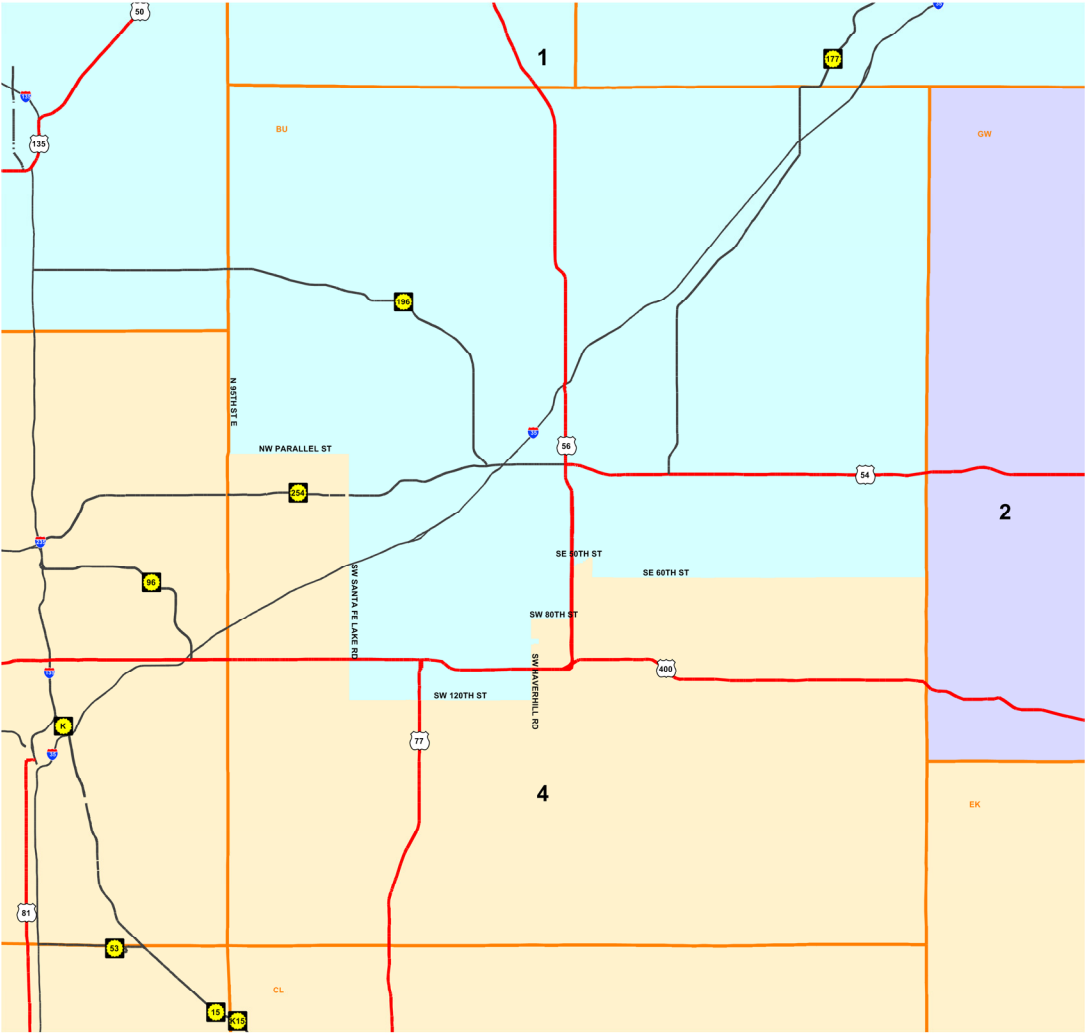
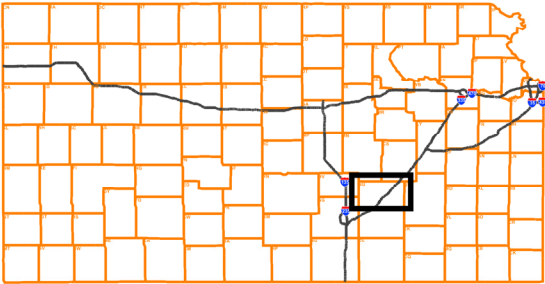

Plan: M5_Capitol 1 for KLRD TR
Map Features

- County
- Indian Reservation
- Interstate Highways
- U.S. Highways
- State Highways

District

- 1
- 2
- 3
- 4

0 5 10 15
Miles

Kansas Legislative Research Dept. 03/19/2012

M5_Capitol 1 for KLRD TR Detail of Miami County

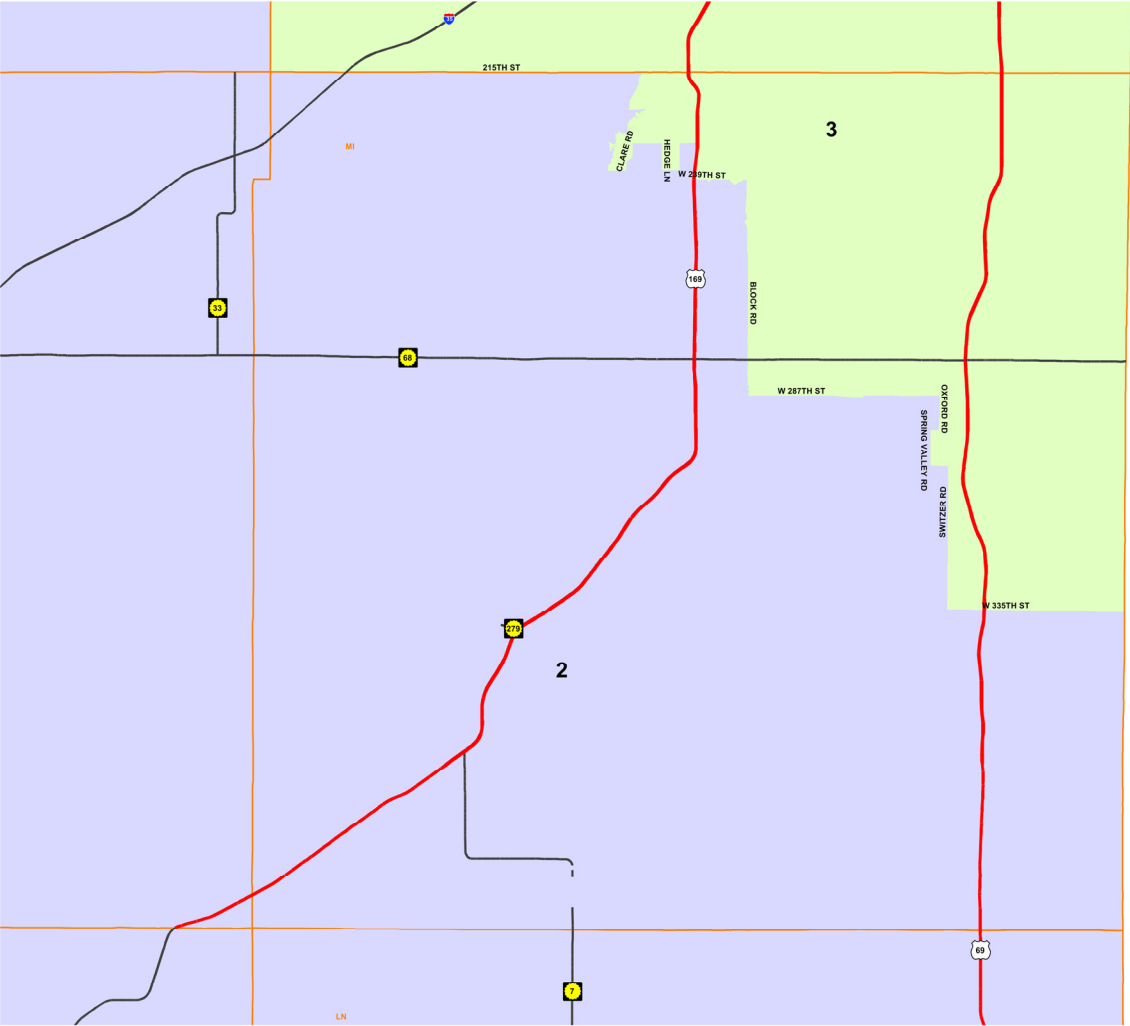
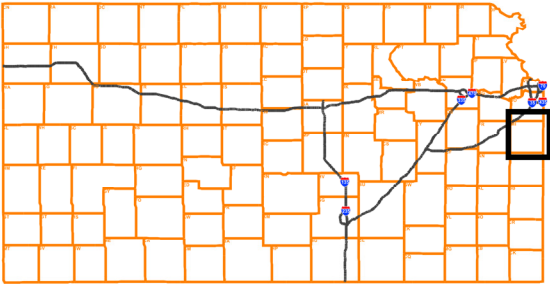

Plan: M5_Capitol 1 for KLRD TR

Map Features

- County
- Indian Reservation
- Interstate Highways
- U.S. Highways
- State Highways

District

- 1
- 2
- 3
- 4

0 3 6 9
Miles

Kansas Legislative Research Dept. 03/19/2012

M5_Capitol 1 for KLRD TR Detail of Nemaha County

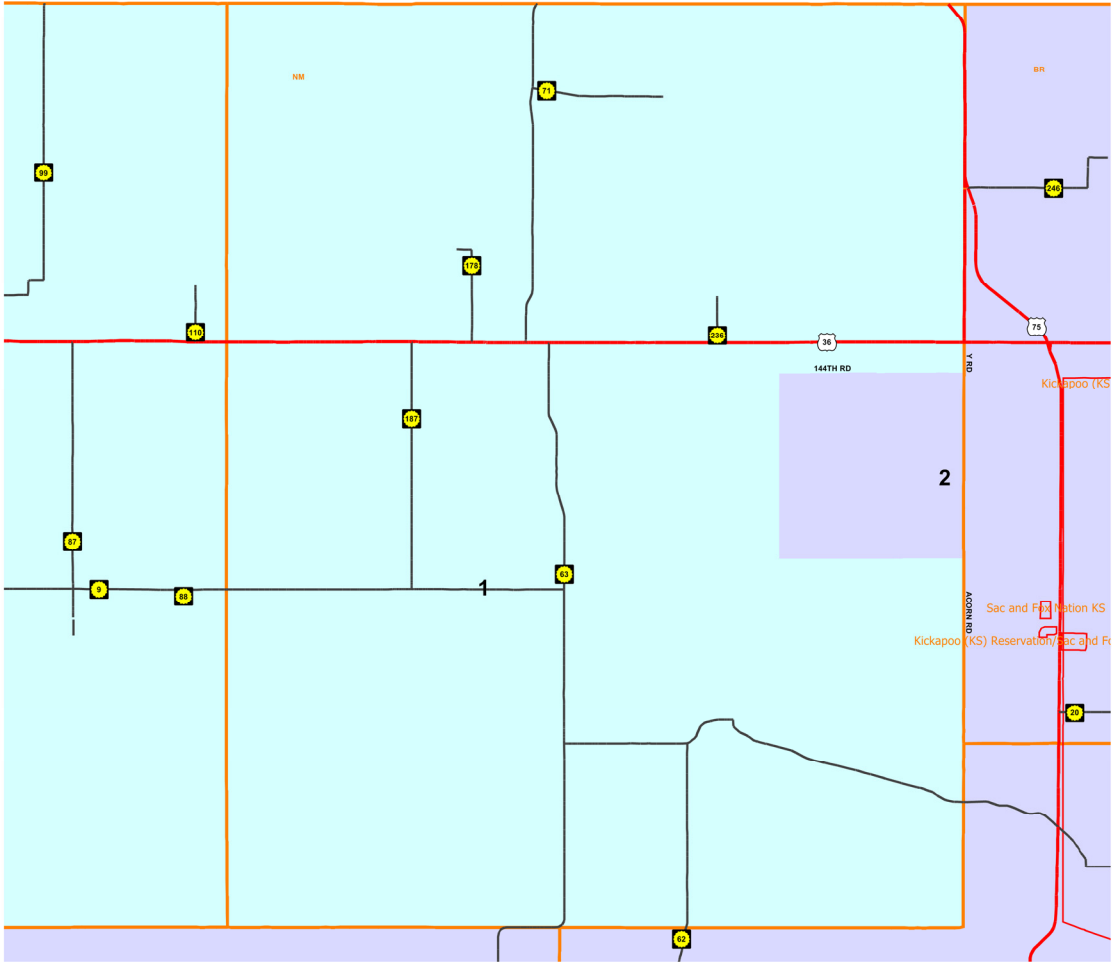
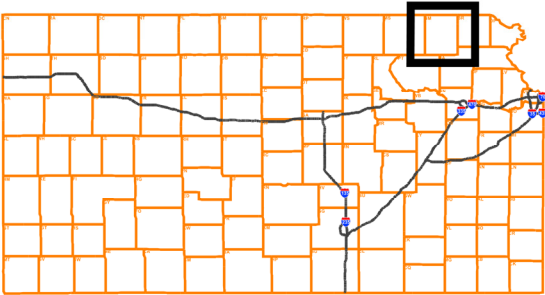

Plan: M5_Capitol 1 for KLRD TR

Map Features

- County
- Indian Reservation
- Interstate Highways
- U.S. Highways
- State Highways

District

- 1
- 2
- 3
- 4

0 3.3 6.7 10
Miles

Kansas Legislative Research Dept. 03/19/2012

Plan: M5_Capitol 1 for KLRD TR
Plan Type: Congressional
Administrator: Rep. Mast
User:

Population Summary Report

Monday March 19, 2012

5:52 PM

DISTRICT	POPULATION	DEVIATION	% DEVN.
1	713,275	-5	0.00
2	713,282	2	0.00
3	713,282	2	0.00
4	713,279	-1	0.00

Total Population: 2,853,118

Ideal District Population: 713,280

Summary Statistics

Population Range: 713,275 to 713,282

Ratio Range: 1.00

Absolute Range: -5 to 2

Absolute Overall Range: 7.00

Relative Range: 0.00% to 0.00%

Relative Overall Range: 0.00%

Absolute Mean Deviation: 2.50

Relative Mean Deviation: 0.00%

Standard Deviation: 3.32