

MINUTES OF THE SENATE WAYS AND MEANS COMMITTEE

The meeting was called to order by Chairman Jay Emler at 10:30 a.m. on January 21, 2009, in Room 545-N of the Capitol.

All members were present except:
Senator Vratil - excused

Committee staff present:

J. G. Scott, Kansas Legislative Research Department
Michael Steiner, Kansas Legislative Research Department
Estelle Montgomery, Kansas Legislative Research Department
Reagan Cussimano, Kansas Legislative Research Department
Cody Gorges, Kansas Legislative Research Department
Aaron Klaassen, Kansas Legislative Research Department
Jim Wilson, Office of the Revisor of Statutes
Daniel Yoza, Office of the Revisor of Statutes
Melinda Gaul, Chief of Staff
Shirley Jepson, Committee Assistant

Conferees appearing before the committee:

Dan Dymarkowski, Director of Labor Relations, Hawker/Beechcraft
Jim Crone, Director of Structural Integrity, Cessna Aircraft
Dr. John Tomblin, Executive Director, National Institute for Aviation Research (NIAR)
Andy Schlapp, Wichita State University (WSU)

Others attending:

See attached list.

Presentation by Wichita Aviation Industry

John Moore, former Lieutenant Governor of the State of Kansas, appeared before the Committee to introduce the presenters from the Wichita aviation industry. Mr. Moore noted the importance of the aviation industry to the state of Kansas and the critical issue of maintaining and providing a viable workforce for the industry.

Jim Crone, Director of Structural Integrity, Cessna Aircraft, presented an overview of the aviation industry as a major contributor to the economic vitality of Kansas (Attachment 1). Highlights from Mr. Crone's presentation include:

- There are 36,500 direct jobs in the aviation industry in Kansas. The National Institute for Aviation Research (NIAR), located at Wichita State University, is ranked 3rd among the nation's universities in the amount of aviation research performed.
- The investment in NIAR by the state has changed the aviation research capability within Kansas.
- Aviation research is a global business.
- Important to maintain a trained workforce.
- NIAR is requesting an appropriation of \$5m from the 2009 Legislature to continue research at NIAR.

Responding to questions from the Committee, Mr. Crone stated that in forecasting the future of the aviation industry, they look at demands for aircraft, study trends in the industry and have predicted that the downturn in the economy will slow in 2010 and gradually work upward after 2010. With regard to a federal stimulus package, Mr. Crone noted that the federal government puts a lot of emphasis on safety and for this reason, it is thought that there may be a stimulus package in the near future.

Dr. John Tomblin, Executive Director, NIAR, stated that the forecast for NIAR and the aviation industry in Wichita is strong at this time. Responding to a question from the Committee, Dr. Tomblin noted that China has no infrastructure to do aviation research.

Andy Schlapp, Wichita State University, indicated that approximately \$1.3 million in taxes are paid to the state by the aviation industry and their employees each year.

CONTINUATION SHEET

MINUTES OF THE Senate Ways And Means Committee at 10:30 a.m. on January 21, 2009, in Room 545-N of the Capitol.

Dan Dymarkowski, Director of Labor Relations, Hawker/Beechcraft, presented an overview of the National Center for Aviation Training (Attachment 2). Highlights of Mr. Dymarkowski's presentation included:

- There is global competition, as well as competition within the United States, from those performing aviation research.
- The industry will be in need of 20,000 workers within the next 10 years, as current employees retire and the need for additional employees increases.
- As the industry changes and new technologies are advanced, it is necessary to have a well-trained workforce.
- The industry is requesting a continued investment of \$5 million from the state for the National Center for Aviation Training in each of the next 4 years to be used for equipment and machinery; programs and curriculum.

Responding to a question from the Committee, Mr. Dymarkowski noted there are approximately 40,000 employees in the aviation industry within the state.

Continued Discussion on SB 23 - Supplemental, appropriations for FY2009 for various state agencies.

Copies of information provided by Dale Dennis, Deputy Commissioner, Department of Education, were distributed to the Committee, in response to the Committee's request for the additional information on school finance showing the difference of an "across the board" reduction and the effect of a reduction in the Base State Aid Per Pupil (BSAPP) on individual school districts (Attachment 3).

Overview of State Surplus Property

Cody Gorges, Legislative Research Department, provided an overview of the State Surplus Property Program (Attachment 4).

Continued Discussion on SB 30 - State surplus property; disposition of computers and firearms.

Jim Wilson, Office of the Revisor of Statutes, provided and explained balloon amendments to **SB 30** as requested by the Committee (Attachment 5).

The Committee expressed a concern with adding local public libraries to the bill and felt it might be appropriate to allow all non-profit entities to have the opportunity to purchase surplus computers. The Committee also proposed striking the "two" in Line 35 and reducing to "one".

Senator Taddiken moved to adopt the first two amendments to SB 30 as presented. The motion was seconded by Senator Lee. Motion carried on a 5-3 vote.

Senator Schmidt moved to change the language in SB 30 on Line 35 to remove "two" and insert "one" and adopt the remaining amendments as presented. The motion was seconded by Senator McGinn. Motion carried.

Senator Kelly moved to further amend SB 30 by adding language regarding the sale of computers, stating if the director of the Department of Administration determines that the equipment cannot be sold to legislators and staff, it would be offered as surplus property as stated in current statute. The motion was seconded by Senator Wysong. Motion carried.

The Committee requested a copy of the bill with the additional amendments before taking final action.

Adjournment

The next meeting is scheduled for January 22, 2009.

The meeting was adjourned at 12.00 p.m.

**SENATE WAYS & MEANS COMMITTEE
GUEST LIST**

DATE: January 21, 2009

NAME	REPRESENTING
Jim Krowe	CESNA & NAIR
Efhe Swanson	KIAPA
Travis Lowe	Pinegar, Smith, & Assoc.
Luis Weeks	SRS
Pat Holloman	Eastern Sen. Kutick
Patil Woods	SRS
Jane Carter	KS Organization of State Employees
Mike Beahm	K12 Inc
Marilyn J. Jacobs	DOA / DFTT
MARK BRUCE	KHP
Shannon Jones	SILCK
Mike Hammond	SKIV
Sheli Sweeney	ACM HCK
Jim May	Spirit AeroSystems
Ron Thompson	" " "
Wendie Ann	" " "
Jenni Rose	KCSI
Steph Snyder	KSOS
Carol Cook	Bombardier / Learjet
John Wicker	Learjet
JP SMALL	LEARJET
DAVID BLEAL	LEARJET

January 21, 2009

Aviation Research

Senate Ways & Means Cmte
Date 1-21-2009
Attachment 1

Agenda

- ◆ *Current Situation*
- ◆ *Aviation Economic Impact in Kansas*
- ◆ *Industry Need for Future Technology Investment*
- ◆ *Summary of Current Program*
- ◆ *Proposal to Sustain and Grow the Industry*

January 21, 2009

Current Situation

1-2



The aviation industry is a major contributor to the economic vitality of Kansas and has the potential for significant growth as a national center for aerospace innovation.



January 21, 2009

Aviation Economic Impact in Kansas

- ◆ 36,500 direct jobs with a payroll of approx. \$2.4 billion
- ◆ Each aviation job generates an additional 2.9 jobs
- ◆ Kansas delivers 54% of all U.S. general aviation aircraft (1,784 aircraft in 2007)

- ◆ **State tax budget:**

- 22% of total state budget
- \$1.3B in state tax revenue

- Even within an economic downturn, we still have a historic upwards trend

Business Jet Forecast

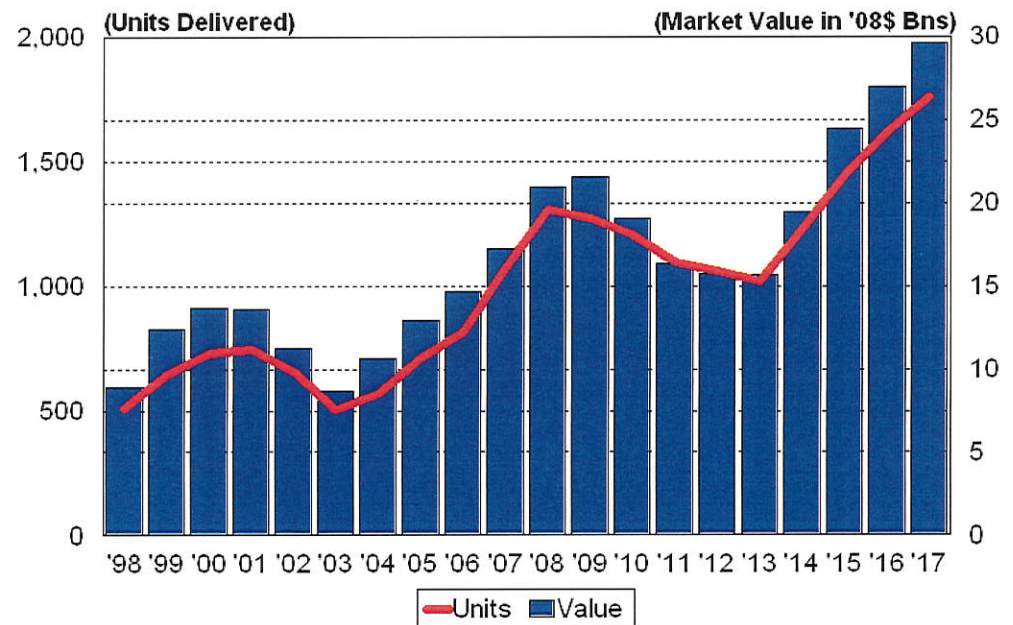

With your help we can maintain this growth in Kansas

7-1

January 21, 2009

Industry Need for Future Technology Investment

- ◆ Airplane design and construction is changing rapidly

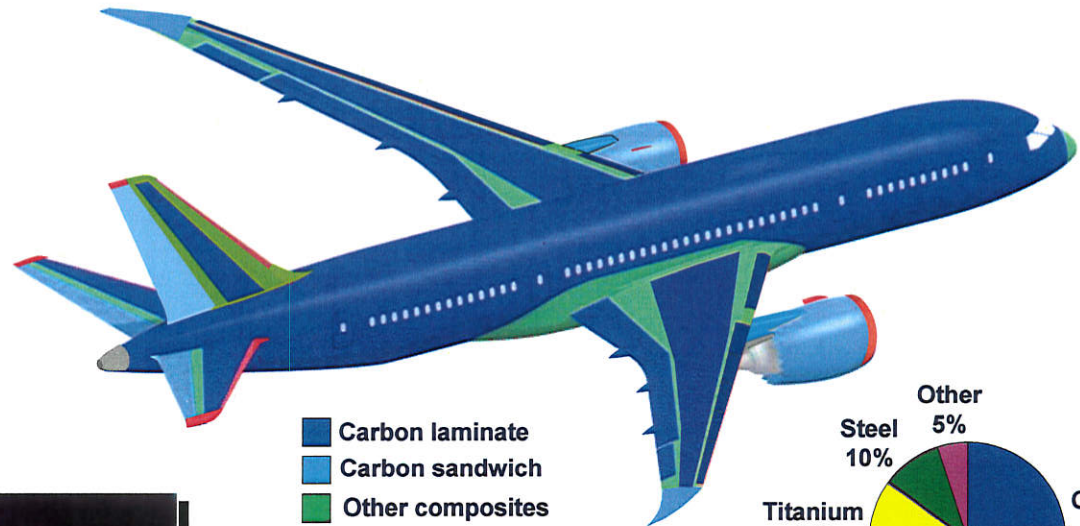

- Carbon laminate
- Carbon sandwich
- Other composites
- Aluminum
- Titanium

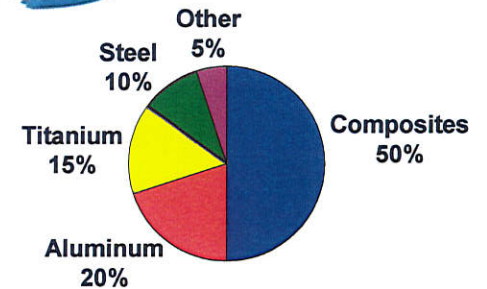

- ◆ To maintain the leadership position and grow this market, Industry and the State of Kansas must invest

January 21, 2009

NIAR Investments and Leverage

9-1

The State's investment has allowed us to obtain significant Federal and Industry funding

Research Investments
2003-2008
\$130.5 Million

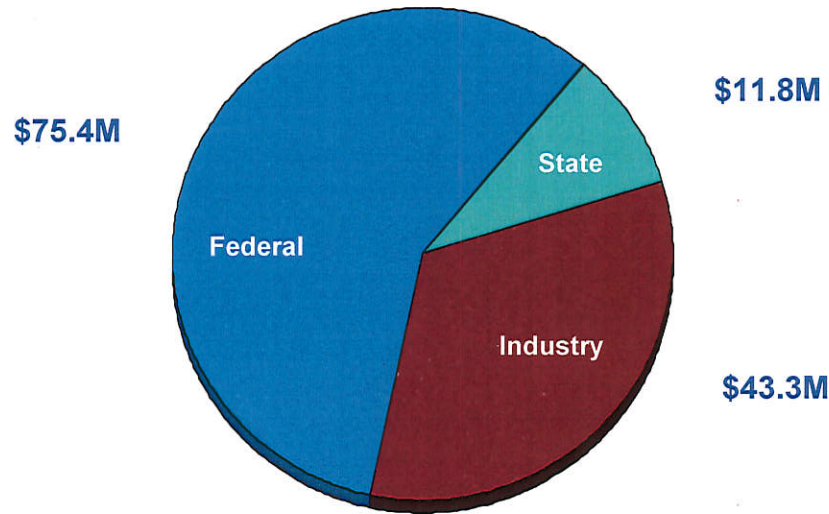

10 : 1

We need to continue to invest in the technology development for our future products

January 21, 2009

NIAR Investments and Leverage

***The National Institute for Aviation Research
ranks high among the nation's prestigious universities.***



1. *The Johns Hopkins University*
2. *Georgia Institute of Technology*
3. ***Wichita State University –
National Institute for
Aviation Research***
4. *Massachusetts Institute of
Technology*
5. *Texas A&M University*
6. *University Maryland – College Park*
7. *University of Colorado*
8. *University of Texas - Austin*
9. *University of Tennessee*
10. *University of Florida*
11. *Mississippi State University*
12. *Princeton University*

January 21, 2009

Federal Leveraging Opportunities

6-1

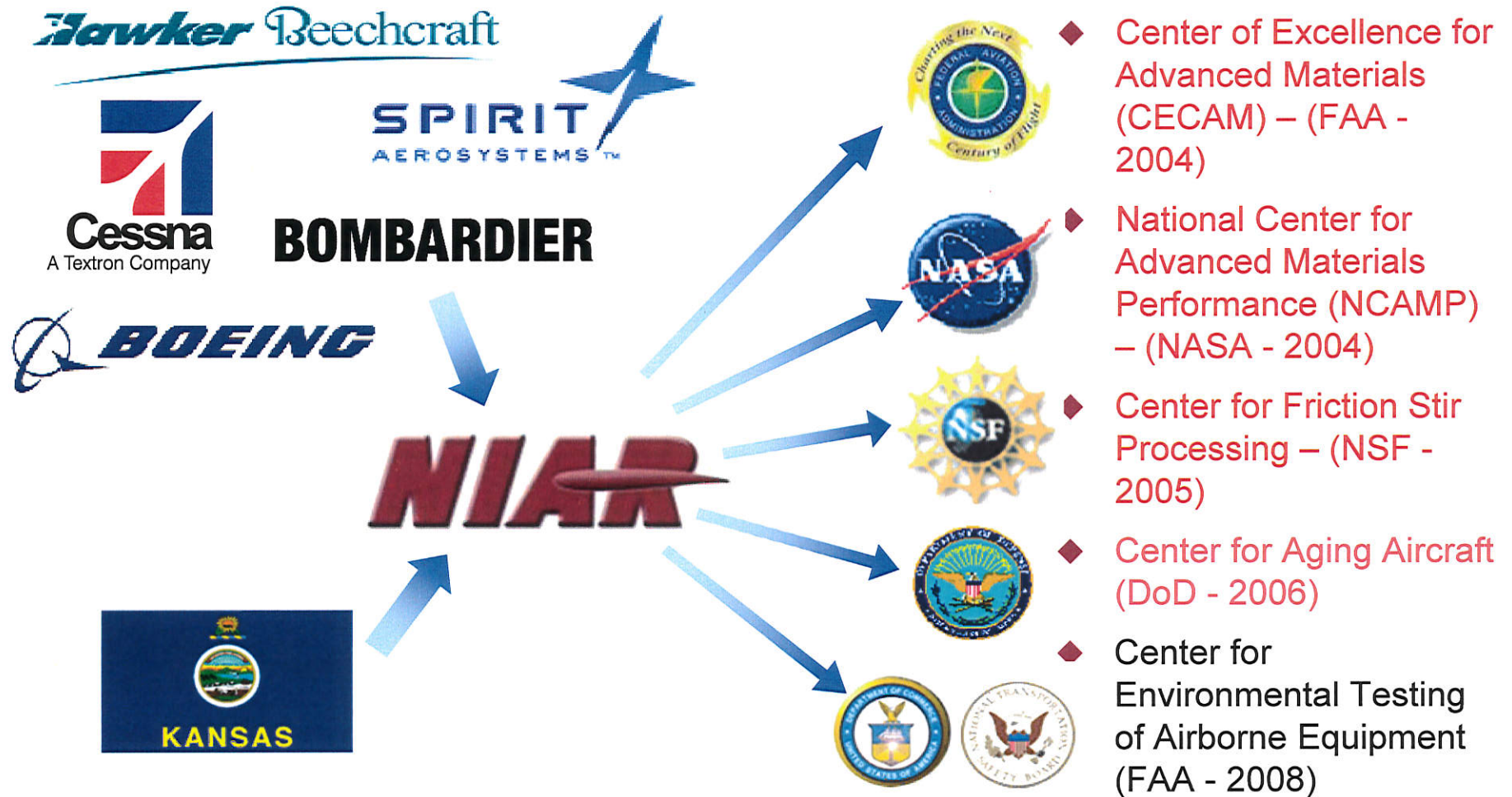

The State provided funding has resulted in a 10:1 return

January 21, 2009

NIAR Investments and Leverage

- ◆ Prior to the State's investment at NIAR (HB2690), industry was beginning to move research outside of the State
- ◆ We have dramatically changed the ability to perform research within the State !!

HB2690 » \$13M infrastructure

New equipment on-line

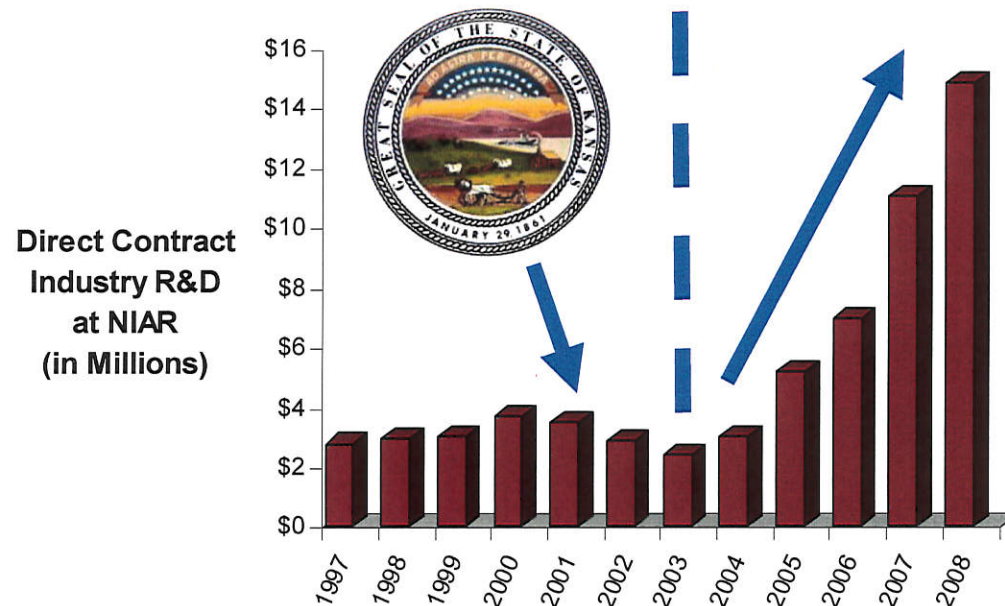

Thanks to your help, we have changed aviation research capability within Kansas

January 21, 2009

Current Program Overview

6-1

- ◆ FY2009 appropriation overview (\$5M)
- ◆ Each company proposed high priority research programs totaling more than the appropriated amount (>\$5M)
- ◆ Programs were downselected or descoped to a multi-year approach to fit within the available budget

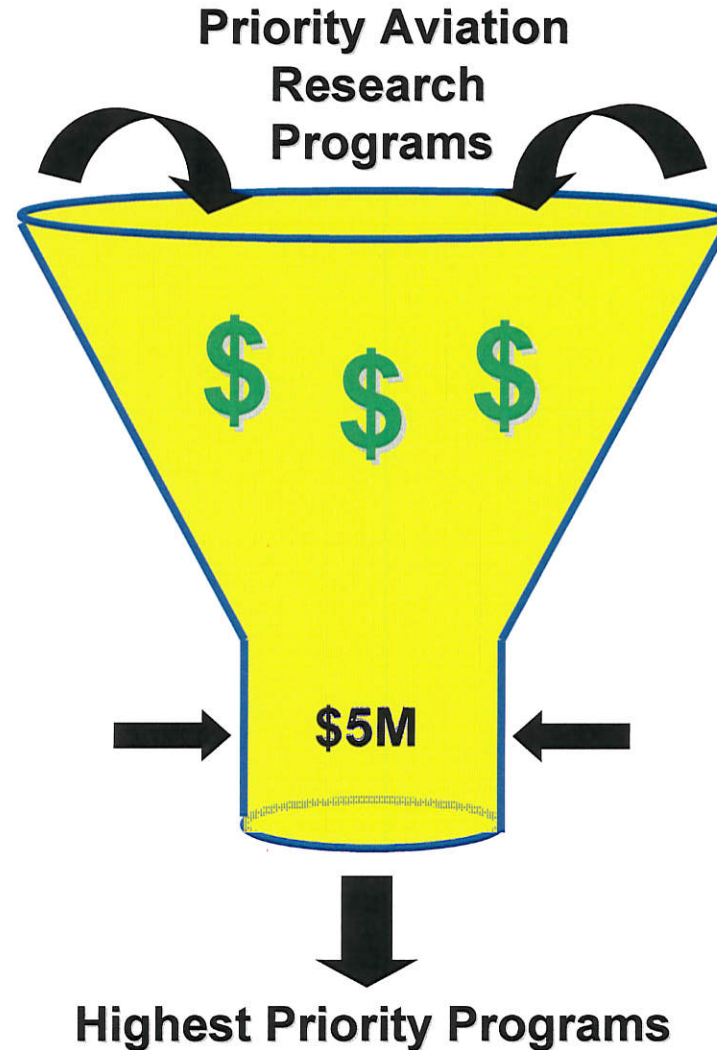

January 21, 2009

Current Program Overview

01-1

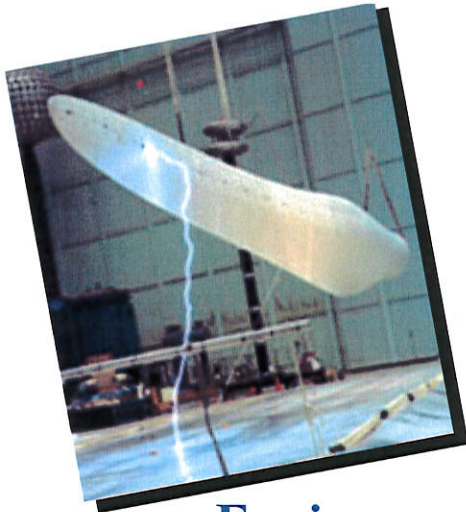

Environmental Effects

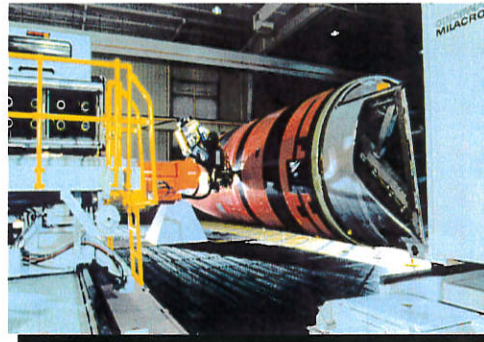

Manufacturing

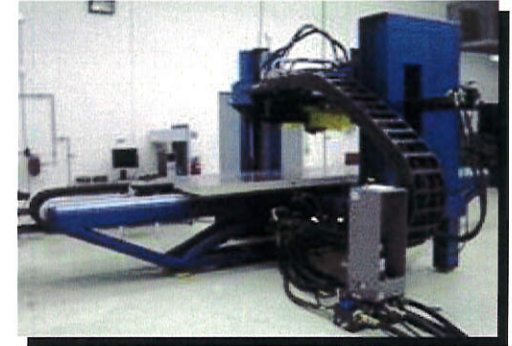

Advanced Joining

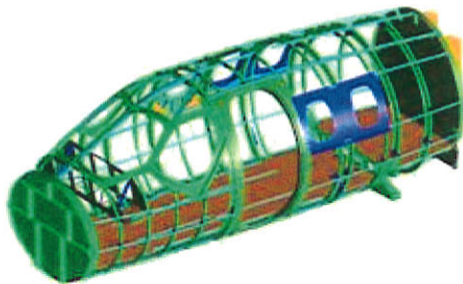

Design



Safety

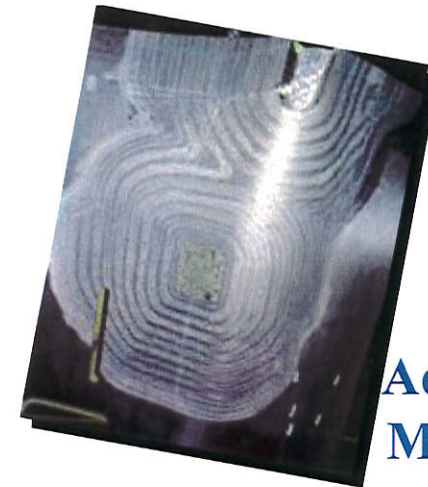

Advanced Materials

Reduced cycle time-to-market, reduced cost, enhanced quality and safety for improved competitiveness

January 21, 2009

Proposal

11-1



We request your support for appropriation and approval of the \$5M request for aviation related research in the 2009 Legislative Session



January 21, 2009

Future Products - Future Research

1-12

- ◆ *The Kansas aviation industry needs to be prepared to meet the demand for future products and technology innovations*

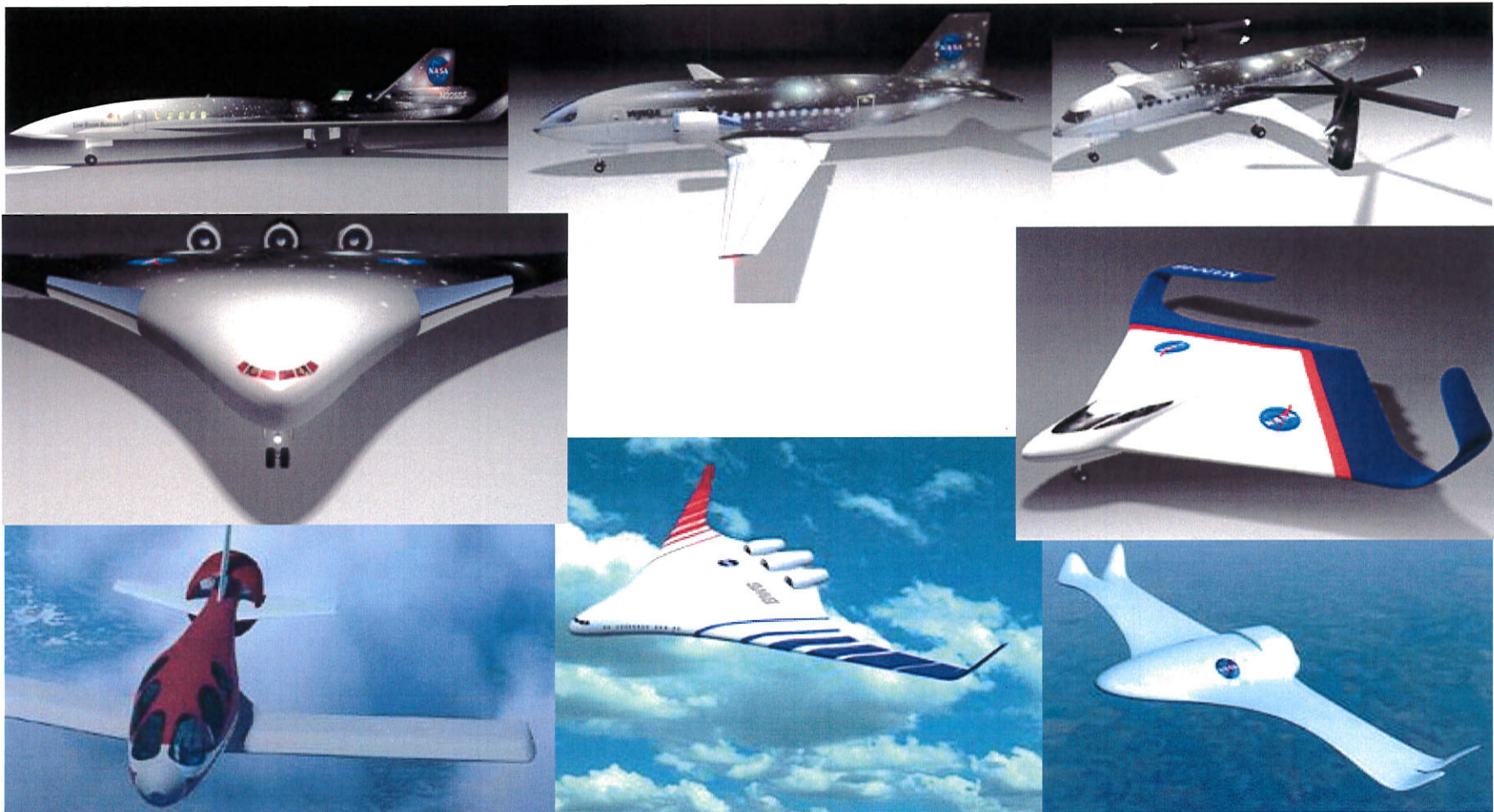

January 21, 2009

Kansas Aviation Industry Representatives

1-13



*Ed Petkus
Hawker Beechcraft Corporation*



*Thomas Konieczny
The Boeing Company*



*John Pilla
Spirit AeroSystems*

Thank you for your support.



*David Brant
Cessna Aircraft Company*



*Ivan Vlatko
Bombardier Aerospace Corporation*

National Center for Aviation Training

Senate Ways & Means Committee

Wednesday, January 21, 2009

Dan Dymarkowski

Director, Labor Relations

Hawker Beechcraft Company

Soaring toward *tomorrow!*

2-2

National Center for Aviation Training



National Center for Aviation Training. ***Kansas Air way to the World!***

National Center for Aviation Training

2-3

Aviation Industry and Investment

Global Competition

- Five global aviation clusters
 - Dallas-Fort Worth, Montreal, Puget Sound, Toulouse, **South central Kansas**
- Hamburg National Centre for Aviation Training
 - Funding of 40 million Euros (\$54m US) over the next five years from the Federal Ministry for Education and Research
- Other Strong Competitors
 - Canada, Brazil, Mexico, European Union, Russia, Japan and China

National Center for Aviation Training

2-4

U.S. Competition for our Aviation Cluster

- Ohio – Netjets & Flight Safety
 - 800 jobs/\$200M investment - \$98M State & Local Government
- Oklahoma Opportunity Fund
 - \$45 Million cash and no/low cost customized training
 - \$5,000 tax credit for each engineer hired by companies
- North Carolina - \$600 Million grant fund
 - Wish to develop aviation cluster
 - Greensboro – building an aviation cluster
 - Honda jet had a full page employment ad in Wichita Eagle
- Florida – Embraer – Melbourne, FL
 - 200 jobs/\$50M investment - \$12M+ State & Local Government
 - Aviation Industry Tax Exemptions

They want our high-paying jobs and tax revenue!

National Center for Aviation Training

2-5

Kansas Aviation Industry

The State View

- Kansas is the Aviation Cluster for research and manufacturing, but we can lose it!
 - Examples: Long Beach, CA, New York, and Germany – Lost their aviation clusters!
 - Auto industry is moving South – Michigan & Ohio are losing their clusters

“It is difficult to build an aviation cluster, but easy to destroy one!” Richard Aboulafia, Teal Group

National Center for Aviation Training

2-6

Aviation in Kansas: The Impact

- Each aviation job generates 2.9 additional jobs
 - Total of **142,350** direct and indirect jobs
 - 100+ FAA Part 145 Repair Stations
 - Concentrated Aviation Supplier Network

- Kansas aviation wages of \$2.4 billion a year

- **\$1.3** billion of the State's \$5.9 billion budget related to the aviation industry

Source: WSU Center for Economic Development & Business Research

National Center for Aviation Training

2-7

Aviation Jobs for Kansans!

Average Wages

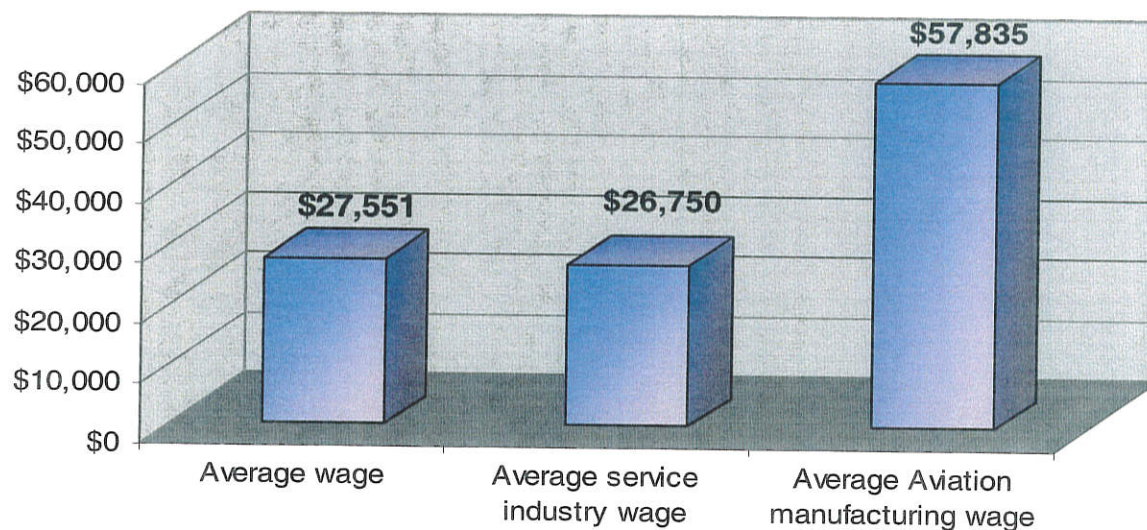

Source: WSU Center for Economic Development & Business Research

National Center for Aviation Training. *Kansas Air way to the World!*

National Center for Aviation Training

2-8

Long-Term Aviation Workforce Demands

- Credit collapse affecting:
 - General aviation industry
 - Finance, oil & gas, agriculture, and retail sales
- Downturn will impact short-term hiring requirements
- Projected need:
 - Remains 10,000 workers over the next 10 years
 - An additional 12,000 needed for retiree replacement
- New technology requires:
 - Retooling & retraining investment in existing workforce

20,000 skilled workers still needed over the next 10 years

Source: WSU Center for Economic Development & Business Research

National Center for Aviation Training. *Kansas Air way to the World!*

National Center for Aviation Training

2-9

What your support has yielded!

- New Programs:
 - Will have developed, expanded, and launched 26 new programs by Spring of 2010
- Have purchased:
 - Initial aviation equipment
 - Require over \$50 million in equipment to outfit new center
- Are continuing to build:
 - Flexible, Business-Driven, High-Tech Training System
- Aviation companies have invested in Kansas

Success = Continued Steady Investment

Results: Kansas Return on Investment

2-10

Spirit AeroSystems Chooses Wichita To Expand Operations

- \$260 million investment

Cessna Aircraft Company to Locate Citation Columbus Plant in Kansas

- \$780 million investment

Bombardier to enlarge Wichita Plant

- Announces new aircraft
- Expansion plans are being finalized



Suppliers

- **Flight Safety**
- **Many Others**



National Center for Aviation Training

2-11

Aviation Programs – New & Expanding

Enrollment	2007	2008 ¹ July-Dec	2009 ²
➤ FAA Aviation Maintenance Technician	127	205	475
➤ Avionics Technician	0	21	50
➤ Composites Technician	128	46	250
➤ Aerostructures Technician	182	77	225
➤ Mechanical Design Technician	0	11	30
➤ Aviation Cabinetmaker Technician	19	25	60
➤ Machine Technology	10	33	85
➤ Metal Joining Technology	25	37	100

Wichita State University - New Transfer Degrees

- Aerospace Engineering Management Technology
- Mechatronics Engineering Technology

¹ July through December 2008

² Projections

National Center for Aviation Training

2-12

New Programs Offered Beginning in Fall of 2009

- Advanced Engineering
 - Manufacturing Engineering Design
 - CATIA - Design
 - Machining
 - Manufacturing Engineering Technician
 - Manufacturing Robotics Engineering
 - Industrial Engineering Technician
 - Quality Engineering Technician
 - Aeronautical Engineering Technician
- Mechanical Systems Technology
- Programmable Logic Controls Technician
- Nondestructive Testing
- Lean Manufacturing Process Technician
- Industrial Systems Technology
- Aerospace Quality Control
- Advanced Coating Technician
- Composite Technician - Inspection Repair
- Aerospace Fiber Optics
- Project Management Certification

Increased Capability

2-13

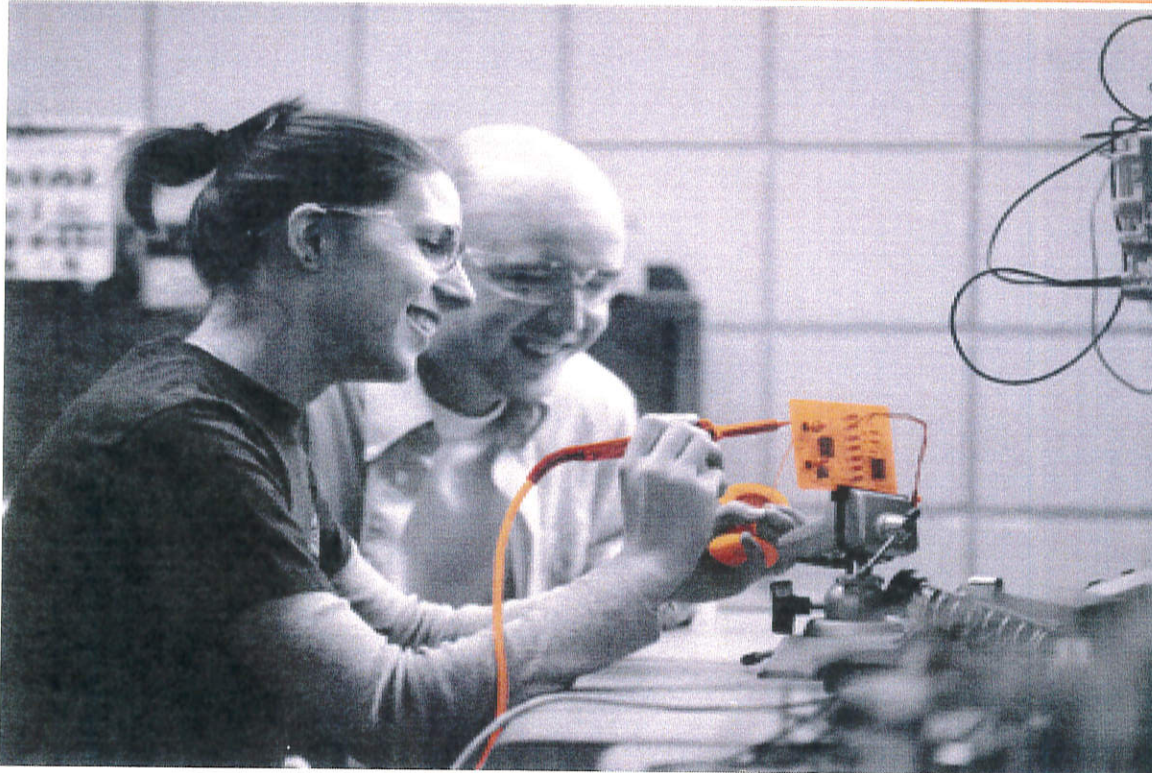

Educational Programming for Business

- Company Customized & Proprietary Training Provided
 - 50+ Aviation & Manufacturing Companies being served
 - Custom Designed Hybrid Training (Online, Classroom & Laboratory)

Business Support

2-14

Over \$3M Equipment & Scholarships Business Investment

Sample of Donors include:

- Rockwell Collins
- Boeing IDS
- Bombardier Learjet
- Cessna Aircraft Co.
- Spirit AeroSystems Co.
- Garmin International
- Hawker-Beechcraft Co.



National Center for Aviation Training

2-15

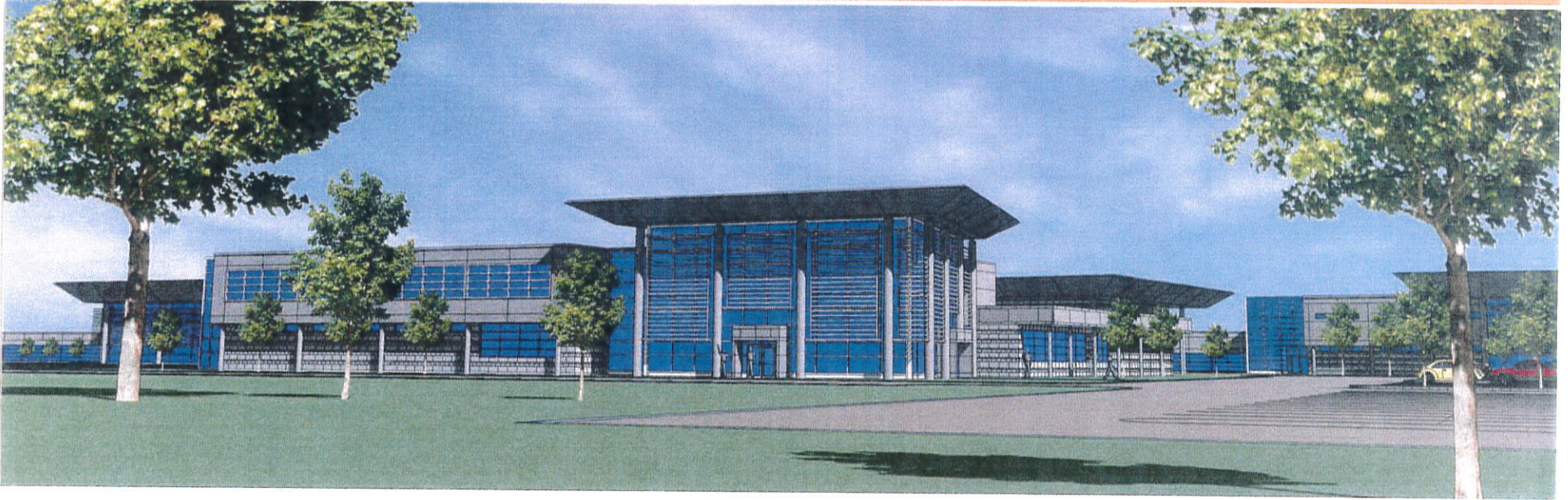

- County, City, State, Aviation Manufacturers, and Federal Partnership
 - \$50m+ in facility invested
 - Require \$50m+ Infrastructure support (equipment & curriculum)

- Manufacturing Tech Center & Aviation Service Center
 - Opening Fall of 2010

The Layout Expandable – Easy Access

2-16

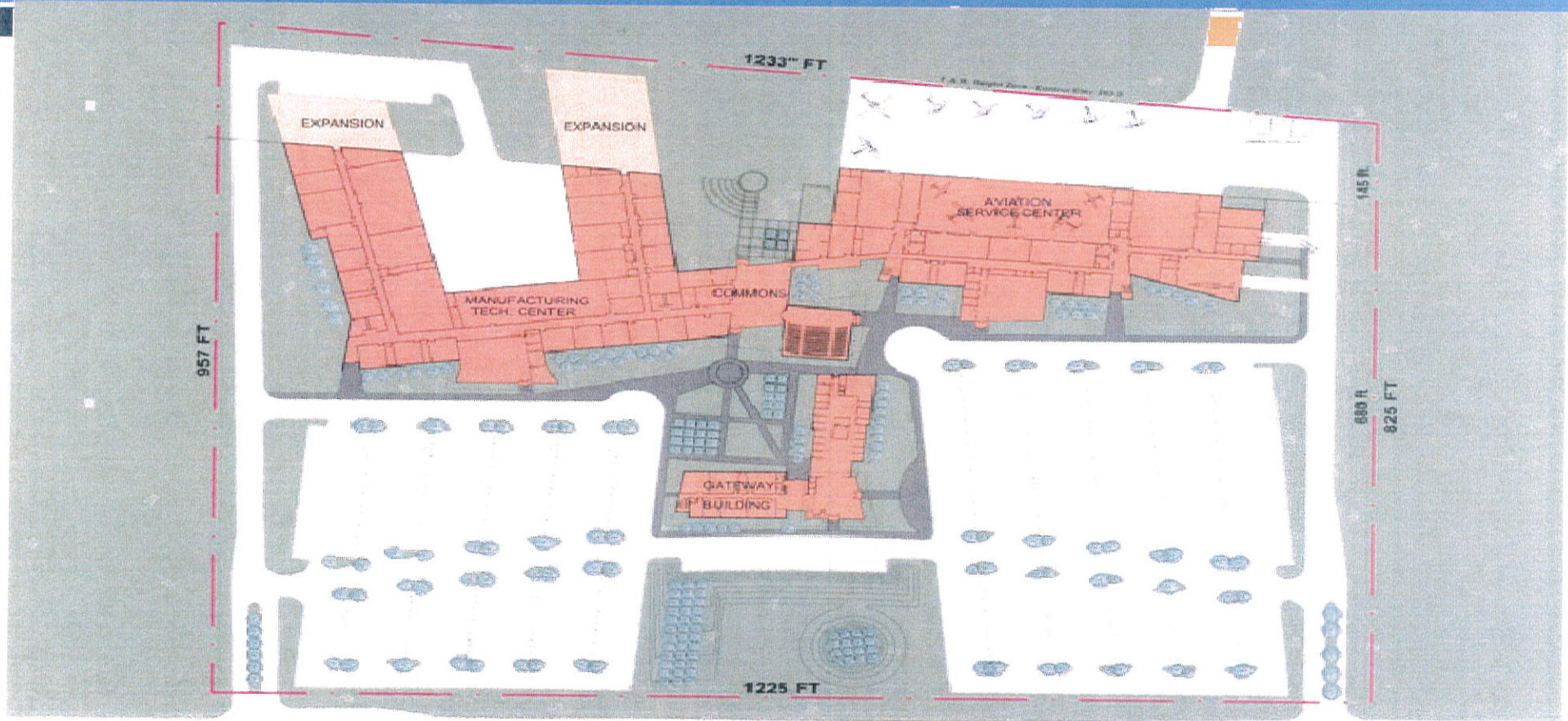

CENTER FOR AVIATION TRAINING
Jabara Campus



National Center for Aviation Training. *Kansas Air way to the World!*

National Center – What is it?

2-17

- **224,000 square feet – 25 acres includes:**
 - Aviation Service Academy
 - Advanced Manufacturing Institute
 - Career Development/Pre & Post Assessment
- **Capacity**
 - 1,500 day and evening full-time students
- **Enjoys strong FAA involvement and support**
- **Curriculum developed by:**
 - Technical College
 - NIAR
 - Aviation Company Subject Matter Experts
- **Provides flexible space for our Customer training needs**

NIAR/WSU Partnership

2-18

National Institute for Aviation Research

- First national partnership of research and technical education
- Translate research to education & training
- Great opportunity for students to see their future

Wichita State University

- Seamless path of transfer
- University students access to high tech labs
- Technical students access to university faculty

National Center for Aviation Training

6-1-09

Aviation's Future in Kansas

- Difficult Year (2008)
 - Two major labor disruptions
 - Credit market collapse (3rd quarter)
 - Still had most business aircraft deliveries in history
 - 2009 will be challenging as we adjust to market conditions
- Projected rebound early to mid 2010 – Aviation will back stronger!
 - Remember shortly after 9/11 we had a worker shortage
- To **protect and defend** our aviation future we must:
 - Be the leader in Research – NIAR
 - Kansas remain the **leader** in Aviation Manufacturing
 - Be the leader in Technical Training

“States and Cities with aviation clusters must understand that it is a defensive business” Richard Aboulafia, Teal Group

National Center for Aviation Training

2-20

- To Assist the Kansas Aviation Industry
 - Employs 36,500, tax revenues of \$1.3 Billion, State's leading economic sector
- Relationship between NIAR & Tech Training
 - We are pooling our intellectual & capital resources

Requesting continued investment of \$5 million for aviation training in each of the next four years

- Equipment and machinery
- Programs and curriculum

Soaring toward *tomorrow!*

12-21

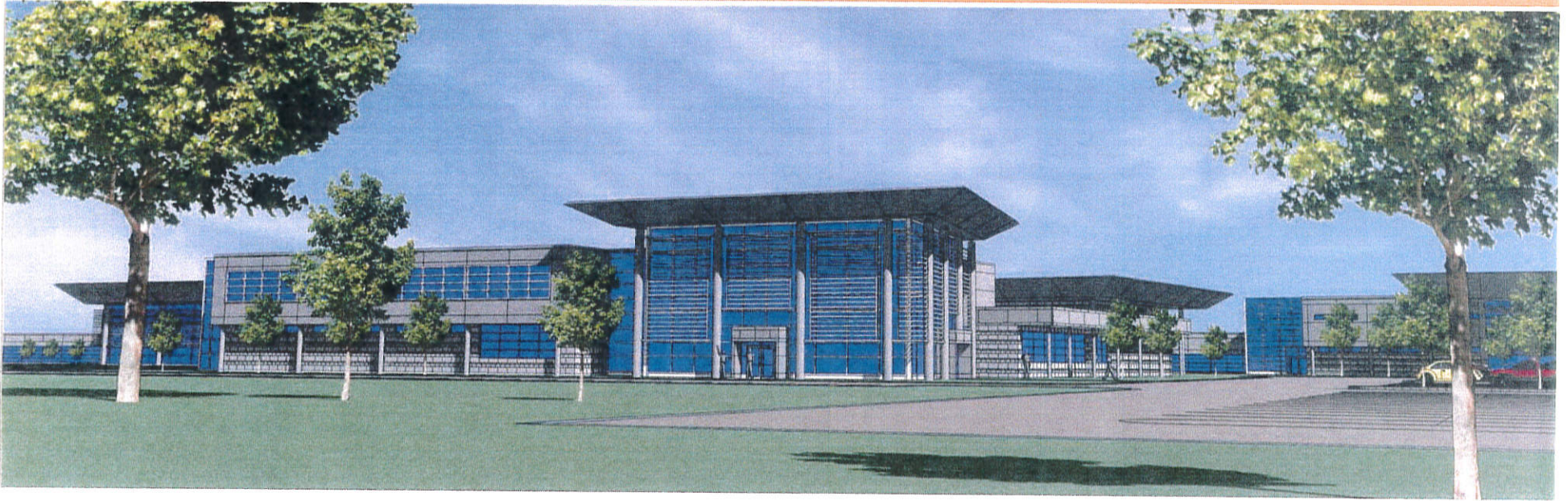

THANK YOU!

For your support & efforts last session
and for your continued commitment and
work for Kansas future!

National Center for Aviation Training. *Kansas Air way to the World!*



January 19, 2009

TO: Senator Janis Lee

FROM: Dale M. Dennis, Deputy
Commissioner of Education

SUBJECT: School Finance Reductions

As requested, attached is a computer printout (SF9013) which provides a comparison between the Governor's recommended reductions and across the board reductions which should total approximately \$45.2 million.

This information has been broken down by individual funds and provides the appropriate comparisons. There are several smaller programs that total approximately \$15 million that could not be determined which include the following: juvenile detention facilities, declining enrollment, mentor teacher, professional development, school food service, educable deaf/blind, agriculture in the classroom, and National Board Certification. These programs would add an additional \$200,000 to those on the computer printout.

Columns 13 and 14 provides the effects of reducing the base state aid per pupil by \$71 which will achieve the same reduction in state aid but it effects school districts differently.

Please review the column explanation carefully.

Senate Ways & Means Cmte
Date 1-21-2009
Attachment 3

COLUMN EXPLANATION

Column 1 -- 2008-09 Estimated FTE enrollment

GOVERNOR'S RECOMMENDATIONS

- 2 -- 2008-09 Estimated effects of a \$22 reduction in base state aid per pupil
- 3 -- 2008-09 Estimated decrease in special education state aid entitlement
(Based upon the 2007-08 special education state aid reimbursement)
- 4 -- 2008-09 Total (Column 2 + 3)
(Governor's recommended reductions for 2008-09)

ACROSS THE BOARD CUTS TO ACHIEVE REDUCTIONS OF \$45.2 MILLION

- 5 -- 2008-09 Estimated effects of a \$47 reduction in BSAPP
- 6 -- 2008-09 Estimated reductions in local option budget state aid
- 7 -- 2008-09 Estimated reductions in special education state aid
- 8 -- 2008-09 Estimated reductions in KPERS
- 9 -- 2008-09 Estimated reductions in bond and interest state aid
- 10 -- 2008-09 Estimated reductions in capital outlay state aid
- 11 -- 2008-09 Total reductions excluding small programs described in memo
(Column 5 + 6 + 7 + 8 + 9 + 10)
- 12 -- Difference (Column 11 - 4)

REDUCTION OF \$71 IN BSAPP

- 13 -- 2008-09 Estimated effects of a \$71 reduction in BSAPP
- 14 -- Difference (Column 11 - 13)

	1/19/2008		Col 1	Col 2	Col 3	Col 4	Col 5	Col 6	Col 7	Col 8	Col 9	Col 10	Col 11	Col 12	Col 13	Col 14			
GOVERNOR'S PROPOSED STATE AID REDUCTIONS							ACROSS THE BOARD - PROPOSED STATE AID REDUCTIONS (APPROX \$45M)												
No.	County Name	USD Name	2008-09	2008-09 Est.	2008-09 Est.	2008-09 Est.	2008-09 Est.	2008-09 Est.	2008-09 Est.	2008-09 Est.	2008-09 Est.	2008-09 Est.	2008-09 Est.	Difference	2008-09 Est.	Difference			
			FTE Enrollment (includes MILT)	GSA Reduction (SF9001 Col 7)	Sped Reduction	Total Reduction (Col 2 + Col 3)	GSA Reduction @ \$47.30	LOB Aid Reduction	Sped Reduction	KPERS Reduction	Bond & Int. Aid Reduction	Capital Outlay Aid Reduction	Total Reductions (Cols 5 thru Col 10)	(Col 11 - Col 4)	GSA Reduction @ \$71	(Col 11 - Col 13)			
256	Allen	Marmaton Valley	320.5	-13,315	-4,954	-18,269	-28,777	-2,629	-6,538	-2,194	-933	0	-41,071	-22,803	-43,196	2,125			
257	Allen	Iola	1,396.0	-44,778	-18,872	-63,650	-96,241	-29,411	-24,906	-9,312	0	-1,168	-161,039	-97,389	-144,464	-16,575			
258	Allen	Humboldt	495.0	-18,139	-6,486	-24,625	-38,956	-4,958	-8,559	-3,930	-2,949	-211	-59,564	-34,939	-58,476	-1,088			
365	Anderson	Garnett	1,107.2	-36,388	-11,221	-47,609	-78,475	-11,914	-14,809	-7,133	-532	-1,369	-114,233	-66,624	-117,796	3,563			
479	Anderson	Crest	221.0	-10,196	-3,727	-13,923	-21,961	-1,308	-4,918	-2,017	0	0	-30,204	-16,282	-32,965	2,761			
377	Atchison	Atchison County	683.6	-24,786	-9,100	-33,886	-53,624	-9,551	-12,010	-4,189	0	0	-79,375	-45,489	-80,493	1,118			
409	Atchison	Atchison	1,581.5	-47,041	-19,292	-66,333	-101,293	-21,554	-25,461	-13,334	-8,075	-1,436	-171,153	-104,820	-152,047	-19,107			
254	Barber	Barber Co.	502.0	-18,788	-6,373	-25,161	-40,238	0	-8,411	-3,648	0	0	-52,296	-27,135	-60,400	8,103			
255	Barber	South Barber Co.	221.0	-9,857	-2,636	-12,493	-20,769	0	-3,479	-1,962	0	0	-26,211	-13,717	-31,176	4,965			
354	Barton	Claffin	222.1	-9,651	-3,250	-12,901	-21,053	-878	-4,289	-1,913	0	-23	-28,155	-15,254	-31,602	3,447			
355	Barton	Ellinwood	418.0	-15,574	-4,938	-20,511	-33,843	-3,570	-6,516	-3,151	-1,079	0	-48,160	-27,649	-50,801	2,641			
428	Barton	Great Bend	2,987.0	-91,598	-21,982	-113,579	-197,369	-45,655	-29,010	-25,267	-9,676	0	-306,976	-193,397	-296,262	-10,715			
431	Barton	Hoisington	607.5	-21,032	-6,246	-27,278	-45,592	-7,821	-8,243	-3,907	-3,046	0	-68,609	-41,331	-68,437	-172			
234	Bourbon	Ft. Scott	1,947.5	-58,772	-12,938	-71,710	-125,298	-19,183	-17,075	-13,518	-5,912	-1,094	-182,079	-110,369	-188,079	6,000			
235	Bourbon	Uniontown	434.0	-18,219	-3,879	-22,098	-39,169	-6,570	-5,119	-3,660	-1,060	0	-55,579	-33,480	-58,795	3,217			
415	Brown	Hiawatha	843.8	-29,918	-12,351	-42,269	-64,626	-10,205	-16,300	-6,243	-1,791	-601	-99,766	-57,497	-97,007	-2,759			
430	Brown	Brown County	635.5	-25,451	-10,020	-35,471	-54,527	-16,447	-13,224	-4,856	-2,780	0	-91,834	-56,364	-81,849	-9,986			
205	Butler	Bluestem	599.0	-23,003	-6,769	-29,772	-49,419	-10,232	-8,934	-4,499	-3,147	-959	-77,190	-47,418	-74,181	-3,009			
206	Butler	Remington-Whitewater	511.4	-19,327	-5,793	-25,119	-41,657	-5,389	-7,645	-4,075	-1,097	0	-59,863	-34,743	-62,530	2,667			
375	Butler	Circle	1,595.0	-43,083	-12,263	-55,346	-92,528	0	-16,184	-9,132	0	0	-117,844	-62,499	-138,890	21,046			
385	Butler	Andover	4,545.9	-120,409	-29,246	-149,655	-258,679	-47,957	-38,597	-25,891	-29,020	-6,675	-406,818	-257,164	-388,292	-18,526			
394	Butler	Rose Hill	1,663.4	-45,865	-13,532	-59,397	-99,032	-29,164	-17,859	-9,315	-13,395	-2,150	-170,914	-111,517	-148,653	-22,262			
396	Butler	Douglass	778.1	-26,069	-7,582	-33,652	-56,263	-15,984	-10,007	-5,426	-4,534	-334	-92,549	-58,898	-84,455	-8,095			
402	Butler	Augusta	2,146.1	-57,264	-16,557	-73,822	-123,075	-33,524	-21,851	-11,572	-18,832	-2,862	-211,716	-137,894	-184,742	-26,974			
490	Butler	El Dorado	1,996.2	-60,646	-17,529	-78,175	-129,980	-11,457	-23,133	-25,469	-1,090	-3,191	-194,320	-116,146	-195,108	788			
492	Butler	Flinthills	294.8	-11,961	-3,370	-15,331	-25,499	-4,462	-4,447	-2,089	-1,263	0	-37,760	-22,429	-38,276	516			
284	Chase	Chase County	417.5	-16,903	-4,406	-21,309	-36,080	0	-5,815	-3,488	0	0	-45,384	-24,074	-54,159	8,775			
285	Chautauqua	Cedar Vale	139.5	-6,549	-1,470	-8,018	-14,398	-1,012	-1,940	-1,086	0	0	-18,436	-10,418	-21,612	3,176			
286	Chautauqua	Chautauqua	365.0	-14,591	-4,481	-19,071	-31,478	-2,796	-5,914	-2,828	0	-353	-43,369	-24,298	-47,251	3,881			
404	Cherokee	Riverton	828.5	-29,122	-7,378	-36,500	-62,360	-16,461	-9,737	-5,768	-1,182	-386	-95,893	-59,393	-93,606	-2,286			
493	Cherokee	Columbus	1,152.6	-38,872	-10,412	-49,284	-83,451	-17,142	-13,741	-8,965	0	-907	-124,208	-74,924	-125,265	1,058			
499	Cherokee	Galena	730.5	-26,824	-5,903	-32,727	-57,909	-18,656	-7,791	-5,973	-2,299	-471	-93,099	-60,372	-86,925	-6,174			
508	Cherokee	Baxter Springs	926.5	-31,695	-7,298	-38,993	-68,547	-18,985	-9,632	-6,454	0	0	-103,618	-64,625	-102,893	-725			
103	Cheyenne	Cheylin	130.0	-7,024	-1,445	-8,469	-15,462	0	-1,908	-1,235	0	0	-18,605	-10,136	-23,210	4,605			
297	Cheyenne	St. Francis	297.5	-11,364	-2,036	-13,400	-24,558	0	-2,687	-2,256	0	0	-29,501	-16,101	-36,863	7,362			
219	Clark	Minneola	271.0	-10,571	-2,903	-13,473	-22,274	-1,850	-3,831	-1,932	-393	-108	-30,387	-16,914	-33,434	3,047			
220	Clark	Ashland	216.0	-9,456	-2,474	-11,929	-20,069	0	-3,265	-1,833	0	0	-25,167	-13,238	-30,125	4,958			
379	Clay	Clay Center	1,344.7	-39,672	-12,590	-52,263	-85,712	-17,196	-16,616	-11,309	-2,647	0	-133,482	-81,219	-128,659	-4,822			
333	Cloud	Concordia	1,062.1	-35,581	-13,111	-48,692	-76,375	-12,973	-17,303	-10,514	-2,316	-1,387	-120,870	-72,178	-114,644	-6,226			
334	Cloud	Southern Cloud	231.5	-10,378	-3,262	-13,640	-22,259	-1,455	-4,305	-1,984	0	-9	-30,014	-16,373	-33,413	3,399			
243	Coffey	Lebo-Waverly	548.0	-19,532	-5,380	-24,912	-42,267	-7,994	-7,100	-3,180	-2,059	0	-62,599	-37,687	-63,446	846			
244	Coffey	Burlington	823.5	-27,634	-13,279	-40,912	-59,787	0	-17,525	-8,294	0	0	-85,606	-44,694	-89,744	4,138			
245	Coffey	LeRoy-Gridley	260.0	-10,761	-2,969	-13,730	-22,841	-1,438	-3,919	-2,189	0	-32	-30,419	-16,689	-34,286	3,867			
300	Comanche	Comanche County	309.5	-12,392	-3,819	-16,212	-26,701	0	-5,041	-1,790	0	0	-33,532	-17,320	-40,080	6,548			
462	Cowley	Central	336.5	-13,569	-3,243	-16,812	-29,033	-7,535	-4,280	-2,327	-1,933	-336	-45,444	-28,631	-43,580	-1,864			
463	Cowley	Udall	391.3	-14,539	-3,947	-18,485	-30,802	-6,844	-5,208	-2,799	-1,407	0	-47,061	-28,575	-46,235	-826			
	Cowley	Winfield	2,459.4	-69,583	-23,787	-93,370	-149,572	-36,493	-31,392	-21,700	-10,808	-2,673	-252,639	-159,269	-224,516	-28,123			
	Cowley	Arkansas City	2,719.6	-85,992	-25,841	-111,833	-184,938	-47,092	-34,104	-18,970	-15,008	0	-300,111	-188,278	-277,603	-22,509			

1/19/2008		Col 1	Col 2	Col 3	Col 4	Col 5	Col 6	Col 7	Col 8	Col 9	Col 10	Col 11	Col 12	Col 13	Col 14		
GOVERNOR'S PROPOSED STATE AID REDUCTIONS						ACROSS THE BOARD - PROPOSED STATE AID REDUCTIONS (APPROX \$45M)											
		2008-09	2008-09 Est.	2008-09 Est.	2008-09 Est.	2008-09 Est.	2008-09 Est.	2008-09 Est.	2008-09 Est.	2008-09 Est.	2008-09 Est.	2008-09 Est.	Difference	2008-09 Est.	Difference		
		FTE Enrollment	GSA Reduction	Sped	Total Reduction	GSA Reduction	LOB Aid	Sped	KPERS	Bond & Int. Aid	Capital Outlay Aid	Total Reductions		GSA Reduction			
County Name	USD Name	(includes MILT)	(SF9001 Col 7)	Reduction	(Col 2 + Col 3)	@ \$47.30	Reduction	Reduction	Reduction	Reduction	Reduction	(Cols 5 thru Col 10)	(Col 11 - Col 4)	@ \$71	(Col 11 - Col 13)		
471	Cowley	Dexter	173.0	-8,032	-1,965	-9,997	-17,444	-1,346	-2,593	-1,405	0	-22,787	-12,791	-26,185	3,397		
246	Crawford	Northeast	530.0	-21,806	-5,407	-27,213	-47,257	-12,706	-7,136	-4,332	-1,930	-73,361	-46,147	-70,936	-2,425		
247	Crawford	Cherokee	706.5	-26,169	-7,281	-33,450	-56,736	-13,780	-9,609	-5,623	0	-85,748	-52,298	-85,165	-583		
248	Crawford	Girard	997.0	-33,195	-9,264	-42,459	-71,778	-15,454	-12,226	-6,335	-1,996	-108,640	-66,181	-107,743	-897		
249	Crawford	Frontenac	827.5	-26,575	-6,489	-33,064	-56,973	-11,403	-8,564	-5,084	-2,455	-84,479	-51,415	-85,520	1,041		
250	Crawford	Pittsburg	2,638.1	-81,297	-23,239	-104,536	-174,821	-26,072	-30,670	-16,504	-5,406	-255,540	-151,003	-262,416	6,876		
294	Decatur	Oberlin	366.5	-14,538	-3,731	-18,270	-31,100	-1,744	-4,924	-3,020	0	-40,858	-22,588	-46,683	5,825		
393	Dickinson	Solomon	388.6	-14,818	-3,655	-18,473	-31,838	-4,083	-4,823	-2,580	-1,045	-44,369	-25,896	-47,790	3,421		
435	Dickinson	Abilene	1,504.2	-42,760	-13,336	-56,096	-91,511	-18,901	-17,600	-8,764	-1,535	-139,835	-83,740	-137,364	-2,472		
473	Dickinson	Chapman	970.5	-35,708	-8,123	-43,831	-76,565	-11,416	-10,721	-6,419	0	-105,780	-61,949	-114,928	9,147		
481	Dickinson	Rural Vista	412.0	-16,090	-4,131	-20,221	-34,997	-4,091	-5,452	-2,879	-1,157	-48,767	-28,546	-52,533	3,766		
487	Dickinson	Herington	511.8	-20,161	-2,978	-23,139	-43,171	-10,438	-3,930	-3,437	0	-60,976	-37,837	-64,802	3,826		
406	Doniphan	Wathena	402.0	-14,774	-4,131	-18,905	-31,497	-4,669	-5,452	-2,364	0	-43,981	-25,077	-47,279	3,297		
425	Doniphan	Highland	223.0	-9,783	-3,354	-13,137	-21,257	-3,493	-4,426	-1,618	0	-30,794	-17,658	-31,907	1,113		
429	Doniphan	Troy	339.5	-13,022	-3,950	-16,972	-28,025	-7,259	-5,213	-2,264	0	-42,762	-25,790	-42,068	-694		
433	Doniphan	Midway	160.9	-8,312	-3,034	-11,345	-18,144	-261	-4,004	-1,527	0	-23,937	-12,591	-27,236	3,299		
486	Doniphan	Elwood	312.4	-12,535	-3,111	-15,646	-26,682	-3,645	-4,106	-2,357	-489	-37,279	-21,633	-40,051	2,772		
348	Douglas	Baldwin City	1,359.4	-37,594	-12,425	-50,019	-80,741	-14,809	-16,397	-9,897	-4,167	-128,163	-78,144	-121,197	-6,966		
491	Douglas	Eudora	1,396.3	-39,425	-12,851	-52,276	-84,421	-20,719	-16,960	-8,943	-10,757	-144,166	-91,890	-126,721	-17,446		
497	Douglas	Lawrence	10,487.2	-289,937	-121,283	-411,219	-623,182	0	-160,063	-74,409	0	-857,655	-446,435	-935,432	77,778		
347	Edwards	Kinsely-Offlerle	305.0	-13,119	-3,805	-16,924	-28,252	-1,644	-5,021	-2,691	0	-37,609	-20,685	-42,408	4,800		
502	Edwards	Lewis	101.6	-5,581	-1,475	-7,056	-11,740	0	-1,946	-819	0	-14,505	-7,449	-17,622	3,117		
282	Elk	West Elk	359.9	-14,871	-6,903	-21,773	-32,325	-4,673	-9,110	-4,247	0	-50,600	-28,827	-48,521	-2,079		
283	Elk	Elk Valley	186.0	-8,821	-3,214	-12,035	-19,384	-295	-4,241	-1,103	-257	-25,279	-13,245	-29,096	3,816		
388	Ellis	Ellis	368.1	-13,147	-4,229	-17,376	-28,087	-655	-5,582	-2,739	0	-37,182	-19,805	-42,160	4,978		
432	Ellis	Victoria	256.0	-10,055	-2,898	-12,953	-21,195	0	-3,825	-1,839	0	-26,859	-13,906	-31,815	4,956		
489	Ellis	Hays	2,767.3	-78,996	-32,222	-111,217	-170,256	-10,632	-42,525	-26,253	-102	-250,017	-138,800	-255,565	5,547		
327	Ellsworth	Ellsworth	602.6	-21,759	-5,243	-27,002	-46,926	-7,485	-6,919	-4,243	0	-66,022	-39,020	-70,439	4,417		
328	Ellsworth	Lorraine	453.0	-16,755	-3,980	-20,735	-36,142	0	-5,253	-3,095	0	-44,490	-23,755	-54,251	9,762		
363	Finney	Holcomb	865.5	-29,365	-5,848	-35,213	-63,429	0	-7,718	-6,775	0	-77,923	-42,709	-95,211	17,288		
457	Finney	Garden City	6,807.7	-220,368	-59,603	-279,971	-474,007	-57,823	-78,661	-53,297	-4,426	-673,677	-393,706	-711,512	37,836		
381	Ford	Spearville	352.5	-12,273	-3,644	-15,917	-26,814	-4,086	-4,809	-2,128	-1,457	-39,585	-23,667	-40,250	665		
443	Ford	Dodge City	5,584.2	-199,344	-53,948	-253,292	-428,595	-107,604	-71,198	-43,411	-36,776	-692,169	-438,877	-643,345	-48,824		
459	Ford	Bucklin	233.1	-9,895	-2,713	-12,608	-21,507	0	-3,581	-1,829	0	-26,917	-14,309	-32,284	5,367		
287	Franklin	West Franklin	699.0	-27,502	-10,834	-38,336	-59,177	-10,647	-14,298	-4,661	0	-88,782	-50,446	-88,828	46		
288	Franklin	Central Heights	547.0	-21,500	-5,229	-26,730	-46,293	-9,144	-6,902	-3,445	-1,455	-67,238	-40,509	-69,488	2,249		
289	Franklin	Wellsville	839.0	-26,911	-8,602	-35,513	-58,264	-11,355	-11,353	-5,810	-2,968	-90,547	-55,034	-87,458	-3,089		
290	Franklin	Ottawa	2,415.0	-72,991	-21,826	-94,817	-156,596	-29,914	-28,805	-16,958	-10,536	-244,941	-150,124	-235,060	-9,881		
475	Geary	Junction City	6,883.4	-201,994	-66,343	-268,337	-433,727	-127,627	-87,556	-46,965	-15,871	-717,217	-448,880	-651,049	-66,168		
291	Gove	Grinnell	81.5	-4,913	-1,189	-6,101	-10,269	0	-1,569	-698	0	-12,535	-6,434	-15,414	2,879		
292	Gove	Wheatland	112.5	-6,369	-2,150	-8,519	-13,949	-13	-2,837	-1,195	0	-17,994	-9,475	-20,938	2,944		
293	Gove	Quinter	265.0	-10,770	-4,046	-14,816	-23,305	-3,666	-5,340	-2,586	0	-35,081	-20,264	-34,982	-99		
281	Graham	Graham County	368.4	-13,870	-5,135	-19,004	-30,045	0	-6,777	-2,991	0	-39,813	-20,809	-45,099	5,286		
214	Grant	Ulysses	1,591.0	-48,706	-10,603	-59,309	-103,719	0	-13,993	-11,062	0	-128,774	-69,466	-155,689	26,914		
102	Gray	Cimarron-Ensign	658.2	-23,891	-5,818	-29,709	-51,467	-4,020	-7,679	-4,038	-1,715	-69,384	-39,675	-77,255	7,871		
371	Gray	Montezuma	224.2	-10,215	-1,785	-11,999	-22,288	-2,688	-2,355	-1,822	-707	-29,999	-18,000	-33,455	3,456		
	Gray	Copeland	112.5	-7,142	-1,033	-8,175	-15,373	-302	-1,364	-1,245	0	-18,284	-10,109	-23,075	4,791		
	ray	Ingalls	229.5	-10,924	-2,754	-13,678	-23,669	-1,480	-3,634	-1,659	0	-30,508	-16,830	-35,528	5,021		

	1/19/2008		Col 1	Col 2	Col 3	Col 4	Col 5	Col 6	Col 7	Col 8	Col 9	Col 10	Col 11	Col 12	Col 13	Col 14			
GOVERNOR'S PROPOSED STATE AID REDUCTIONS							ACROSS THE BOARD - PROPOSED STATE AID REDUCTIONS (APPROX \$45M)												
			2008-09	2008-09 Est.	2008-09 Est.	2008-09 Est.	2008-09 Est.	2008-09 Est.	2008-09 Est.	2008-09 Est.	2008-09 Est.	2008-09 Est.	2008-09 Est.	Difference	2008-09 Est.	Difference			
			FTE Enrollment	GSA Reduction	Sped	Total Reduction	GSA Reduction	LOB Aid	Sped	KPERS	Bond & Int. Aid	Capital Outlay Aid	Total Reductions		GSA Reduction				
No.	County Name	USD Name	(includes MILT)	(SF9001 Col 7)	Reduction	(Col 2 + Col 3)	@ \$47.30	Reduction	Reduction	Reduction	Reduction	Reduction	(Cols 5 thru Col 10)	(Col 11 - Col 4)	@ \$71	(Col 11 - Col 13)			
200	Greeley	Greeley County	212.0	-9,940	-1,699	-11,638	-21,479	0	-2,242	-1,717	-599	0	-26,037	-14,398	-32,241	6,204			
386	Greenwood	Madison-Virgil	226.5	-9,774	-2,680	-12,453	-20,784	-2,094	-3,537	-1,758	0	0	-28,172	-15,719	-31,197	3,025			
389	Greenwood	Eureka	600.5	-22,933	-5,658	-28,590	-49,537	-9,966	-7,467	-5,390	-3,968	-492	-76,819	-48,229	-74,358	-2,461			
390	Greenwood	Hamilton	99.5	-5,644	-1,662	-7,305	-11,797	-178	-2,193	-826	0	0	-14,997	-7,692	-17,707	2,710			
494	Hamilton	Syracuse	469.5	-19,184	-3,158	-22,342	-41,449	0	-4,168	-3,319	0	0	-48,936	-26,593	-62,217	13,282			
361	Harper	Anthony-Harper	823.7	-29,621	-10,885	-40,506	-64,068	-7,526	-14,365	-5,514	0	-649	-92,123	-51,617	-96,170	4,047			
511	Harper	Attica	141.5	-6,489	-1,739	-8,227	-14,304	0	-2,294	-1,016	0	0	-17,614	-9,387	-21,470	3,856			
369	Harvey	Burrton	244.2	-10,338	-2,349	-12,687	-21,782	-2,984	-3,101	-1,813	-312	-170	-30,161	-17,474	-32,696	2,535			
373	Harvey	Newton	3,383.4	-96,211	-32,739	-128,951	-206,815	-47,463	-43,208	-27,082	-24,024	-3,142	-351,734	-222,783	-310,440	-41,293			
439	Harvey	Sedgwick	533.0	-18,230	-4,730	-22,959	-38,862	-4,689	-6,242	-2,943	-2,400	-400	-55,536	-32,577	-58,334	2,798			
440	Harvey	Halstead	791.5	-27,026	-7,286	-34,313	-57,872	-7,835	-9,616	-4,856	-3,249	-689	-84,115	-49,802	-86,869	2,753			
460	Harvey	Hesston	820.1	-25,639	-7,268	-32,907	-55,157	-10,771	-9,592	-5,142	-5,025	-703	-86,389	-53,482	-82,793	-3,596			
374	Haskell	Sublette	460.9	-19,100	-3,207	-22,308	-41,179	0	-4,233	-4,079	0	0	-49,491	-27,184	-61,813	12,321			
507	Haskell	Satanta	343.5	-15,043	-2,533	-17,576	-32,330	0	-3,342	-3,106	0	0	-38,778	-21,202	-48,529	9,751			
227	Hodgeman	Jetmore	253.0	-10,573	-3,004	-13,577	-22,993	-1,343	-3,965	-1,887	-45	0	-30,232	-16,655	-34,513	4,281			
228	Hodgeman	Hanston	72.5	-3,591	-964	-4,556	-8,159	0	-1,273	-424	0	0	-9,856	-5,300	-12,248	2,392			
335	Jackson	North Jackson	360.0	-14,923	-3,181	-18,104	-32,363	-6,240	-4,198	-2,392	-950	-352	-46,495	-28,391	-48,578	2,083			
336	Jackson	Holton	1,053.3	-33,897	-10,431	-44,328	-72,643	-19,585	-13,767	-11,372	-2,569	-968	-120,904	-76,576	-109,042	-11,862			
337	Jackson	Mayetta	913.6	-32,532	-10,015	-42,546	-69,668	-22,176	-13,217	-7,108	0	-723	-112,892	-70,346	-104,576	-8,316			
338	Jefferson	Valley Halls	409.3	-15,298	-4,291	-19,589	-32,736	-7,408	-5,663	-2,883	-560	-173	-49,424	-29,834	-49,139	-285			
339	Jefferson	Jefferson County	487.5	-17,925	-5,884	-23,809	-38,739	-11,083	-7,766	-3,463	-3,376	0	-64,427	-40,618	-58,149	-6,278			
340	Jefferson	Jefferson West	916.0	-29,672	-9,001	-38,672	-63,997	-15,235	-11,879	-5,792	-3,612	-815	-101,330	-62,658	-96,063	-5,267			
341	Jefferson	Oskaloosa	523.6	-20,524	-8,578	-29,102	-43,875	-9,064	-11,321	-3,766	0	0	-68,026	-38,924	-65,860	-2,166			
342	Jefferson	McLouth	516.7	-19,007	-6,733	-25,740	-41,080	-5,680	-8,886	-3,506	0	-360	-59,511	-33,771	-61,664	2,152			
343	Jefferson	Perry	932.3	-30,722	-10,084	-40,806	-66,338	-9,846	-13,309	-6,240	-2,430	-695	-98,857	-58,051	-99,578	720			
107	Jewell	Rock Hills	265.0	0	-3,195	-3,195	-24,558	-5,343	-4,216	-2,517	-198	0	-36,832	-33,637	-36,863	32			
279	Jewell	Jewell	90.5	-5,753	-1,172	-6,925	-11,995	-267	-1,546	-1,158	0	-2	-14,968	-8,043	-18,006	3,038			
229	Johnson	Blue Valley	19,953.6	-516,645	-203,147	-719,793	-1,111,266	0	-268,104	-150,444	0	0	-1,529,815	-810,022	-1,668,074	138,259			
230	Johnson	Spring Hill	2,419.6	-64,826	-16,146	-80,972	-139,615	-18,347	-21,309	-15,000	-7,238	0	-201,509	-120,536	-209,571	8,062			
231	Johnson	Gardner-Edgerton	4,347.4	-117,958	-41,575	-159,532	-253,575	-45,523	-54,868	-33,370	-33,501	-5,599	-426,436	-266,904	-380,631	-45,805			
232	Johnson	DeSoto	6,071.9	-168,102	-54,389	-222,491	-361,604	-42,708	-71,780	-38,740	-20,475	-2,395	-537,702	-315,211	-542,788	5,086			
233	Johnson	Olathe	25,222.4	-678,855	-300,222	-979,077	-1,460,255	-136,220	-396,218	-214,981	-22,082	-11,187	-2,240,943	-1,261,866	-2,191,926	-49,016			
512	Johnson	Shawnee Mission	26,580.0	-727,283	-249,671	-976,954	-1,563,289	0	-329,504	-218,728	0	0	-2,111,520	-1,134,567	-2,346,586	235,065			
215	Kearny	Lakin	637.0	-24,301	-4,176	-28,477	-52,475	0	-5,511	-4,013	0	0	-61,999	-33,522	-78,767	16,769			
216	Kearny	Deerfield	278.0	-12,917	-2,285	-15,202	-28,172	0	-3,015	-2,776	0	0	-33,963	-18,761	-42,288	8,324			
331	Kingman	Kingman	1,033.3	-33,644	-13,115	-46,759	-72,203	-9,057	-17,309	-6,927	-1,967	0	-107,463	-60,704	-108,382	919			
332	Kingman	Cunningham	176.5	-8,261	-2,868	-11,129	-17,799	0	-3,786	-1,740	0	0	-23,325	-12,196	-26,717	3,392			
422	Kiowa	Greensburg	210.5	-13,159	-3,032	-16,191	-23,111	0	-4,002	-1,711	0	0	-28,823	-12,632	-34,691	5,868			
424	Kiowa	Mullinville	232.9	-7,011	-2,350	-9,360	-15,131	0	-3,101	-705	0	0	-18,938	-9,577	-22,713	3,775			
474	Kiowa	Haviland	138.5	-6,787	-1,655	-8,441	-14,630	0	-2,184	-1,487	0	0	-18,301	-9,859	-21,960	3,660			
503	Labette	Parsons	1,343.4	-43,545	-13,698	-57,243	-94,170	-21,709	-18,078	-9,834	-11,155	-1,250	-156,195	-98,952	-141,354	-14,841			
504	Labette	Oswego	473.6	-17,632	-4,179	-21,811	-38,275	-12,491	-5,516	-3,752	-2,175	-336	-62,546	-40,735	-57,453	-5,093			
505	Labette	Chetopa - St. Paul	503.8	-19,900	-5,892	-25,792	-42,551	-14,037	-7,776	-3,398	-1,551	-391	-69,705	-43,913	-63,872	-5,833			
506	Labette	Labette County	1,581.2	-46,560	-14,765	-61,325	-100,645	-29,194	-19,486	-9,950	-3,594	-1,276	-164,145	-102,821	-151,074	-13,071			
468	Lane	Healy	73.5	-4,519	-1,353	-5,871	-9,834	-6	-1,785	-879	0	0	-12,503	-6,632	-14,761	2,257			
482	Lane	Dighton	253.0	-10,271	-2,542	-12,813	-22,099	0	-3,355	-1,951	0	0	-27,405	-14,591	-33,171	5,767			
	Leavenworth	Ft. Leavenworth	1,829.8	-44,420	-12,919	-57,339	-95,972	-41,678	-17,050	-10,459	0	-52	-165,211	-107,872	-144,059	-21,152			
	Leavenworth	Easton	672.5	-23,335	-7,973	-31,308	-50,422	-10,098	-10,523	-4,492	-2,940	-454	-78,928	-47,620	-75,686	-3,242			

	1/19/2008		Col 1	Col 2	Col 3	Col 4	Col 5	Col 6	Col 7	Col 8	Col 9	Col 10	Col 11	Col 12	Col 13	Col 14			
GOVERNOR'S PROPOSED STATE AID REDUCTIONS							ACROSS THE BOARD - PROPOSED STATE AID REDUCTIONS (APPROX \$45M)												
			2008-09	2008-09 Est.	2008-09 Est.	2008-09 Est.	2008-09 Est.	2008-09 Est.	2008-09 Est.	2008-09 Est.	2008-09 Est.	2008-09 Est.	2008-09 Est.	Difference	2008-09 Est.	Difference			
			FTE Enrollment	GSA Reduction	Sped	Total Reduction	GSA Reduction	LOB Aid	Sped	KPERS	Bond & Int. Aid	Capital Outlay Aid	Total Reductions		GSA Reduction				
No.	County Name	USD Name	(includes MILT)	(SF9001 Col 7)	Reduction	(Col 2 + Col 3)	@ \$47.30	Reduction	Reduction	Reduction	Reduction	Reduction	(Cols 5 thru Col 10)	(Col 11 - Col 4)	@ \$71	(Col 11 - Col 13)			
453	Leavenworth	Leavenworth	3,875.2	-114,728	-41,879	-156,606	-246,651	-48,563	-55,270	-37,703	-7,829	-5,305	-401,321	-244,714	-370,237	-31,084			
458	Leavenworth	Basehor-Linwood	2,166.0	-55,879	-16,020	-71,898	-119,953	-20,165	-21,142	-10,429	-7,179	-1,716	-180,583	-108,684	-180,056	-527			
464	Leavenworth	Tonganoxie	1,777.1	-47,439	-13,898	-61,337	-108,752	-20,397	-18,342	-9,958	-7,073	-1,449	-165,971	-104,633	-163,243	-2,728			
469	Leavenworth	Lansing	2,408.0	-65,836	-17,831	-83,667	-141,659	-29,870	-23,533	-10,867	-10,867	-2,023	-218,819	-135,151	-212,638	-6,181			
298	Lincoln	Lincoln	337.0	-13,196	-3,793	-16,989	-28,096	-2,656	-5,006	-2,454	-490	-156	-38,858	-21,870	-42,174	3,316			
299	Lincoln	Sylvan Grove	145.5	-6,871	-1,537	-8,408	-14,748	-129	-2,029	-1,256	0	0	-18,162	-9,754	-22,138	3,975			
344	Linn	Pleasanton	359.0	-14,363	-2,778	-17,141	-31,114	-4,751	-3,666	-2,617	0	-324	-42,473	-25,332	-46,704	4,231			
346	Linn	Jayhawk	525.9	-20,921	-4,119	-25,040	-44,585	-7,144	-5,436	-3,784	-622	-392	-61,963	-36,923	-66,925	4,961			
362	Linn	Prairie View	933.5	-32,294	-13,735	-46,029	-69,961	0	-18,126	-6,746	0	0	-94,834	-48,805	-105,016	10,182			
274	Logan	Oakley	412.7	-15,402	-5,617	-21,018	-33,124	-1,045	-7,413	-2,983	0	0	-44,565	-23,547	-49,721	5,156			
275	Logan	Triplains	86.5	-4,637	-740	-5,377	-9,924	0	-976	-758	0	0	-11,658	-6,281	-14,896	3,238			
251	Lyon	North Lyon Co.	513.0	-20,207	-4,925	-25,133	-43,369	-6,407	-6,500	-3,997	-1,266	-439	-61,979	-36,846	-65,100	3,121			
252	Lyon	Southern Lyon Co.	509.4	-20,026	-5,865	-25,890	-43,123	-5,882	-7,740	-3,722	-2,665	-439	-63,572	-37,682	-64,731	1,158			
253	Lyon	Emporia	4,307.1	-146,405	-34,729	-181,134	-315,472	-64,622	-45,834	-38,414	-19,185	-4,057	-487,584	-306,450	-473,542	-14,042			
397	Marion	Centre	229.2	-10,602	-3,337	-13,939	-23,059	-1,157	-4,404	-1,857	-63	-91	-30,631	-16,692	-34,613	3,982			
398	Marion	Peabody-Burns	336.5	-13,627	-5,262	-18,889	-29,194	-3,139	-6,945	-2,537	-1,173	0	-42,987	-24,098	-43,821	834			
408	Marion	Marion	597.8	-21,623	-7,998	-29,621	-45,777	-6,028	-10,555	-3,605	-2,474	0	-68,439	-38,818	-68,714	275			
410	Marion	Durham-Hills	590.8	-21,472	-8,828	-30,300	-45,947	-9,719	-11,651	-4,417	-1,200	-1,046	-73,981	-43,681	-68,969	-5,012			
411	Marion	Goessel	245.3	-10,125	-3,683	-13,808	-21,611	-4,229	-4,860	-1,912	-1,064	-220	-33,897	-20,089	-32,440	-1,457			
364	Marshall	Marysville	733.2	-25,560	-9,418	-34,978	-54,584	-7,131	-12,430	-7,515	0	-51	-81,711	-46,733	-81,934	223			
380	Marshall	Vermillion	525.5	-19,402	-3,916	-23,318	-41,648	-7,290	-5,169	-3,510	-1,365	0	-58,981	-35,663	-62,516	3,535			
488	Marshall	Axtell	296.9	-11,653	-2,793	-14,447	-24,960	-4,801	-3,686	-2,236	-1,000	-120	-36,804	-22,358	-37,467	662			
498	Marshall	Valley Heights	363.0	-14,644	-5,468	-20,111	-31,630	-7,838	-7,216	-3,047	-1,047	-329	-51,106	-30,995	-47,478	-3,628			
400	McPherson	Smoky Valley	1,017.8	-32,085	-10,191	-42,275	-69,432	-11,608	-13,449	-6,022	-3,538	-801	-104,849	-62,574	-104,221	-628			
418	McPherson	McPherson	2,259.8	-59,767	-22,422	-82,189	-128,973	-11,917	-29,591	-18,883	-1,142	-1,558	-192,065	-109,876	-193,596	1,531			
419	McPherson	Canton-Galva	369.5	-14,517	-4,520	-19,037	-30,986	-4,269	-5,965	-2,930	-826	-84	-45,059	-26,022	-46,512	1,453			
423	McPherson	Moundridge	437.0	-15,712	-4,223	-19,935	-34,203	-18	-5,573	-2,858	0	0	-42,650	-22,716	-51,340	8,690			
448	McPherson	Inman	442.9	-15,496	-4,214	-19,709	-33,328	-4,753	-5,561	-2,929	-1,432	0	-48,002	-28,293	-50,027	2,025			
225	Meade	Fowler	162.0	-7,924	-2,002	-9,926	-17,501	-978	-2,642	-1,468	0	-15	-22,605	-12,679	-26,270	3,665			
226	Meade	Meade	458.9	-17,622	-4,509	-22,131	-36,861	0	-5,950	-3,226	0	0	-46,037	-23,907	-55,330	9,293			
367	Miami	Osawatomie	1,123.5	-38,350	-16,430	-54,780	-82,917	-18,751	-21,684	-7,680	-6,376	0	-137,407	-82,627	-124,463	-12,944			
368	Miami	Paola	2,029.1	-55,449	-20,053	-75,502	-119,281	-18,616	-26,465	-24,072	-3,241	-1,373	-193,048	-117,546	-179,048	-14,000			
416	Miami	Louisburg	1,644.7	-44,578	-11,933	-56,512	-95,981	-8,895	-15,749	-8,268	-3,816	-388	-133,097	-76,586	-144,073	10,976			
272	Mitchell	Waconda	359.5	-14,518	-3,485	-18,003	-31,549	-3,883	-4,599	-2,378	0	-207	-42,616	-24,613	-47,357	4,741			
273	Mitchell	Beloit	717.7	-23,873	-8,320	-32,193	-51,075	-9,255	-10,980	-8,425	0	-724	-80,459	-48,266	-76,666	-3,793			
436	Montgomery	Caney	810.6	-27,770	-6,073	-33,842	-59,920	-8,776	-8,014	-4,884	0	0	-81,594	-47,752	-89,943	8,349			
445	Montgomery	Coffeyville	1,807.4	-56,553	-17,793	-74,346	-121,987	-18,966	-23,483	-10,376	-3,914	-2,460	-181,185	-106,839	-183,109	1,924			
446	Montgomery	Independence	1,840.1	-54,271	-15,212	-69,484	-116,869	-21,541	-20,077	-12,008	0	-1,207	-171,702	-102,218	-175,427	3,725			
447	Montgomery	Cherryvale	881.0	-30,395	-6,773	-37,168	-65,671	-15,888	-8,938	-5,269	-2,190	0	-97,956	-60,788	-98,576	620			
417	Morris	Morris County	765.4	-27,679	-8,364	-36,043	-59,201	-4,995	-11,038	-6,215	-376	-577	-82,401	-46,359	-88,864	6,462			
217	Morton	Rolla	200.0	-9,086	-1,558	-10,644	-19,530	0	-2,056	-1,945	0	0	-23,531	-12,887	-29,316	5,785			
218	Morton	Elkhart	676.5	-24,327	-4,040	-28,367	-50,313	0	-5,332	-5,199	0	0	-60,844	-32,477	-75,523	14,678			
441	Nemaha	Sabetha	935.5	-30,158	-8,941	-39,099	-65,274	-15,615	-11,799	-6,415	0	-1,550	-100,654	-61,555	-97,980	-2,674			
442	Nemaha	Nemaha Valley	439.0	-16,290	-4,391	-20,682	-35,418	-3,246	-5,796	-4,105	-1,066	0	-49,631	-28,950	-53,165	3,533			
451	Nemaha	B & B	192.5	-8,724	-1,531	-10,255	-18,896	-2,367	-2,021	-1,518	0	0	-24,801	-14,546	-28,365	3,563			
101	Neosho	Erie	550.0	-22,877	-9,753	-32,630	-48,743	-9,113	-12,872	-4,459	-2,179	-533	-77,899	-45,268	-73,166	-4,733			
	Neosho	Chanute	1,773.0	-60,454	-23,157	-83,611	-128,571	-36,726	-30,562	-10,599	-13,484	-1,471	-221,413	-137,802	-192,992	-28,421			
	ess	Western Plains	159.0	-8,169	-2,114	-10,283	-17,506	0	-2,790	-1,194	0	0	-21,490	-11,207	-26,277	4,787			

1/19/2008		Col 1	Col 2	Col 3	Col 4	Col 5	Col 6	Col 7	Col 8	Col 9	Col 10	Col 11	Col 12	Col 13	Col 14			
GOVERNOR'S PROPOSED STATE AID REDUCTIONS						ACROSS THE BOARD - PROPOSED STATE AID REDUCTIONS (APPROX \$45M)												
		2008-09	2008-09 Est.	2008-09 Est.	2008-09 Est.	2008-09 Est.	2008-09 Est.	2008-09 Est.	2008-09 Est.	2008-09 Est.	2008-09 Est.	2008-09 Est.	Difference	2008-09 Est.	Difference			
		FTE Enrollment	GSA Reduction	Sped	Total Reduction	GSA Reduction	LOB Aid	Sped	KPERS	Bond & Int. Aid	Capital Outlay Aid	Total Reductions		GSA Reduction				
No.	County Name	USD Name	(includes MILT)	(SF9001 Col 7)	Reduction	(Col 2 + Col 3)	@ \$47.30	Reduction	Reduction	Reduction	Reduction	Reduction	(Col 11 - Col 4)	@ \$71	(Col 11 - Col 13)			
303	Ness	Ness City	274.5	-10,207	-2,794	-13,001	-22,326	0	-3,688	-1,724	0	-27,737	-14,736	-33,512	5,775			
211	Norton	Norton	683.7	-23,051	-8,496	-31,547	-49,788	-10,860	-11,212	-4,528	0	-425	-76,813	-45,266	-74,735	-2,079		
212	Norton	Northern Valley	206.5	-9,482	-2,619	-12,101	-20,523	-3,108	-3,456	-1,622	0	0	-28,709	-16,608	-30,807	2,098		
213	Norton	West Solomon	38.0	-2,603	-722	-3,324	-5,217	0	-952	-325	0	0	-6,494	-3,170	-7,831	1,337		
420	Osage	Osage City	644.5	-22,693	-8,729	-31,422	-49,060	-4,610	-11,521	-3,943	-2,743	-577	-72,453	-41,031	-73,641	1,188		
421	Osage	Lyndon	431.0	-16,069	-5,521	-21,590	-34,113	-3,246	-7,287	-2,410	0	-199	-47,255	-25,664	-51,205	3,950		
434	Osage	Santa Fe	1,118.7	-36,203	-14,928	-51,132	-77,619	-19,367	-19,702	-7,224	-3,575	-375	-127,862	-76,730	-116,511	-11,351		
454	Osage	Burlingame	330.0	-12,275	-4,027	-16,301	-26,322	-4,532	-5,314	-1,921	-1,675	0	-39,765	-23,464	-39,512	-254		
456	Osage	Marais Des Cygnes	267.0	-12,156	-3,346	-15,501	-25,996	-2,154	-4,415	-1,819	0	-216	-34,601	-19,100	-39,022	4,420		
392	Osborne	Osborne	334.8	-13,229	-5,407	-18,636	-28,612	-3,085	-7,135	-2,231	-853	-236	-42,152	-23,517	-42,948	796		
239	Ottawa	North Ottawa Co.	602.9	-20,995	-5,721	-26,715	-45,138	-7,792	-7,550	-3,944	-863	-441	-65,728	-39,013	-67,755	2,027		
240	Ottawa	Twin Valley	610.5	-21,991	-5,890	-27,882	-47,305	-10,544	-7,774	-3,604	-2,843	0	-72,070	-44,188	-71,007	-1,063		
495	Pawnee	Ft. Larned	863.5	-29,263	-12,177	-41,440	-62,923	-14,075	-16,071	-9,984	-2,017	-677	-105,747	-64,307	-94,451	-11,295		
496	Pawnee	Pawnee Heights	148.2	-6,737	-1,991	-8,729	-14,649	-1,168	-2,628	-1,310	0	-1	-19,755	-11,027	-21,989	2,233		
110	Phillips	Thunder Ridge	232.0	0	-3,755	-3,755	-23,716	-4,830	-4,955	-2,187	0	-65	-35,753	-31,999	-35,599	-154		
325	Phillips	Phillipsburg	655.5	-22,403	-8,095	-30,498	-48,383	-11,372	-10,683	-3,952	-1,159	-541	-76,090	-45,592	-72,626	-3,464		
326	Phillips	Logan	168.5	-8,226	-2,375	-10,601	-17,307	-697	-3,134	-1,438	0	0	-22,577	-11,976	-25,979	3,402		
320	Pottawatomie	Wamego	1,293.0	-37,394	-14,649	-52,043	-80,774	-16,088	-19,334	-11,958	-6,521	-1,192	-135,866	-83,823	-121,247	-14,620		
321	Pottawatomie	Kaw Valley	1,123.0	-34,984	-15,017	-50,001	-75,619	0	-19,818	-9,030	0	0	-104,467	-54,466	-113,508	9,041		
322	Pottawatomie	Onaga	317.5	-13,399	-2,960	-16,359	-28,470	-3,893	-3,906	-2,250	-1,006	-284	-39,809	-23,450	-42,735	2,926		
323	Pottawatomie	Westmoreland	818.5	-27,757	-9,251	-37,008	-59,475	-6,972	-12,210	-4,598	-3,286	0	-86,541	-49,533	-89,275	2,734		
382	Pratt	Pratt	1,093.2	-36,269	-12,473	-48,742	-78,182	-11,803	-16,461	-7,814	-2,555	-1,271	-118,086	-69,344	-117,356	-730		
438	Pratt	Skyline	358.0	-13,658	-4,344	-18,002	-29,775	-2,365	-5,733	-2,819	0	0	-40,691	-22,689	-44,695	4,003		
105	Rawlins	Rawlins County	317.5	-12,132	-3,408	-15,540	-26,308	-1,999	-4,497	-2,574	0	-19	-35,398	-19,858	-39,490	4,093		
308	Reno	Hutchinson	4,553.6	-135,373	-38,509	-173,882	-291,458	-54,990	-50,822	-34,879	-18,366	-3,780	-454,295	-280,413	-437,495	-16,800		
309	Reno	Nickerson	1,139.4	-39,116	-12,497	-51,613	-84,014	-14,042	-16,492	-7,660	-1,826	-430	-124,464	-72,851	-126,110	1,646		
310	Reno	Fairfield	297.2	-13,416	-4,860	-18,276	-29,312	0	-6,414	-2,750	0	0	-38,476	-20,199	-43,999	5,523		
311	Reno	Pretty Prairie	271.1	-10,806	-2,717	-13,523	-23,622	-3,232	-3,586	-2,253	-516	-155	-33,363	-19,841	-35,457	2,094		
312	Reno	Haven	993.0	-33,404	-11,055	-44,459	-70,595	-12,366	-14,590	-6,756	-2,222	-205	-106,734	-62,275	-105,968	-766		
313	Reno	Buhler	2,151.0	-60,458	-25,241	-85,699	-129,891	-24,421	-33,312	-12,445	-4,913	-2,389	-207,371	-121,672	-194,973	-12,398		
109	Republic	Republic County	479.0	0	-6,790	-6,790	-39,732	-4,329	-8,961	-3,379	-145	-154	-56,700	-49,911	-59,640	2,940		
426	Republic	Pike Valley	253.5	-10,546	-3,251	-13,797	-23,040	-3,069	-4,291	-1,772	0	0	-32,172	-18,374	-34,584	2,413		
376	Rice	Sterling	524.1	-19,292	-6,840	-26,132	-41,624	-9,614	-9,027	-3,703	0	-113	-64,082	-37,949	-62,480	-1,602		
401	Rice	Chase	140.5	-7,032	-1,983	-9,015	-15,018	0	-2,617	-1,187	0	0	-18,821	-9,806	-22,543	3,721		
405	Rice	Lyons	737.1	-30,361	-10,228	-40,589	-64,825	-11,436	-13,498	-8,128	-2,086	-239	-100,212	-59,623	-97,306	-2,907		
444	Rice	Little River	300.0	-11,786	-3,963	-15,749	-25,376	-220	-5,230	-2,070	0	0	-32,897	-17,148	-38,092	5,195		
378	Riley	Riley County	649.5	-22,704	-6,630	-29,335	-49,216	-10,185	-8,751	-4,148	-1,769	-314	-74,383	-45,048	-73,876	-507		
383	Riley	Manhattan	5,898.0	-157,279	-62,612	-219,891	-337,944	-4,670	-82,632	-42,167	0	0	-467,413	-247,522	-507,274	39,861		
384	Riley	Blue Valley	199.5	-9,271	-2,872	-12,143	-19,857	-1,147	-3,790	-1,645	-66	0	-26,505	-14,362	-29,806	3,301		
269	Rooks	Palco	164.0	-7,633	-2,444	-10,076	-16,621	0	-3,225	-1,434	0	0	-21,280	-11,204	-24,949	3,669		
270	Rooks	Plainville	381.9	-14,010	-5,067	-19,077	-29,747	0	-6,687	-2,669	0	0	-39,103	-20,026	-44,652	5,549		
271	Rooks	Stockton	298.0	-11,853	-4,094	-15,947	-25,296	-1,107	-5,403	-2,181	0	-141	-34,128	-18,181	-37,971	3,843		
395	Rush	LaCrosse	300.5	-11,729	-3,683	-15,412	-25,088	-1,727	-4,860	-2,283	0	0	-33,958	-18,545	-37,658	3,701		
403	Rush	Otis-Bison	171.5	-8,643	-2,946	-11,589	-18,253	0	-3,888	-1,738	0	0	-23,878	-12,290	-27,399	3,520		
399	Russell	Paradise	125.6	-6,738	-1,959	-8,697	-14,829	0	-2,586	-1,410	0	0	-18,825	-10,128	-22,259	3,434		
407	Russell	Russell	926.5	-31,223	-9,274	-40,497	-67,034	-5,150	-12,240	-7,119	0	-310	-91,852	-51,355	-100,621	8,769		
	Saline	Salina	6,974.7	-200,544	-79,763	-280,307	-431,475	-69,005	-105,267	-64,299	-24,493	-4,944	-699,483	-419,176	-647,669	-51,813		
	Saline	Southeast of Saline	680.6	-23,873	-6,071	-29,944	-51,585	-553	-8,012	-4,496	0	0	-64,646	-34,703	-77,433	12,786		

1/19/2008		Col 1	Col 2	Col 3	Col 4	Col 5	Col 6	Col 7	Col 8	Col 9	Col 10	Col 11	Col 12	Col 13	Col 14		
GOVERNOR'S PROPOSED STATE AID REDUCTIONS						ACROSS THE BOARD - PROPOSED STATE AID REDUCTIONS (APPROX \$45M)											
		2008-09	2008-09 Est.	2008-09 Est.	2008-09 Est.	2008-09 Est.	2008-09 Est.	2008-09 Est.	2008-09 Est.	2008-09 Est.	2008-09 Est.	2008-09 Est.	Difference	2008-09 Est.	Difference		
		FTE Enrollment (includes MILT)	GSA Reduction (SF9001 Col 7)	Sped Reduction	Total Reduction (Col 2 + Col 3)	GSA Reduction @ \$47.30	LOB Aid Reduction	Sped Reduction	KPERs Reduction	Bond & Int. Aid Reduction	Capital Outlay Aid Reduction	Total Reductions (Cols 5 thru Col 10)	(Col 11 - Col 4)	GSA Reduction @ \$71	(Col 11 - Col 13)		
No.	County Name	USD Name															
307	Saline	Ell-Saline	451.2	-16,740	-4,000	-20,740	-35,924	-7,874	-5,279	-2,803	-1,304	-418	-53,602	-32,862	-53,925	323	
466	Scott	Scott County	859.2	-30,287	-5,795	-36,082	-64,810	-1,267	-7,648	-6,091	0	0	-79,816	-43,735	-97,284	17,468	
259	Sedgwick	Wichita	45,579.7	-1,473,650	-430,327	-1,903,977	-3,151,405	-533,126	-567,924	-363,309	-75,753	-61,253	-4,752,770	-2,848,793	-4,730,439	-22,331	
260	Sedgwick	Derby	6,303.3	-169,303	-54,382	-223,684	-364,167	-67,189	-71,770	-44,960	-13,645	-5,665	-567,397	-343,712	-546,636	-20,761	
261	Sedgwick	Haysville	4,668.2	-136,607	-44,054	-180,661	-293,998	-90,360	-58,140	-35,127	-29,597	-7,140	-514,362	-333,701	-441,308	-73,055	
262	Sedgwick	Valley Center	2,523.3	-66,974	-23,776	-90,751	-143,896	-36,945	-31,379	-12,652	-22,604	-2,233	-249,710	-158,959	-215,996	-33,713	
263	Sedgwick	Mulvane	1,818.5	-47,572	-13,826	-61,398	-101,908	-28,736	-18,247	-11,989	-10,395	0	-171,275	-109,877	-152,970	-18,306	
264	Sedgwick	Clearwater	1,282.5	-37,048	-11,714	-48,762	-79,379	-17,170	-15,460	-7,285	-5,212	-2,082	-126,588	-77,825	-119,152	-7,436	
265	Sedgwick	Goddard	4,833.5	-126,398	-39,386	-165,784	-272,519	-64,260	-51,980	-29,414	-43,765	-7,048	-468,986	-303,202	-409,067	-59,919	
266	Sedgwick	Maize	6,337.8	-165,138	-54,551	-219,689	-355,795	-69,298	-71,993	-33,232	-35,337	-5,561	-571,216	-351,527	-534,069	-37,147	
267	Sedgwick	Renwick	1,928.3	-49,980	-17,476	-67,456	-107,773	-23,104	-23,064	-10,607	-9,775	-2,432	-176,754	-109,299	-161,774	-14,981	
268	Sedgwick	Cheney	782.3	-25,014	-6,446	-31,460	-54,211	-13,463	-8,507	-5,175	-3,685	-1,331	-86,371	-54,911	-81,373	-4,998	
480	Seward	Liberal	4,288.0	-142,463	-22,576	-165,039	-306,244	-34,476	-29,795	-30,308	-9,833	-2,814	-413,471	-248,431	-459,690	46,219	
483	Seward	Kismet-Plains	714.5	-32,327	-6,286	-38,612	-68,594	0	-8,295	-5,414	0	0	-82,303	-43,691	-102,964	20,661	
345	Shawnee	Seaman	3,483.3	-94,439	-36,589	-131,028	-203,329	-26,720	-48,288	-24,975	-7,870	-4,440	-315,621	-184,594	-305,208	-10,414	
372	Shawnee	Silver Lake	717.8	-23,434	-6,654	-30,088	-50,308	-12,658	-8,782	-5,923	-3,369	-389	-81,428	-51,341	-75,516	-5,913	
437	Shawnee	Auburn Washburn	5,356.4	-141,969	-61,157	-203,126	-304,934	-17,696	-80,712	-37,208	0	0	-440,550	-237,424	-457,723	17,173	
450	Shawnee	Shawnee Heights	3,367.9	-93,908	-33,003	-126,912	-201,796	-40,457	-43,556	-23,151	-7,190	-4,300	-320,450	-193,538	-302,907	-17,542	
501	Shawnee	Topeka	12,903.7	-405,191	-160,267	-565,458	-860,704	-181,432	-211,512	-112,074	-26,400	-15,453	-1,407,576	-842,118	-1,291,966	-115,610	
412	Sheridan	Hoxie	293.5	-11,145	-2,310	-13,455	-23,934	-56	-3,049	-2,188	0	0	-29,227	-15,772	-35,926	6,699	
352	Sherman	Goodland	906.4	-31,482	-9,275	-40,757	-67,663	-7,540	-12,241	-6,573	0	-512	-94,529	-53,772	-101,566	7,036	
237	Smith	Smith Center	446.0	-17,184	-5,792	-22,976	-37,003	-7,415	-7,644	-3,182	0	-257	-55,501	-32,525	-55,543	43	
349	Stafford	Stafford	272.0	-11,267	-2,945	-14,212	-23,915	-3,334	-3,887	-2,064	-884	-90	-34,173	-19,960	-35,898	1,725	
350	Stafford	St. John-Hudson	362.2	-14,273	-4,529	-18,803	-30,296	-1,928	-5,977	-2,615	-86	-68	-40,970	-22,167	-45,476	4,506	
351	Stafford	Macksville	302.2	-12,045	-3,369	-15,415	-25,802	0	-4,447	-2,063	0	0	-32,312	-16,897	-38,731	6,419	
452	Stanton	Stanton County	423.2	-18,130	-3,160	-21,290	-38,469	0	-4,170	-3,417	0	0	-46,056	-24,766	-57,744	11,689	
209	Stevens	Moscow	208.2	-10,424	-1,539	-11,963	-21,261	0	-2,032	-2,307	0	0	-25,600	-13,637	-31,915	6,314	
210	Stevens	Hugoton	947.7	-32,941	-6,564	-39,505	-70,567	0	-8,663	-6,885	0	0	-86,115	-46,609	-105,925	19,810	
353	Sumner	Wellington	1,664.0	-45,514	-20,815	-66,329	-98,001	-27,536	-27,471	-11,289	-11,143	-1,713	-177,152	-110,823	-147,105	-30,047	
356	Sumner	Conway Springs	527.9	-19,285	-5,498	-24,783	-41,766	-9,339	-7,255	-3,657	-5,650	0	-67,668	-42,885	-62,693	-4,975	
357	Sumner	Belle Plaine	691.5	-25,178	-9,470	-34,648	-54,135	-16,421	-12,498	-5,434	-4,229	-556	-93,272	-58,624	-81,260	-12,013	
358	Sumner	Oxford	342.6	-13,624	-4,918	-18,542	-29,009	-6,592	-6,490	-2,529	-2,045	0	-46,665	-28,123	-43,544	-3,121	
359	Sumner	Argonia	187.0	-8,608	-2,543	-11,151	-18,031	-1,587	-3,356	-1,432	0	-129	-24,534	-13,383	-27,065	2,531	
360	Sumner	Caldwell	221.5	-9,721	-3,271	-12,992	-21,176	-2,979	-4,317	-1,620	-1,068	-193	-31,353	-18,361	-31,787	434	
509	Sumner	South Haven	226.5	-9,692	-3,171	-12,863	-20,968	-2,533	-4,185	-1,781	-984	0	-30,452	-17,589	-31,474	1,022	
314	Thomas	Brewster	91.5	-5,014	-1,331	-6,345	-10,496	0	-1,757	-832	0	0	-13,085	-6,740	-15,755	2,670	
315	Thomas	Colby	930.9	-30,386	-10,153	-40,539	-65,695	-10,655	-13,399	-6,105	-1,643	0	-97,497	-56,958	-98,612	1,114	
316	Thomas	Golden Plains	189.4	-8,955	-3,062	-12,017	-19,261	-1,138	-4,041	-1,409	-265	-136	-26,250	-14,233	-28,911	2,662	
208	Trego	WaKeeney	443.5	-16,355	-4,339	-20,694	-34,855	-1,001	-5,727	-3,465	0	0	-45,048	-24,354	-52,320	7,272	
329	Wabaunsee	Alma	463.7	-17,856	-5,619	-23,475	-38,620	-3,216	-7,416	-3,394	-799	-170	-53,615	-30,141	-57,972	4,356	
330	Wabaunsee	Wabaunsee East	473.5	-18,547	-7,592	-26,139	-40,200	-4,249	-10,020	-4,383	-1,261	-416	-60,529	-34,390	-60,343	-186	
241	Wallace	Wallace	193.5	-9,234	-2,195	-11,429	-19,525	-127	-2,897	-1,676	0	0	-24,225	-12,796	-29,309	5,084	
242	Wallace	Weskan	102.5	-5,554	-1,086	-6,640	-11,877	-989	-1,433	-935	0	0	-15,235	-8,595	-17,828	2,594	
108	Washington	Washington Co. Schools	400.0	0	-6,303	-6,303	-33,143	-8,821	-8,318	-2,725	-1,392	0	-54,398	-48,096	-49,750	-4,649	
223	Washington	Barnes	336.3	-13,534	-4,419	-17,953	-29,042	-5,826	-5,831	-2,896	-326	-132	-41,754	-23,801	-43,594	1,840	
224	Washington	Clifton-Clyde	294.0	-12,039	-3,928	-15,967	-25,490	-1,845	-5,183	-2,171	0	-169	-34,859	-18,892	-38,262	3,403	
	Wichita	Leoti	426.1	-17,086	-3,134	-20,219	-37,183	-2,987	-4,136	-3,266	0	-166	-47,737	-27,518	-55,813	8,076	
	Wilson	Altoona-Midway	179.0	-9,552	-3,519	-13,071	-20,505	0	-4,645	-1,667	0	0	-26,816	-13,746	-30,779	3,962	

1/19/2008			Col 1	Col 2	Col 3	Col 4	Col 5	Col 6	Col 7	Col 8	Col 9	Col 10	Col 11	Col 12	Col 13	Col 14			
GOVERNOR'S PROPOSED STATE AID REDUCTIONS							ACROSS THE BOARD - PROPOSED STATE AID REDUCTIONS (APPROX \$45M)												
			2008-09	2008-09 Est.	2008-09 Est.	2008-09 Est.	2008-09 Est.	2008-09 Est.	2008-09 Est.	2008-09 Est.	2008-09 Est.	2008-09 Est.	2008-09 Est.	2008-09 Est.	Difference	2008-09 Est.	Difference		
No.	County Name	USD Name	FTE Enrollment (includes MILT)	GSA Reduction (SF9001 Col 7)	Sped Reduction	Total Reduction (Col 2 + Col 3)	GSA Reduction @ \$47.30	LOB Aid Reduction	Sped Reduction	KPERS Reduction	Bond & Int. Aid Reduction	Capital Outlay Aid Reduction	Total Reductions (Cols 5 thru Col 10)	(Col 11 - Col 4)	GSA Reduction @ \$71	(Col 11 - Col 13)			
461	Wilson	Neodesha	718.7	-25,819	-6,828	-32,647	-55,483	-14,144	-9,011	-5,745	-2,233	-169	-86,785	-54,137	-83,283	-3,502			
484	Wilson	Fredonia	743.8	-26,437	-7,283	-33,720	-56,708	-9,727	-9,612	-4,484	0	-617	-81,149	-47,428	-85,122	3,973			
366	Woodson	Woodson	401.5	-16,286	-5,824	-22,110	-34,865	-5,066	-7,686	-3,048	0	0	-50,665	-28,555	-52,334	1,669			
202	Wyandotte	Turner	3,830.0	-118,560	-35,211	-153,771	-255,354	-58,786	-46,470	-29,447	-18,627	-6,498	-415,182	-261,410	-383,301	-31,881			
203	Wyandotte	Piper	1,584.0	-40,925	-10,309	-51,234	-87,344	0	-13,605	-7,920	-80	0	-108,950	-57,716	-131,109	22,159			
204	Wyandotte	Bonner Springs	2,285.0	-66,384	-17,181	-83,565	-142,803	-22,166	-22,675	-15,231	-7,716	-2,995	-213,586	-130,021	-214,356	770			
500	Wyandotte	Kansas City	18,485.7	-648,549	-144,321	-792,870	-1,392,384	-304,378	-190,468	-170,696	-46,969	-32,772	-2,137,667	-1,344,797	-2,090,048	-47,619			
TOTALS			448,325.6	-13,931,669	-4,464,507	-18,396,176	-30,049,912	-4,410,898	-5,892,041	-3,400,000	-1,026,241	-313,657	-45,092,749	-26,696,574	-45,106,634	13,884			

KANSAS LEGISLATIVE RESEARCH DEPARTMENT

010-West-Statehouse, 300 SW 10th Ave.
Topeka, Kansas 66612-1504
(785) 296-3181 ♦ FAX (785) 296-3824

kslegres@klrd.state.ks.us

<http://www.kslegislature.org/klrd>

January 21, 2009

To: Senator Jay Emler, Chairman
Members of the Senate Ways & Means Committee

From: Cody Gorges, Fiscal Analyst

Re: Surplus Property Overview

The State Surplus Property Program is designed to efficiently and effectively dispose of, or reallocate excess and surplus state property. The program enables the reuse of agency excess property to reduce expenditures for supply and capital outlay items. The program also provides a means for other state agencies, local units of government and non-profit organizations to acquire surplus equipment at a reduced cost.

When an agency identifies surplus property, the process for disposition depends upon the location of the agency. If the agency is located in Shawnee County, State Surplus Property shall collect and dispose of the items. If the agency is located outside of Shawnee County, the agency may dispose of property through the State Surplus Property program, or may dispose surplus property without using the program on its own in the same manner as the program. As a practical matter, this allows agencies located outside of Shawnee County to dispose of property locally, rather incurring the cost of shipping the property to Shawnee County.

Once the State Surplus Property Program is designated to dispose of the property, the program must first give other state agencies, local units of government and non-profit entities an opportunity to purchase the property or equipment. These entities have 30 days to make purchases. Property remaining after 30 days may be sold to the general public. Property may be disposed by:

- Selling at fixed prices;
- Selling at negotiated prices; or
- Selling by advertised public auction or advertised sealed bids.

According to the Department of Administration, the program currently does not sell at negotiated prices despite statutory authority to do so.

In addition to the methods of disposal above, property valued by the program at \$500 or less may be disposed by:

- Selling the property to a junkyard as defined by statute;
- Giving the property to a not-for-profit organization that is exempt from federal income tax; or
- Utilizing normal trash delivery or landfill services if the property has minimal value.

More information about the program may be found at <http://www.kslegislature.org/klrd>

Senate Ways & Means Cmte
Date 1-21-2009
Attachment 4

SENATE BILL No. 30

By Committee on Ways and Means

1-15

Proposed amendments
January 21, 2009
Committee on Ways and Means

Senate Ways & Means Cmte
Date 1-21-2009
Attachment 5

9 AN ACT concerning surplus property of the state; amending K.S.A. 2008
10 Supp. 75-6606 and repealing the existing section.

11
12 *Be it enacted by the Legislature of the State of Kansas:*

13 New Section 1. (a) All sales, trade-ins or other disposition of personal
14 property described in subsection (b) owned by the legislature shall be
15 exempt from the provisions of the state surplus property act.

16 (b) The legislature is hereby authorized to sell computer equipment
17 leased to the legislature, not to be returned to the lessor and that is
18 scheduled for replacement for the fair market value of such computer
19 equipment as fixed by the director of legislative administrative services
20 after consultation with the legislative chief information technology officer
21 and legislative director of computer services and subject to the following:

22 (1) The computer equipment must be in use by a member of the
23 legislature or by legislative staff. **“Member of the legislature” means a**
24 **member of the legislature who is a member of the house of representa-**
25 **tives or the senate.**

26 (2) Each such item that is not to be returned to the lessor shall be
27 offered first and may be sold to the member of the legislature or legis-
28 lative staff who is assigned to use such computer equipment, and who is
29 hereby authorized to purchase such computer equipment.

30 (3) If any such member of the legislature or legislative staff declines
31 the offer to purchase the computer equipment assigned to such person,
32 then such computer equipment shall be offered and may be sold to other
33 members of the legislature or legislative staff, on a drawing basis, and
34 who are hereby authorized to purchase such computer equipment.

35 (4) No more than two additional purchases shall be authorized for
36 any such person by the director of legislative administrative services who
37 is authorized to determine the order of priority for such purchases.

38 (c) All moneys received from the sale of such computer equipment
39 shall be deposited in the state treasury in accordance with the provisions
40 of K.S.A. 75-4215, and amendments thereto, and shall be credited to the
41 legislative special revenue fund.

42 New Sec. 2. (a) All sales, trade-ins or other disposition of personal
43 property described in subsection (b) owned by **the Kansas highway patrol**

a local public library for fair market value. The director of legislative administrative services shall establish and carry out a procedure whereby such libraries are notified of the authorization to purchase such computer equipment pursuant to this section. If any remaining computer equipment is not sold to such libraries, then such computer equipment shall be offered and may be sold to

(d) As used in this section:
(1) "Member of the legislature" means a member of the legislature who is a member of the house of representatives or the senate.
(2) "Local public library" means any library established pursuant to article 12 of chapter 12 of the Kansas Statutes Annotated, and amendments thereto, and any library which is operating pursuant to an interlocal agreement between a city, county or township and a school district pursuant to K.S.A. 12-2901 et seq., and amendments thereto, or K.S.A. 72-8230, and amendments thereto.

a state agency

5-2

1 shall be exempt from the provisions of the state surplus property act.

2 (b) ~~The superintendent of the Kansas highway patrol is hereby au-~~
3 ~~thorized to sell personal sidearms to retiring troopers and other retiring~~
4 ~~sworn officers of the Kansas highway patrol subject to the following:~~

The agency head of any state agency who employs persons who are authorized to carry firearms when discharging the duties of such person's employment is hereby authorized to sell the personal sidearm of such person to such person who is authorized to carry such firearm

5 (1) A retiring trooper or retiring sworn officer with the Kansas high-
6 way patrol who resigns from the Kansas highway patrol to accept em-
7 ployment with a local, state or federal law enforcement agency, is hereby
8 authorized to purchase, upon resignation, such trooper or other officer's
9 personal sidearm with a trigger lock;

retiring employee from such agency or a resigning employee who resigns from such state agency to accept employment with a local, state or federal law enforcement agency, is hereby authorized to purchase, upon such retirement or resignation, such employee's

10 (2) each sale of such personal sidearm shall be for the amount equal
11 to the total of the replacement cost of the sidearm plus the cost of the
12 trigger lock; and

13 (3) no sale of a personal sidearm shall be made to any ~~retiring trooper~~
14 ~~or sworn officer of the Kansas highway patrol unless the superintendent~~
15 ~~of the Kansas highway patrol~~ determines that the employment record and
16 performance evaluations of each such ~~trooper or sworn officer~~ is
17 satisfactory.

resigning or retiring employee unless the agency head of such state agency from which such person is resigning or retiring

employee

18 (c) All moneys received from the sale of personal sidearms and trigger
19 locks to such resigning ~~troopers and officers~~ shall be deposited in the
20 state treasury in accordance with the provisions of K.S.A. 75-4215, and
21 amendments thereto, and shall be credited to the ~~highway patrol general~~
22 ~~fee fund.~~

or retiring state employee

appropriate special revenue fund of such state agency

23 Sec. 3. K.S.A. 2008 Supp. 75-6606 is hereby amended to read as
24 follows: 75-6606. (a) Except as provided in subsection (b) and sections 1
25 and 2, and amendments thereto, all sales, trade-ins or other disposition
26 of personal property owned by state agencies shall be made in accordance
27 with the state surplus property act and rules and regulations authorized
28 by such act.

29 (b) Subject to rules and regulations adopted pursuant to the state
30 surplus property act or as otherwise directed by the governor, state agen-
31 cies may transfer or loan personal property to other state agencies with
32 or without charging a fee therefor. In accordance with procedures pre-
33 scribed by the director of purchases, a state agency may trade in personal
34 property in conjunction with a purchase by the state agency. The state
35 agency shall give the secretary of administration or a designee of the
36 secretary notice of the proposed trade-in. The secretary of administration
37 or the secretary's designee may elect to provide for disposition of the
38 property under the surplus property program in lieu of permitting the
39 state agency to trade in the property.

40 Sec. 4. K.S.A. 2008 Supp. 75-6606 is hereby repealed.

41 Sec. 5. This act shall take effect and be in force from and after its
42 publication in the Kansas register.