

Approved May 2, 1992
Date

MINUTES OF THE Senate COMMITTEE ON Legislative & Congressional Apportionment

The meeting was called to order by Senator Vidricksen at
Chairperson

8:00 ~~xxx~~/p.m. on April 9, 1992 in room 521S of the Capitol.

All members were present except:

Committee staff present:

STAFF: Harland Priddle
Mary Galligan
Raney Gilliland
Robert Coldsnow

Conferees appearing before the committee:

The Senate Legislative and Congressional Apportionment Committee met at 8:00 a.m. on April 9th in Room 521S of the capitol with the following members present: Senator Vidricksen, Senator Thiessen, Senator Bond, Senator Parrish, Senator Francisco, Senator Hayden, Senator Karr, Senator Salisbury, Senator Yost, Senator Steineger and Senator Moran.

The Chairman called the meeting to order at 8:06 a.m.

Mr. Priddle distributed a set of maps, (**April 8 - Senate Alternate - Exhibit A**) and briefed the committee on the changes. He noted that the deviation for the whole state was 1.06 and supplied a chart of Legislative District Statistics (**Exhibit B**).

The Chairman asked Senator Karr if they (Democrats) had any changes in the maps that they have presented.

Senator Karr responded by saying that they started from a different premise and drew a constitutional map to start with, therefore they didn't have any reasons to change maps.

Senator Vidricksen acknowledged that the last time the committee met they (Republicans) took some of the comments that were made regarding their (Democrats) particular map and changed some of the lines and the results were what were presented today.

Senator Karr asked if House members were still being accomodated as he noted earlier. The Chairman responded by stating that he did not think they had accomodated any House members on this particular map and, in fact, there are some House members that are very unhappy because they would not make certain changes.

Senator Karr said that he failed to understand the logic that was used in compacting and collapsing districts and thought this was drawn as another political map.

Senator Vidricksen asked if he was implying that there were no political implications in the maps that they have drawn.

Senator Karr explained that they tried to recognize entities such as counties and to maintain their integrity as much as possible, tried to maintain existing districts that were of correct population and attempted to draw maps with that in mind. He stated that he did not understand how Johnson County was an island unto itself and that there was no way that anyone could cross it.

Unless specifically noted, the individual remarks recorded herein have not been transcribed verbatim. Individual remarks as reported herein have not been submitted to the individuals appearing before the committee for editing or corrections.

CONTINUATION SHEET

MINUTES OF THE Senate COMMITTEE ON Legislative & Congressional Apportionment
room 521S, Statehouse, at 8:00 a.m./~~p.m.~~ on April 9, 1992

Senator Vidricksen retorted that this was wrong and that they did split Wyandotte and Johnson County although they didn't do it the same way as they (Democrats) had proposed but had made other changes (on the west side) to bend to their wishes which in turn made them change other areas in this configuration.

At this point, Senator Steineger made a motion to adjourn and this was seconded by Senator Francisco.

The Chairman stated that it was obvious that they did not want to talk about the issues. Senator Steineger responded by saying that it was just a waste of time and that it should be resolved in appropriate channels. The Chairman asked Senator Steineger just what were the appropriate channels and how did he perceive it to work. Senator Steineger responded that it didn't make a bit of difference because it was going to end up in court and the court was going to make the decision.

The Chairman stated that he would like to rule the motion out of order.

Senator Karr, commenting on the motion, stated that he thought it was in order and if he thought they were serious in drawing a map this would have been an effort in which everybody would have been involved and there would not have been another blind alley in which there was no participation on the part of any of the Democrats. He felt the only other alternative was to lay both maps in bill form onto the floor without recommendation and let the Body look at those maps.

Senator Vidricksen responded by saying that this could have been done in January had they not tried to compromise and that they had tried to work with them but the Democratic maps were as political as the Republican maps and he did not feel as though they were all at fault.

The Chairman announced that they would adjourn for 15 minutes and then come back and see if there was anything else to discuss.

Senator Steineger asked to make a substitute motion to report both maps to the floor of the Senate without recommendation. It was seconded by Senator Karr.

In the discussion that ensued Senator Salisbury stated that discussion here convinced her that the constitutional resolution that was debated on the floor yesterday (April 8th) was the right way to go although there were not enough votes for it. She was under the impression that the map that was presented by (Republican) Staff earlier was in many respects, responsive to concerns that had been brought up by the Democratic Caucus. She did not perceive any input by Democrats on concerns that the Republicans had and instead of accusing it would be better to discuss and vote on them.

The Chairman declared the meeting adjourned and reconvened.

Senator Steineger reiterated that the Committee was just wasting time and that it was so unconstitutional that it was not worth the time. The most constitutional map will be the one that prevails in the final analysis. It is going to end up in court and the court will pick the most constitutional map. They (Democrats) believe that they have a very constitutional map that will meet any court so put out any map you want, we'll go to court and see what the court decides.

CONTINUATION SHEET

MINUTES OF THE Senate COMMITTEE ON Legislative & Congressional Apportionment
room 521S, Statehouse, at 8:00 a.m. ~~pm~~ on April 9, 1992

Senator Yost agreed that this would end up in court and he thought that it would be the Republican map that would be upheld. He stated that he had been primarily involved in drawing up Sedgwick County and that he would be perfectly willing to defend the Sedgwick County map in court. On another matter, Senator Yost referred to the House map and requested some kind of a briefing on what the House map does. He understood that they (House) had split cities and engaged in some things that were questionable and the bill would no doubt need amendments, therefore he requested that the Chairman schedule a hearing for House maps.

The Chairman responded by saying that he would try and do that. Senator Steineger asked that the two bills be divorced so that it would expedite the proceedings. The Chairman agreed that the Committee could have an informational meeting on the House map.

The Chairman declared the meeting in recess for 15 minutes.

Upon reconvening, Senator Steineger repeated his motion to report both maps to the Senate without recommendation. This was seconded by Senator Francisco.

Senator Bond made a substitute motion that the map (April 8 Senate Alternate) as presented be amended into HB 3083. This was seconded by Senator Salisbury.

After considerable discussion regarding procedure the Chairman ruled Senator Steineger's motion a substitute motion and Senator Steineger called for the question.

Senator Steineger, Senator Parrish, Senator Francisco, Senator Hayden, and Senator Karr voted "Aye". Senator Bond, Senator Thiessen, Senator Salisbury, Senator Yost, Senator Moran and Senator Vidricksen voted "Nay".

Senator Bond stated that there was still an underlying motion to adjourn and he made a substitute motion to amend this map into HB 3083.

Senator Francisco indicated that the House map was agreed to by both parties in the House and he thought it should be allowed to go through the process on its own and let the Senate work on its own.

Senator Karr wanted to make certain that it was understood that this effort has not been without a great deal of work on a bi-partisan basis and that it had gone back to January and February and developed maps through a period of time with the target date of February 14. They then found that the Sedgwick County problem was growing and affecting every part of the state which it still does. They then went through a very laborious, detailed effort to try and make Sedgwick County happy by having a maximum amount of districts out in that area. Suddenly the whole process was cancelled. He requested that this be on the record and added that they had no intention of stopping the process which has been dormant for the last three weeks. He added that by going through the process of putting both the House and the Senate map in the same bill that it is complicating the lives of the Senate and House members who went in good faith and negotiated a map long ago. In summary he stated that he felt this motion would guarantee that they would not get either map to the Governor by April 11 and thus have violated their concerns about anybody running or having a filing date by this current law.

CONTINUATION SHEET

MINUTES OF THE Senate COMMITTEE ON Legislative & Congressional Apportionment
room 521S Statehouse, at 8:00 ~~am~~/p.m. on April 9, 1992

Senator Vidricksen responded by saying that they (Republicans) had no intentions of not working with him (Democrats) and, granted there are lots of differences, if they had decided that they did not want to work with their party they would have put the process through in January or February but rather chose to work together. Now they have to move the process along.

The Chairman called for a vote on the motion. Senator Bond, Senator Thiessen, Senator Salisbury, Senator Yost, Senator Moran and Senator Vidricksen voted "Aye". Senator Steineger, Senator Parrish, Senator Francisco, Senator Hayden, and Senator Karr voted "Nay". Motion carried.

Senator Steineger made a motion to report the Senate Democrat map favorable for passage. This was seconded by Senator Karr.

Senator Bond made a substitute motion that HB 3083 as amended be passed out favorably. This was seconded by Senator Salisbury.

The Chairman called for a vote. Senator Bond, Senator Thiessen, Senator Salisbury, Senator Yost, Senator Moran and Senator Vidricksen voted "Aye". Senator Steineger, Senator Parrish, Senator Francisco, Senator Hayden, and Senator Karr voted "Nay". Motion carried.

Senator Steineger then made a motion to adjourn which was seconded by Senator Karr. The Chairman adjourned the meeting at 9:05 a.m.

DB: KANSAS

Legislative District Statistics
Sec. of State Total Pop. - All Ages
Plan: April 2 Statewide Republican -2

Date: 4/ 8/92
Time: 5:43 p.m.
Page: 1

Plan type: KANSAS SENATE DISTRICTS

District Name	Number Members	Total Population	Ideal Population	District Variance	% District Variance
District 1	1	61,318	61,135	183	0.30%
District 2	1	61,381	61,135	246	0.40%
District 3	1	62,044	61,135	909	1.49%
District 4	1	61,559	61,135	424	0.69%
District 5	1	61,239	61,135	104	0.17%
District 6	1	62,211	61,135	1,076	1.76%
District 7	1	61,457	61,135	322	0.53%
District 8	1	61,149	61,135	14	0.02%
District 9	1	61,618	61,135	483	0.79%
District 10	1	61,475	61,135	340	0.56%
District 11	1	60,996	61,135	-139	-0.23%
District 12	1	60,904	61,135	-231	-0.38%
District 13	1	61,868	61,135	733	1.20%
District 14	1	59,284	61,135	-1,851	-3.03%
District 15	1	62,790	61,135	1,655	2.71%
District 16	1	60,268	61,135	-867	-1.42%
District 17	1	61,635	61,135	500	0.82%
District 18	1	62,966	61,135	1,831	3.00%
District 19	1	61,305	61,135	170	0.28%
District 20	1	61,144	61,135	9	0.01%
District 21	1	59,298	61,135	-1,837	-3.00%
District 22	1	61,298	61,135	163	0.27%
District 23	1	61,795	61,135	660	1.08%
District 24	1	60,962	61,135	-173	-0.28%
District 25	1	59,886	61,135	-1,249	-2.04%
District 26	1	60,735	61,135	-400	-0.65%
District 27	1	60,912	61,135	-223	-0.36%
District 28	1	61,914	61,135	779	1.27%
District 29	1	60,593	61,135	-542	-0.89%
District 30	1	60,836	61,135	-299	-0.49%
District 31	1	60,128	61,135	-1,007	-1.65%
District 32	1	59,245	61,135	-1,890	-3.09%
District 33	1	61,826	61,135	691	1.13%
District 34	1	61,029	61,135	-106	-0.17%
District 35	1	60,519	61,135	-616	-1.01%
District 36	1	60,591	61,135	-544	-0.89%
District 37	1	62,025	61,135	890	1.46%
District 38	1	60,690	61,135	-445	-0.73%
District 39	1	61,849	61,135	714	1.17%
District 40	1	60,638	61,135	-497	-0.81%
Total	40	2,445,380	2,445,400	-20	0.00%

DB: KANSAS

Legislative District Statistics
Sec. of State Total Pop. - All Ages
Plan: April 2 Statewide Republican -2

Date: 4/ 8/92
Time: 5:43 p.m.
Page: 2

Plan type: KANSAS SENATE DISTRICTS

<u>District</u> <u>Name</u>	<u>Number</u> <u>Members</u>	<u>Total</u> <u>Population</u>	<u>Ideal</u> <u>Population</u>	<u>District</u> <u>Variance</u>	<u>% District</u> <u>Variance</u>
PLANWIDE STATISTICS:					
Range of populations:	59,245 to 62,966				
Ratio range:	1.0628				
Absolute range:	-1,890 to 1,831				
Absolute overall range:	3,721				
Relative range:	-3.09 to 3.00%				
Relative overall range:	6.09%				
Absolute mean deviation:	645.30				
Relative mean deviation:	1.06%				
Standard deviation:	836.7114				

Apr 8 Senate Alternate
DEFAULT

KLRDSR
April 8, 1992

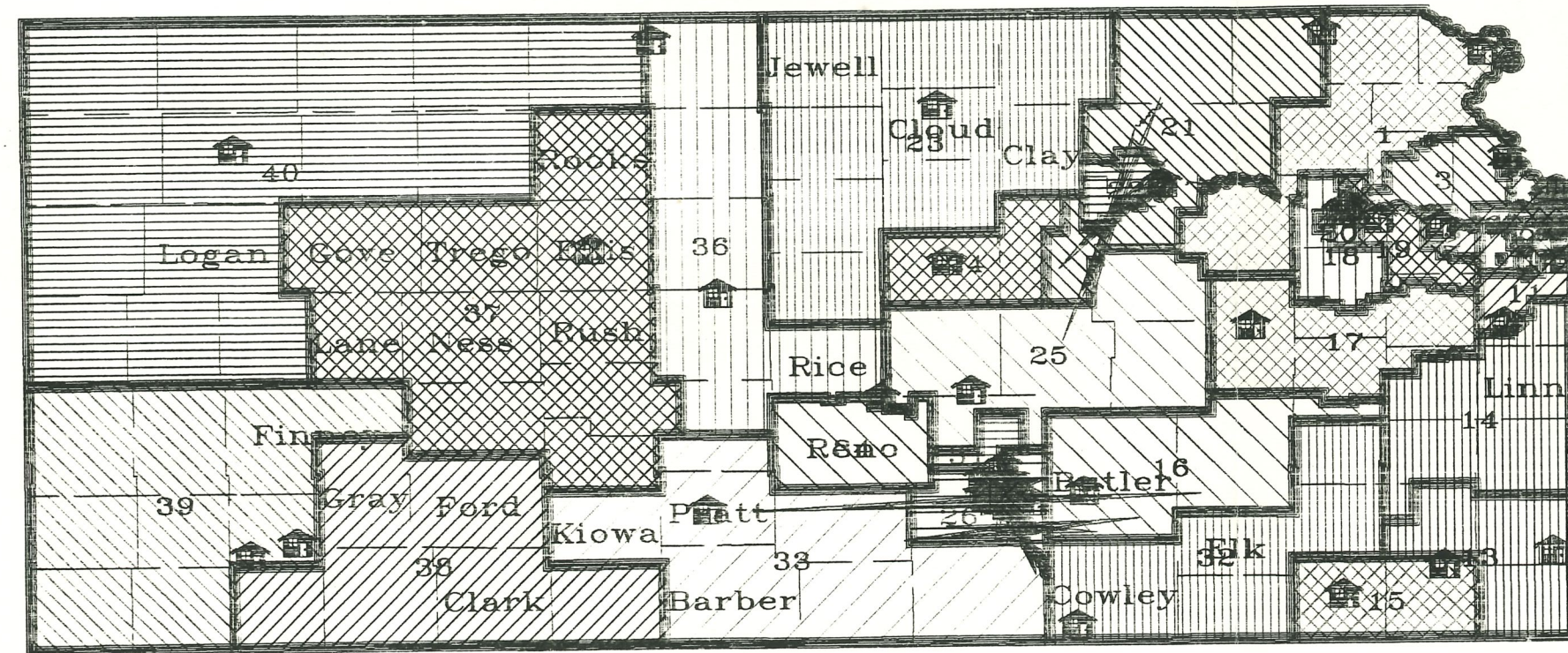
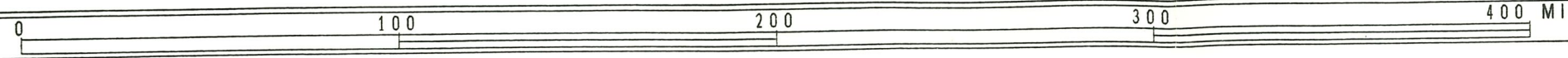

- LEGEND
- County Boundary
 - Dist. Boundary (SEN)
 - District 1
 - District 2
 - District 3
 - District 4
 - District 5
 - District 6
 - District 7
 - District 8
 - District 9
 - District 10
 - District 11
 - District 12
 - District 13
 - District 14
 - District 15
 - District 16
 - District 17
 - District 18
 - District 19
 - District 20
 - District 21
 - District 22
 - District 23
 - District 24
 - District 25
 - District 26
 - District 27
 - District 28

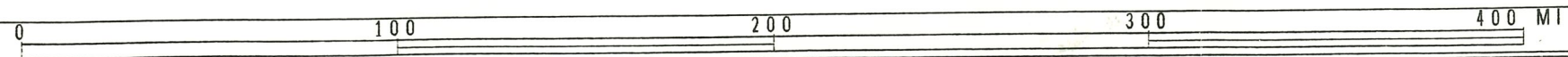

Johson County Apr 8 Senate Alternative

KLRDSR
April 8, 1992

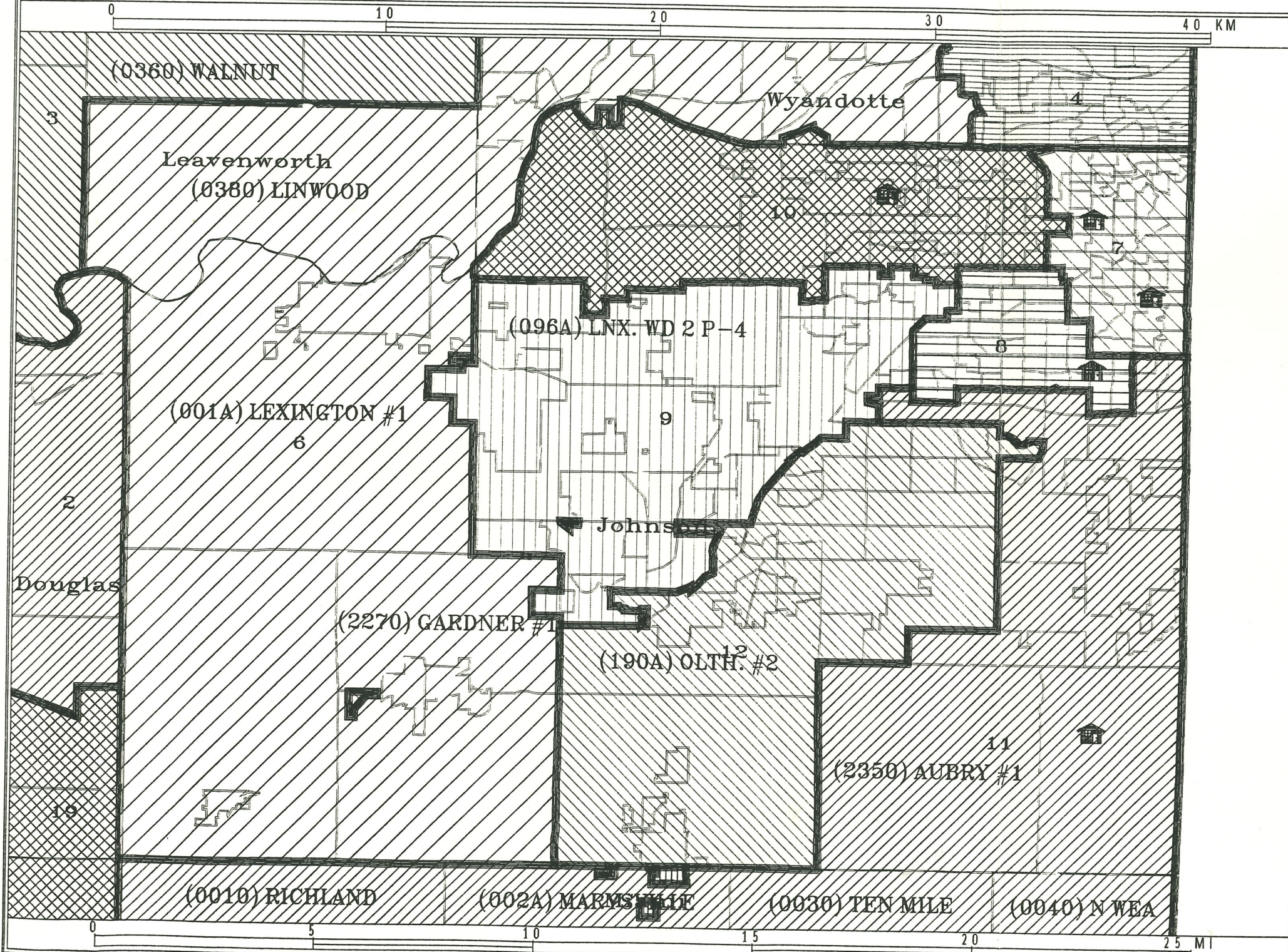

LEGEND

- County Boundary
- VTD Boundary
- Dist. Boundary (SEN)
- District 2
- District 3
- District 4
- District 6
- District 7
- District 8
- District 9
- District 10
- District 11
- District 12
- District 14
- District 19
- 19 County
- 177A VTD
- Home Seat

Apr 8 Senate Alternate
Leav

KLRDSR
April 8, 1992

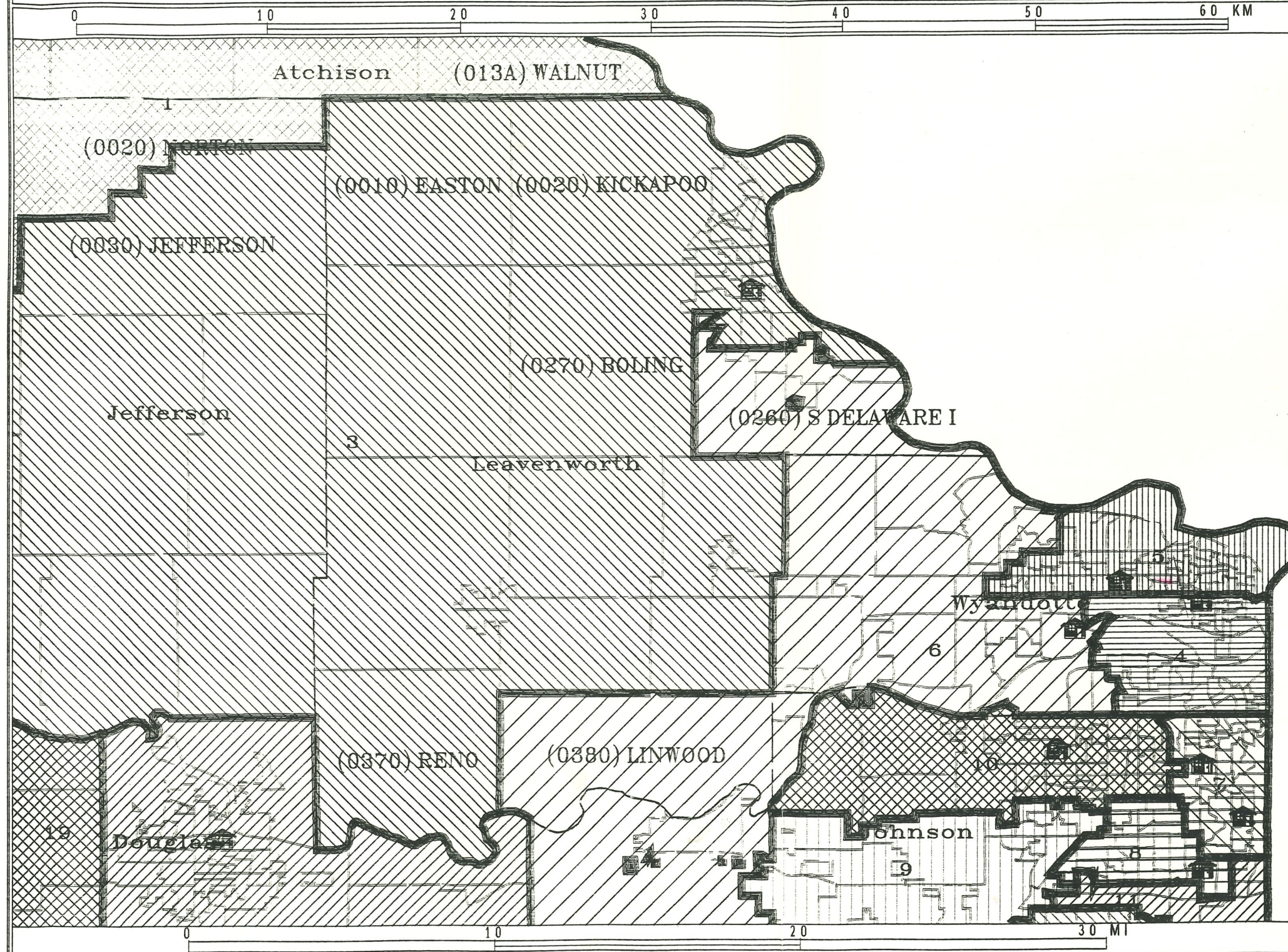

LEGEND

- County Boundary
- VTD Boundary
- Dist. Boundary (SEN)
- [Cross-hatch pattern] District 1
- [Diagonal lines /] District 2
- [Diagonal lines \] District 3
- [Horizontal lines] District 4
- [Vertical lines] District 5
- [Diagonal lines /] District 6
- [Diagonal lines \] District 7
- [Horizontal lines] District 8
- [Vertical lines] District 9
- [Cross-hatch pattern] District 10
- [Diagonal lines /] District 11
- [Diagonal lines \] District 12
- [Cross-hatch pattern] District 19
- 19 County
- 177A VTD
- [House icon] Home Seat

Apr 8 Senate Alternate
Shawnee

KLRDSR
April 8, 1992

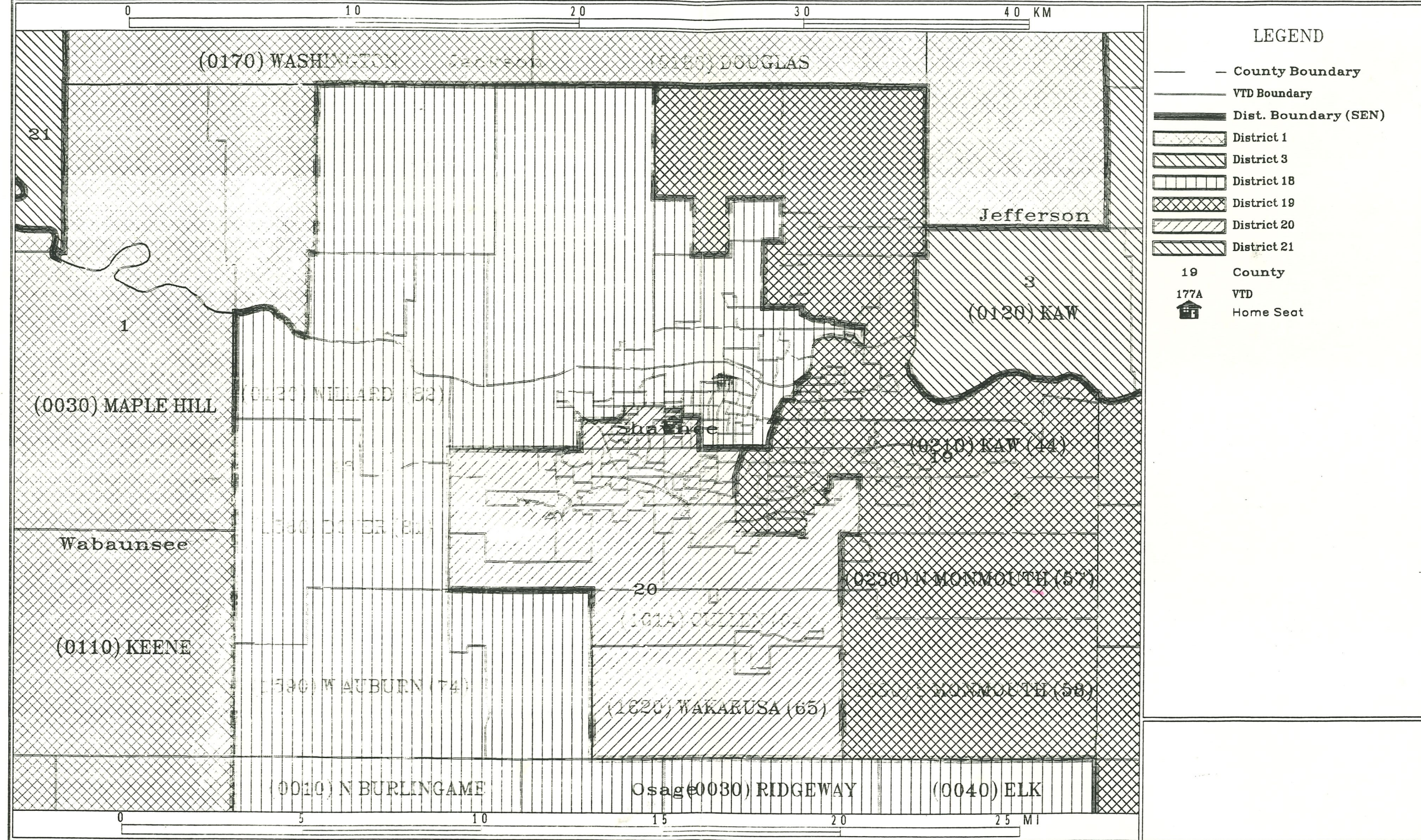

Apr 8 Senate Alternative
Sedgwick

KLRDSR
April 8, 1992

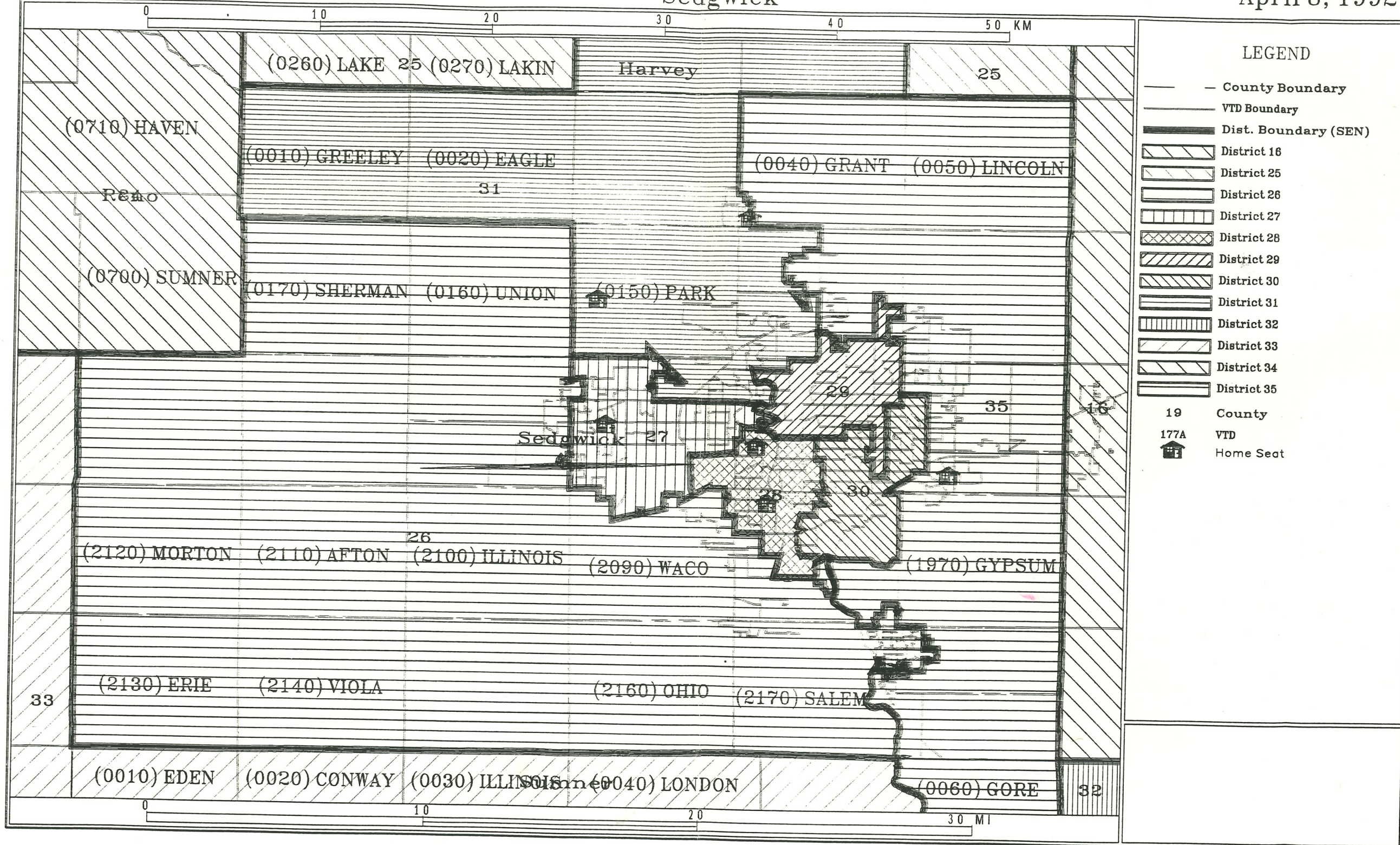

LEGEND

- County Boundary
- VTD Boundary
- Dist. Boundary (SEN)
- [Pattern] District 16
- [Pattern] District 25
- [Pattern] District 26
- [Pattern] District 27
- [Pattern] District 28
- [Pattern] District 29
- [Pattern] District 30
- [Pattern] District 31
- [Pattern] District 32
- [Pattern] District 33
- [Pattern] District 34
- [Pattern] District 35
- 19 County
- 177A VTD
- [House Icon] Home Seat