

WAYS AND MEANS COMMITTEE

Minutes of Meeting
March 28, 1961

Meeting was called to order by the Vice-Chairman, Senator Smith, with all members present except: Senator Lauterbach, Senator Harper, Senator Hults.

Senator Sanborn moved that House Bill #79 which had been referred to this committee be amended as follows: Sec. 2, line 4, by striking the word "restricted" after the word "the", and striking all of lines 5, 6, and 7, and inserting in lieu thereof the words "general revenue fund." Motion seconded by Senator Glades, carried.

Senator Doty moved that House Bill #79 be recommended for passage as amended. Motion seconded by Senator Ward, carried.

Senator Van Sickle moved that the subcommittee report for remodeling the Senate Ways and Means Committee room be approved except for deleting the acoustical tile on the walls, and that an amount of \$3,000 be included in the Omnibus bill for this purpose (remodeling and furniture). Motion seconded by Senator Sanborn, carried.

Meeting adjourned 11:00 A.M.



Glee S. Smith
Vice-Chairman

THE STATE OF KANSAS



DEPARTMENT OF ADMINISTRATION
STATEHOUSE · TOPEKA

Budget Division

March 23, 1961

The Honorable Theo. A. Sanborn
Senate Chambers
Third Floor, Statehouse
Topeka, Kansas

Dear Senator Sanborn:

Attached hereto is supplemental material relative to the Senate Ways and Means Room Study which was forwarded to Chairman Lauterbach on February 15, 1961.

Chart No. 1E has been revised (see attached) to include the 14' by 40" conference table with ten drawers which you have suggested replace the present conference table. We have learned from the State Reformatory that a walnut table meeting the specifications as shown on the detailed sheet (also see attached) would cost approximately \$200.

A new type radiator (convactor-type unit) would cost approximately \$250 as estimated by the State Architect's Office. The Architect's Office has recommended a sloping top unit, 44" long, 20" high and 10" deep.

It would cost \$85 to apply acoustical tile to the ceiling of the room. However, the State Architect's Office does not feel that applying tile only to the ceiling will afford any great benefit, instead the Architect's Office recommends tiling the ceiling and the upper walls. This would cost approximately \$200 and would have additional benefits of affording a brighter room as well as eliminating the necessity for future painting of the wall surfaces.

This would bring the total approximate cost to \$2,642.

Attached hereto is a list of cost estimates.

Since there is at present a contract on window replacement throughout the Statehouse building, it has been suggested by the Architect's Office that we delay in woodwork cleanup and/or varnishing and the removal of the coat hangers from the south wall (as you have suggested) until possibly next fall when all the window replacement work will be completed.

March 23, 1961

Mr. McPheters of the Architect's Office suggested to us that at that time the Executive Council could arrange for the cleaning and/or varnishing of the woodwork, any touchup work necessary, and the removal of the coat hangers from the south wall.

In our original study, we had recommended replacement of three ceiling light fixtures with six light fixtures. By your suggestions recently, the present lighting will remain intact. However, at the time the acoustical tile is applied to the ceiling the four old unused socket outlets will be removed from the ceiling.

If you have any questions on the above information or if we can be of further assistance to you, please let us know.

Sincerely yours,

James W. Bibb
Budget Director

JWB:MAG:eg

Enclosures

COST ESTIMATES

Conference-table chairs (12 @ \$140).....	\$1,680
Side chairs (10 @ \$18)	180
Swivel-arm chair	52
Swivel posture chair	45
Table, 30" x 15"	50
Fixed-bed typewriter table, 45" by 30"	165
Cost of shelving	20
Tile ceiling and upper walls	200 ¹⁾
Walnut table, 14' by 40" with ten drawers (to be built by the State Reformatory)	200
Convecter-type heating unit.	<u>250</u>
Total	<u>\$2,842</u>

1) Ceiling only, \$85.

CHART II (REVISED)
 PROPOSED FLOOR PLAN LAYOUT

Senate Ways and Means
 Committee Room
 3rd floor, Statehouse

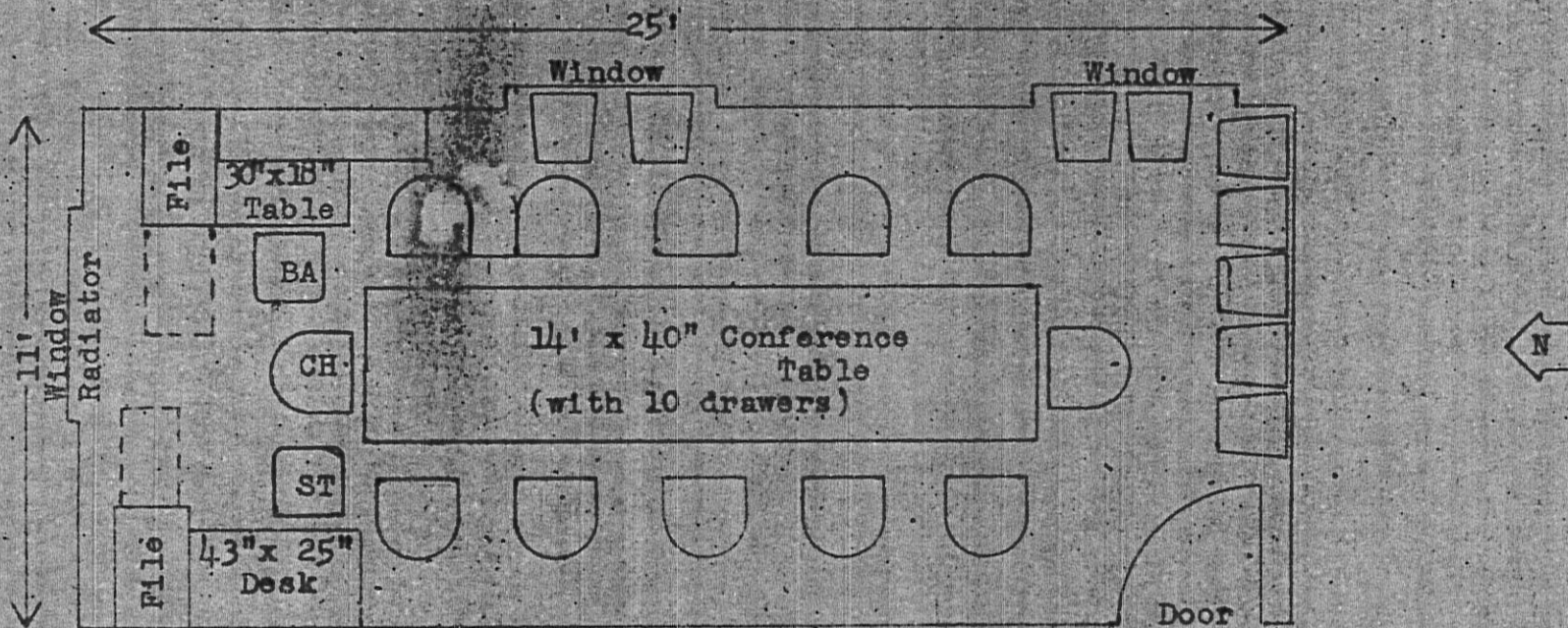

CH: Chairman
 BA: Budget Analyst
 ST: Stenographer

Scale: $\frac{1}{4}'' = 1 \text{ ft.}$
 (3-23-61)

DETAIL

WALNUT CONFERENCE TABLE

Senate Ways and Means Committee Room

TOP VIEW

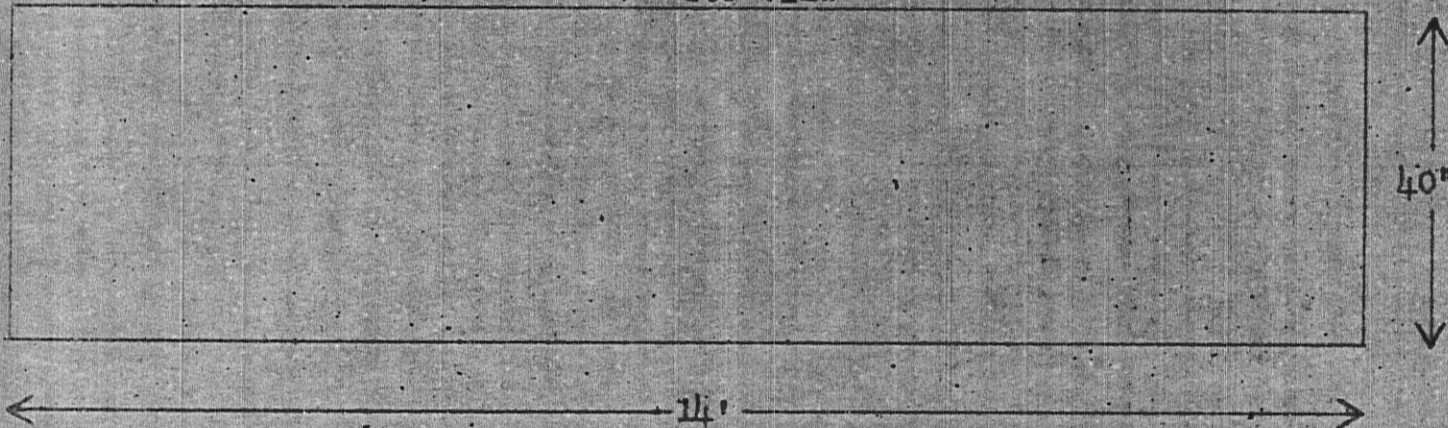

SIDE VIEW

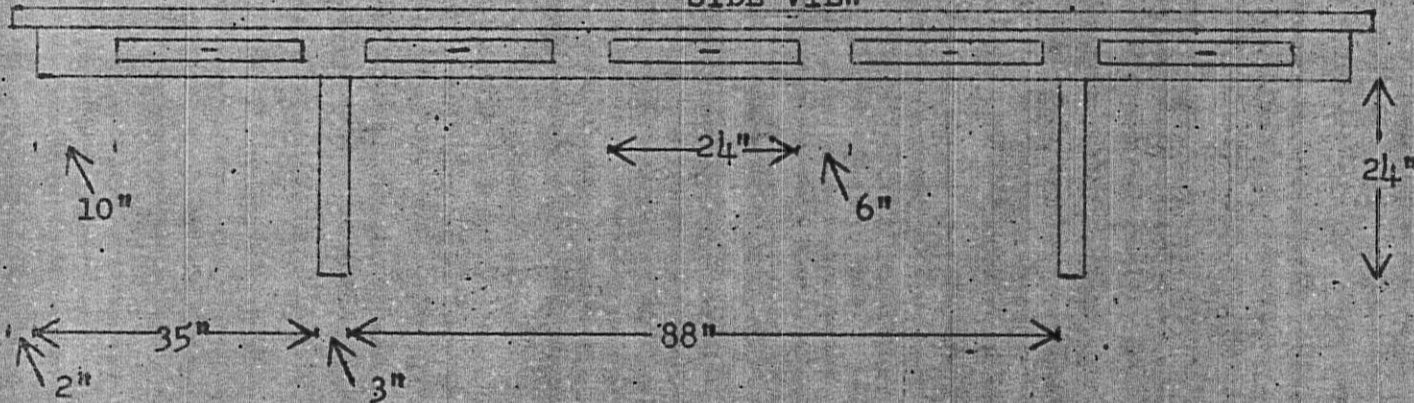

END VIEW

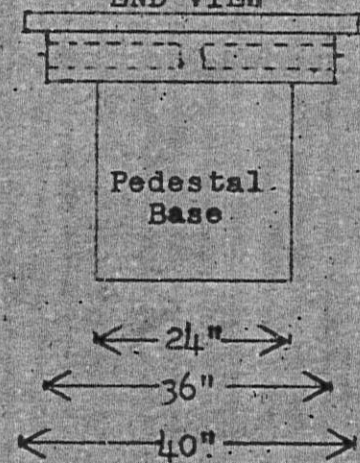

10 drawers, 5 to each long side of table;
drawer size: 24" x 17" x 3 1/2"

SCALE: 1/8" = 1'
(Approximate)