

Capital Improvement Summary

Kansas State University

October 2016

Attachment 18
Joint Committee on State Building
Construction
Date 10-4-16

Attachment 18
Campu Joint Committee on State Building
Construction
Date 10-4-16

e-8/

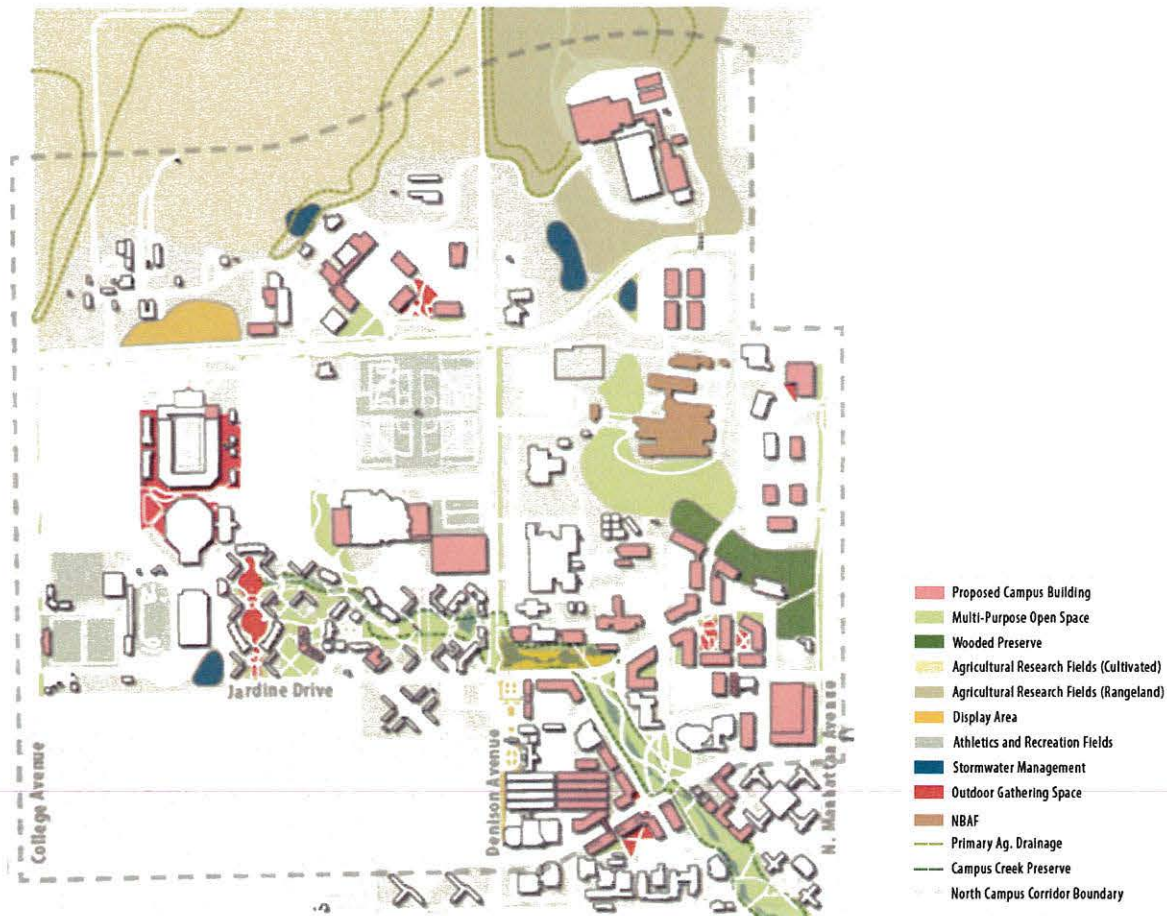

North Campus Corridor Master Plan - Overlay





2012 Master Plan

Manhattan

CAMPUS MASTER PLAN (CORE CAMPUS)

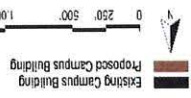

0 250' 500' 1,000' 1,500'

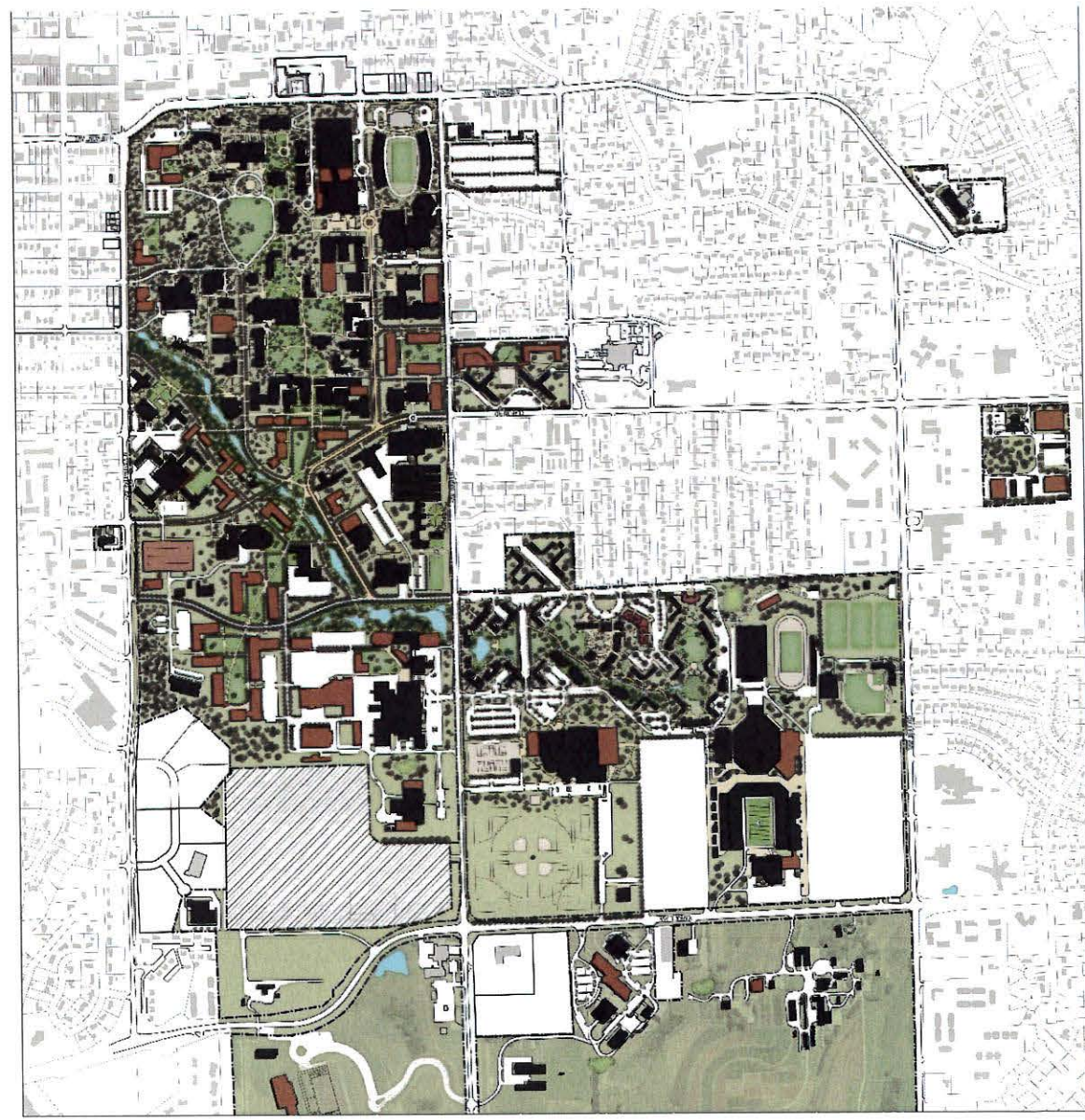

Salina Campus

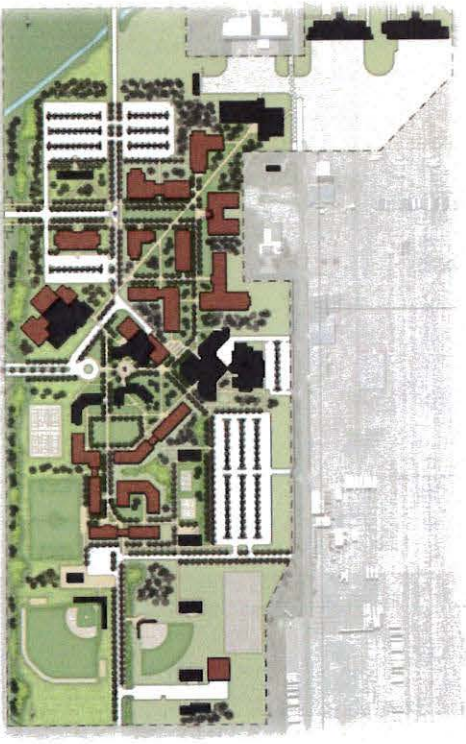

18-3

18-4

- Planned demolition of 42,500 SF
- Planned addition of 110,700 SF
- Renovate 80,180 SF
- Project Cost: \$75,000,000
- Partial renovations in 1955, 1960, 1962, 1966, 2000, 2005
- In Construction Phase

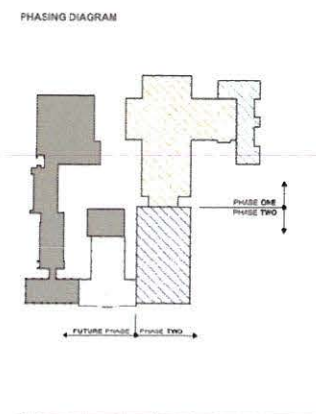
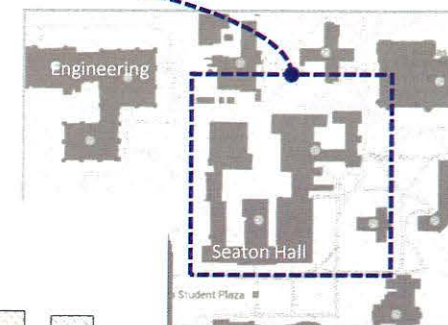

East Seaton Hall Renovations & Addition



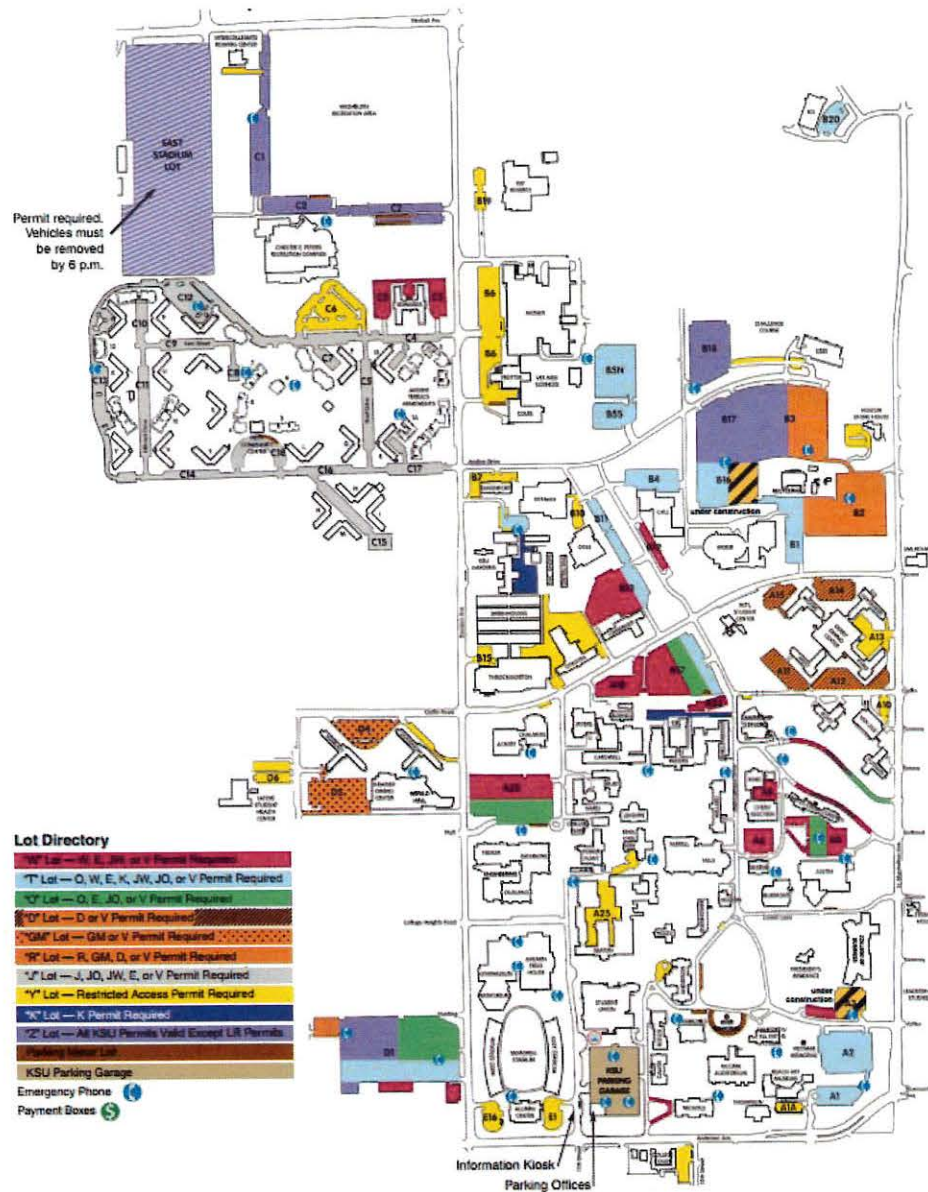

- Estimated project cost: \$800,000 per year
- Funds are for maintenance, repair and replacement of existing paved surfaces
- KSU-Salina improvements of \$50,000 per year are included

5-81

Parking Lot Improvement



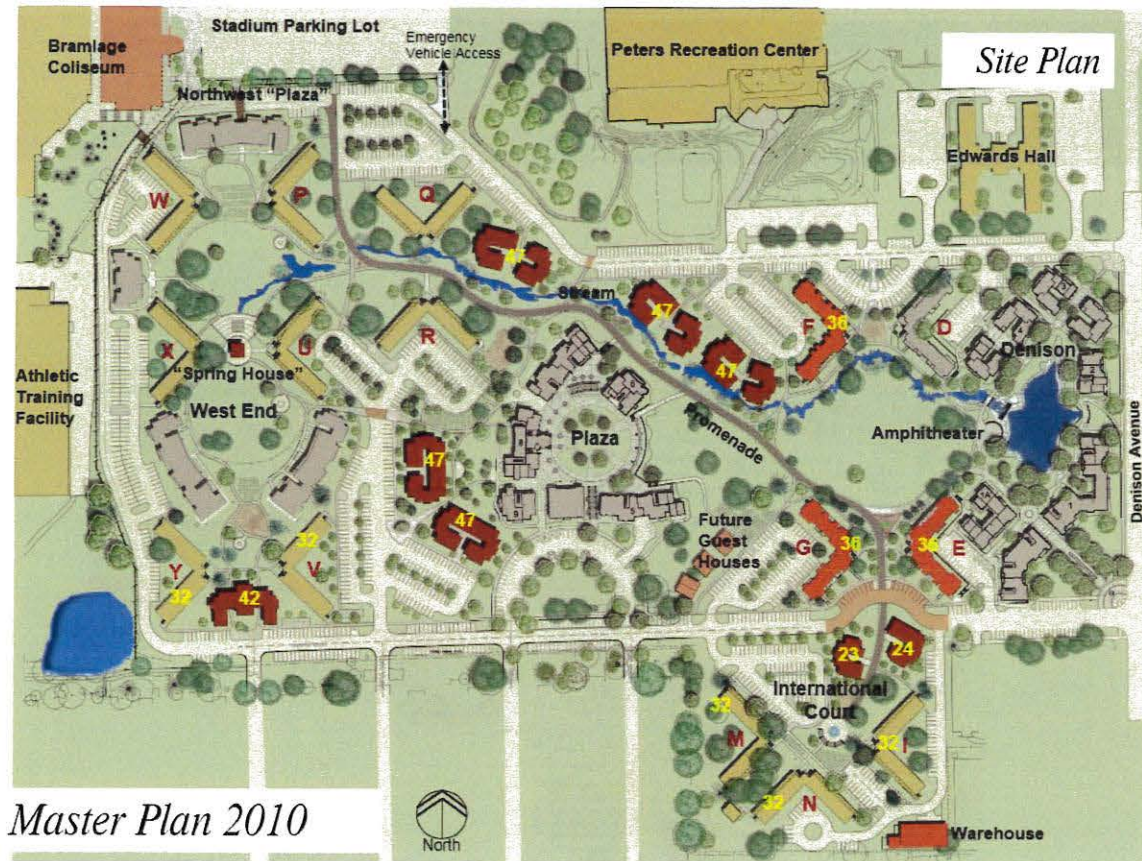

- Original complex built between 1957 & 1963
- Estimated project cost: \$102,000,000
- 17 new apartment buildings were constructed
- 5 original buildings were razed
- 11 existing buildings will receive minor renovations over the next 11 years
- Improvements include new roofs, fire alarms, & repairs to plumbing & electrical systems.

9-8-18-6



Jardine Residence Hall Complex Renovations





- Project cost: \$55,000,000
- 155,000 SF building
- Houses the College of Business
- Part of the 2025 Initiative
- Vacates space in Calvin hall for reallocation
- Occupancy Aug 2016

18-7

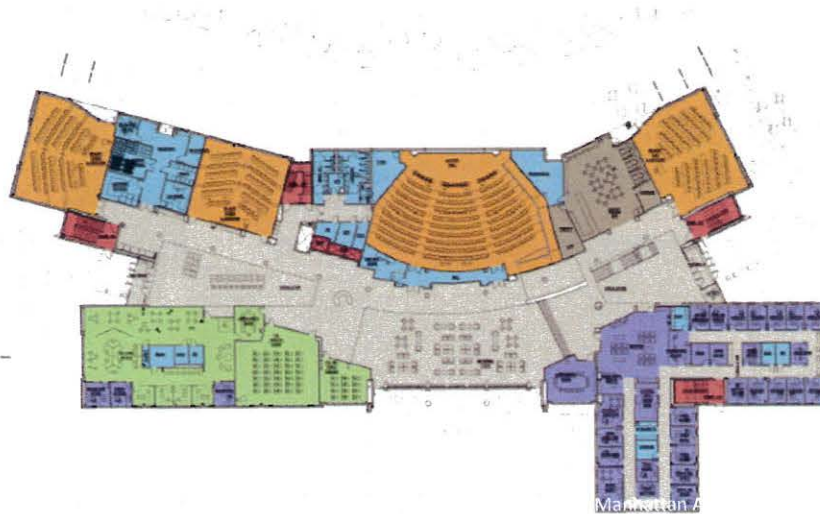

College of Business Building





- Project cost: \$76,000,000
- 187,000 SF building
- The residence hall will house 540 students
- Allows first and second year students to reside close to the core campus and ease overcrowding in Jardine Apartments
- Occupancy Aug 2016
- Remaining Work: Marlatt & Goodnow connections

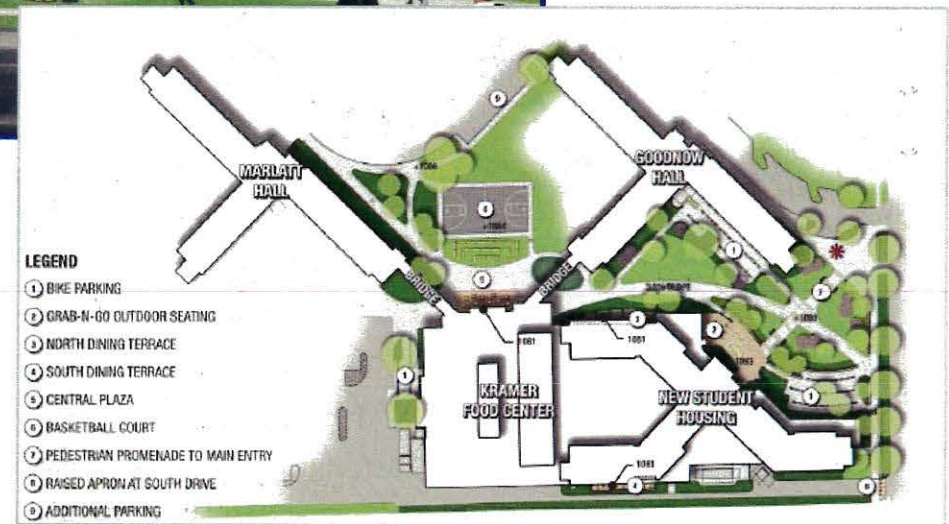

Jon Wefald Residence Hall & Dining Center





- Part of 2025 initiative
- Expands the heating and cooling infrastructure for existing buildings while preparing for the expected growth on campus
- Project cost: \$56,000,000
- Includes new chiller plant located next to KSU Recycling Center
- Final phases of site work in progress

18-9

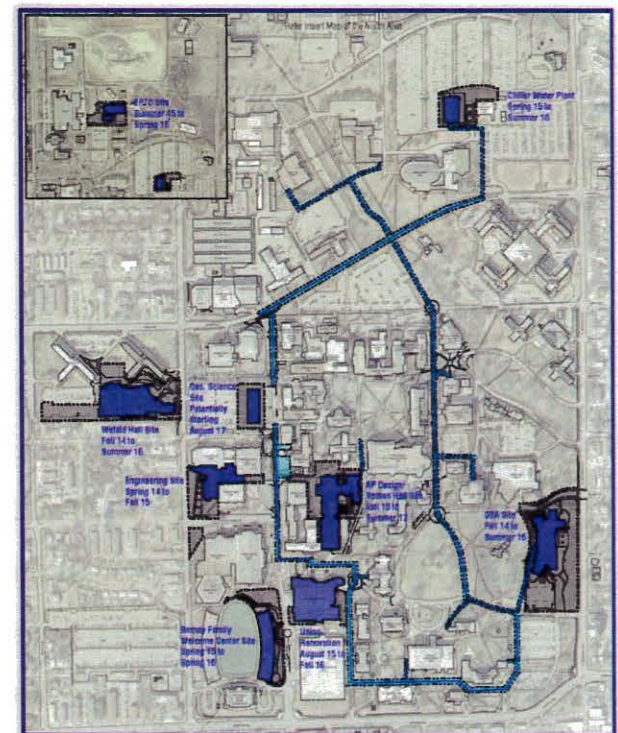
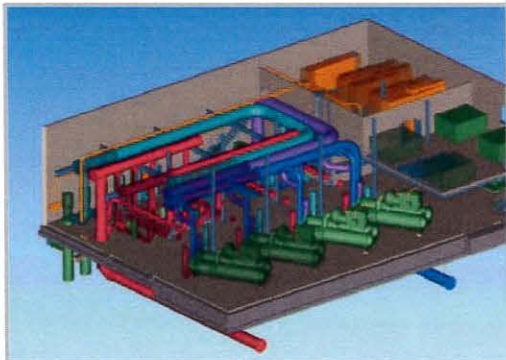

Chilled Water Plant & Campus Distribution Infrastructure Loop



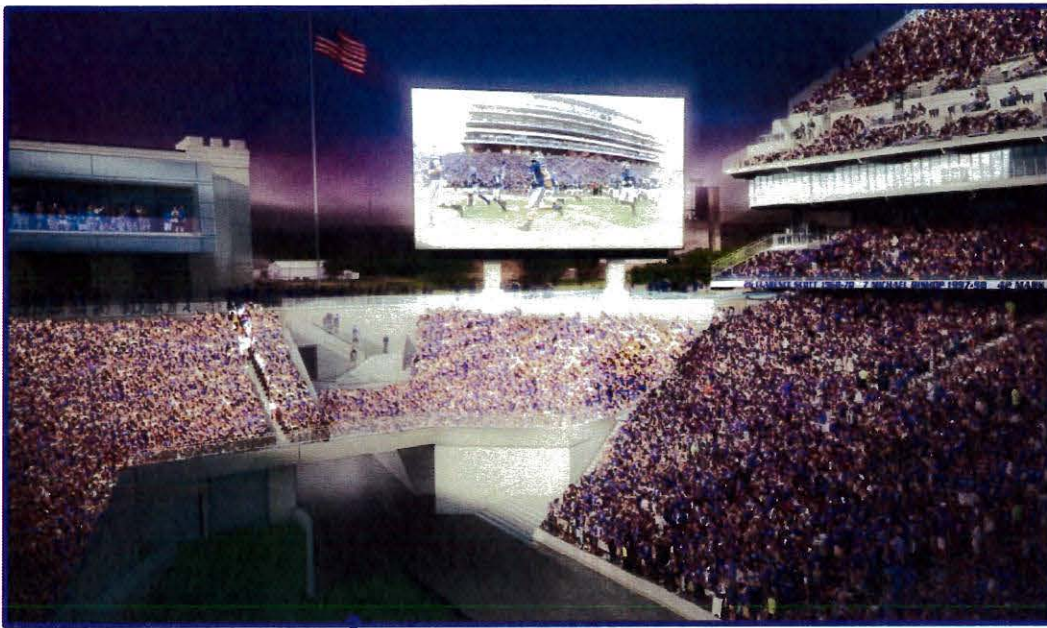

- Estimated project cost: \$13,000,000
- Reconfigures the northeast corner to provide 360 degree circulation
- Provides new visitor locker rooms, official locker rooms and additional restrooms
- Addition is expected to total 19,150 SF
- Funded from private gifts & athletics revenue
- Completed Fall 2016

18-10

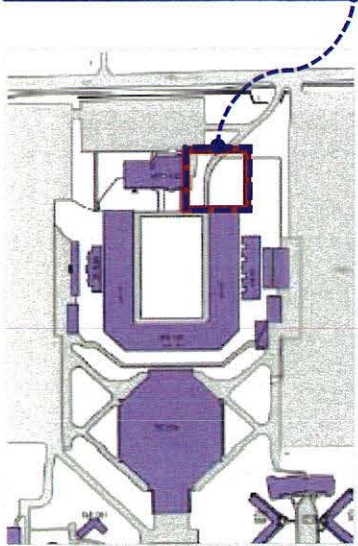

Northeast Connector – Bill Snyder Family Stadium Master Plan Ph III



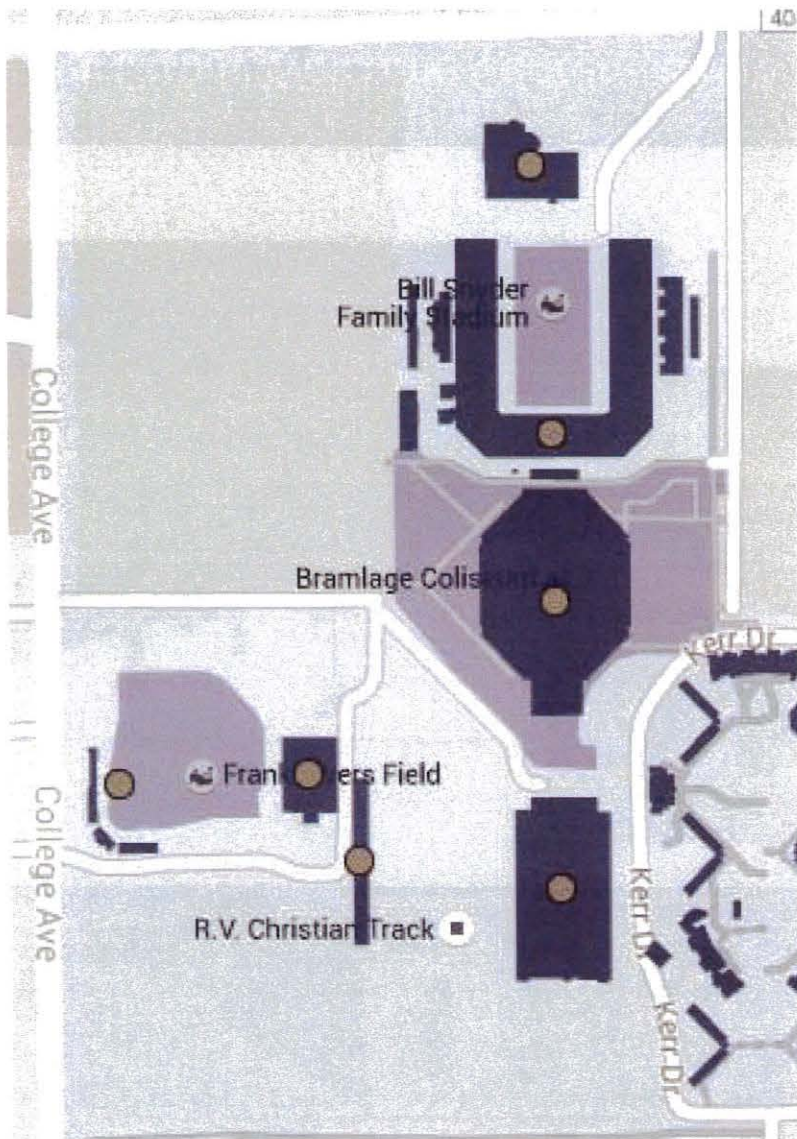

- Provides upgrades to video boards and sound systems at major KSU athletic venues
- Estimated project cost: \$12,000,000
- Funded from private gifts & athletics revenue

11-81



Video – Sound System Upgrades





- Project Cost: \$18,000,000
- Renovation of 34,700 SF
- Built in 1922
- Creation of the Welcome Center will provide a central location for enrollment services, registrar's office, & career and employment services
- 100% privately funded
- Occupancy May 2016

21.81

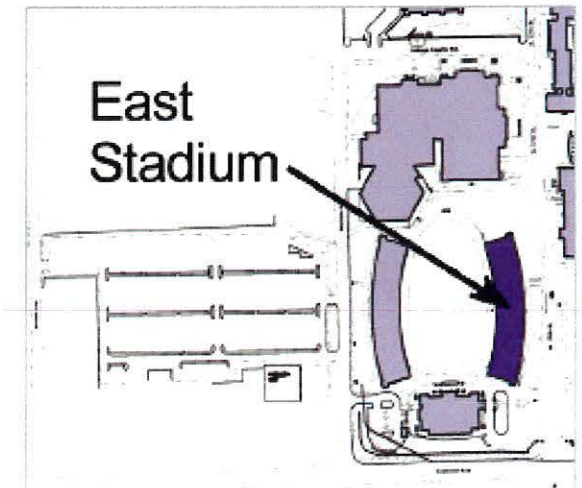
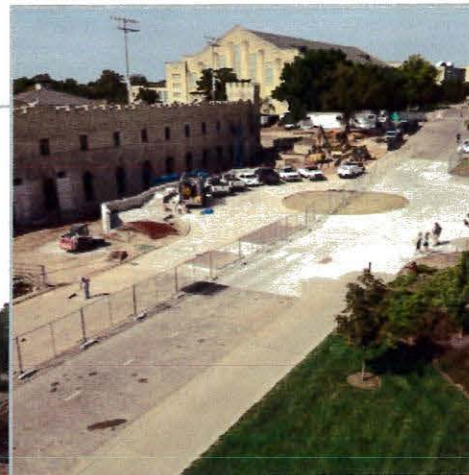

Berney Family Welcome Center – East Memorial Stadium Renovation





- Built in 1962
- Project cost: \$5,258,800
- 66,946 SF building
- Project includes improvements to the HVAC, lighting, and plumbing system, as well as the fire sprinkler, fire alarm system, and code upgrades.
- Occupancy Aug 2016

18-13

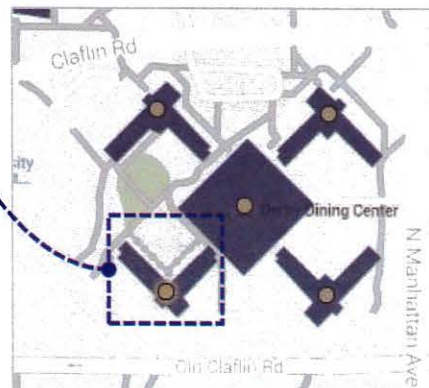

West Residence Hall Mechanical Renovation



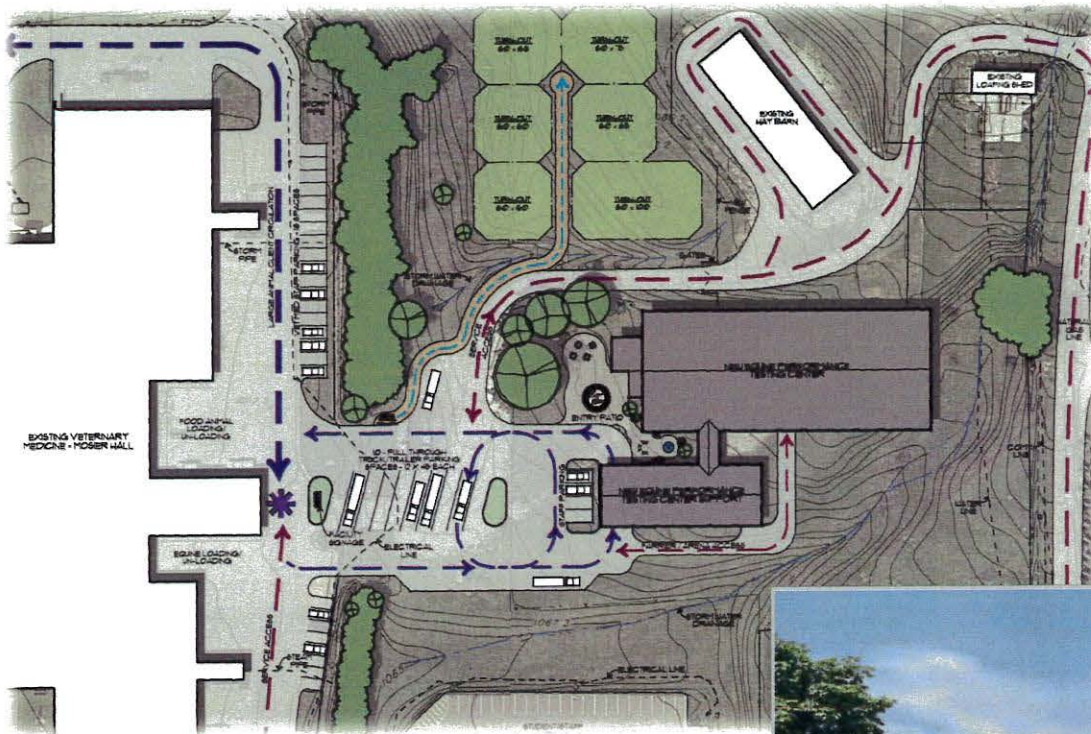

- Project Cost: \$2,800,000
- 25,400 SF Facility
- Includes arena, round pen, straight run-way, diagnostic/exam areas, holding stalls, farrier area
- Also planned are consultation & conference rooms for students, faculty & clients
- Currently in construction

18-14



Equine Performance Testing Facility





- Estimated project cost: \$5,200,000
- Facilities will include pens, fencing watering system, & utilities systems
- Currently in construction phase



Purebred Beef Unit Relocation



18-15

18-16



- Project cost: \$25,000,000
- Original structure built in 1956, additions added in 1962 & 1970
- Student governing association has worked to develop a solution that will address the Union's structural deficiencies as well as the needs of a growing student body.
- Funded by student privilege fees
- In Construction Phase
- Estimated completion Spring 2017

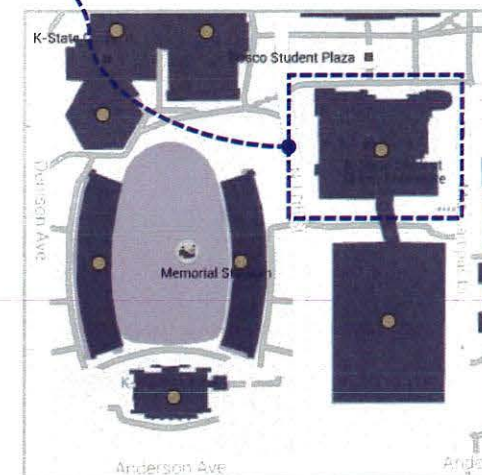

K-State Student Union Expansion



18-17



- Project cost: \$1,820,328
- Renovations include remodeling the lobby area, reconfigure space to improve circulation, provide accessible admissions counter and ADA updates to adjacent restrooms
- Updates will also include new flooring, paint, ceilings, & furniture



Mosier Hall Small Animal Clinic Renovations





- Estimated Project cost: \$2,020,000
- Renovations include replacing existing freezer roofing, insulation, lighting, equipment, sliding doors, and fire alarm system.
- Updates will also include adding an exit door and additional ventilation.
- Project funding: Housing and Dining auxiliary funds.

18-18



Pittman Freezer Repairs



18-19

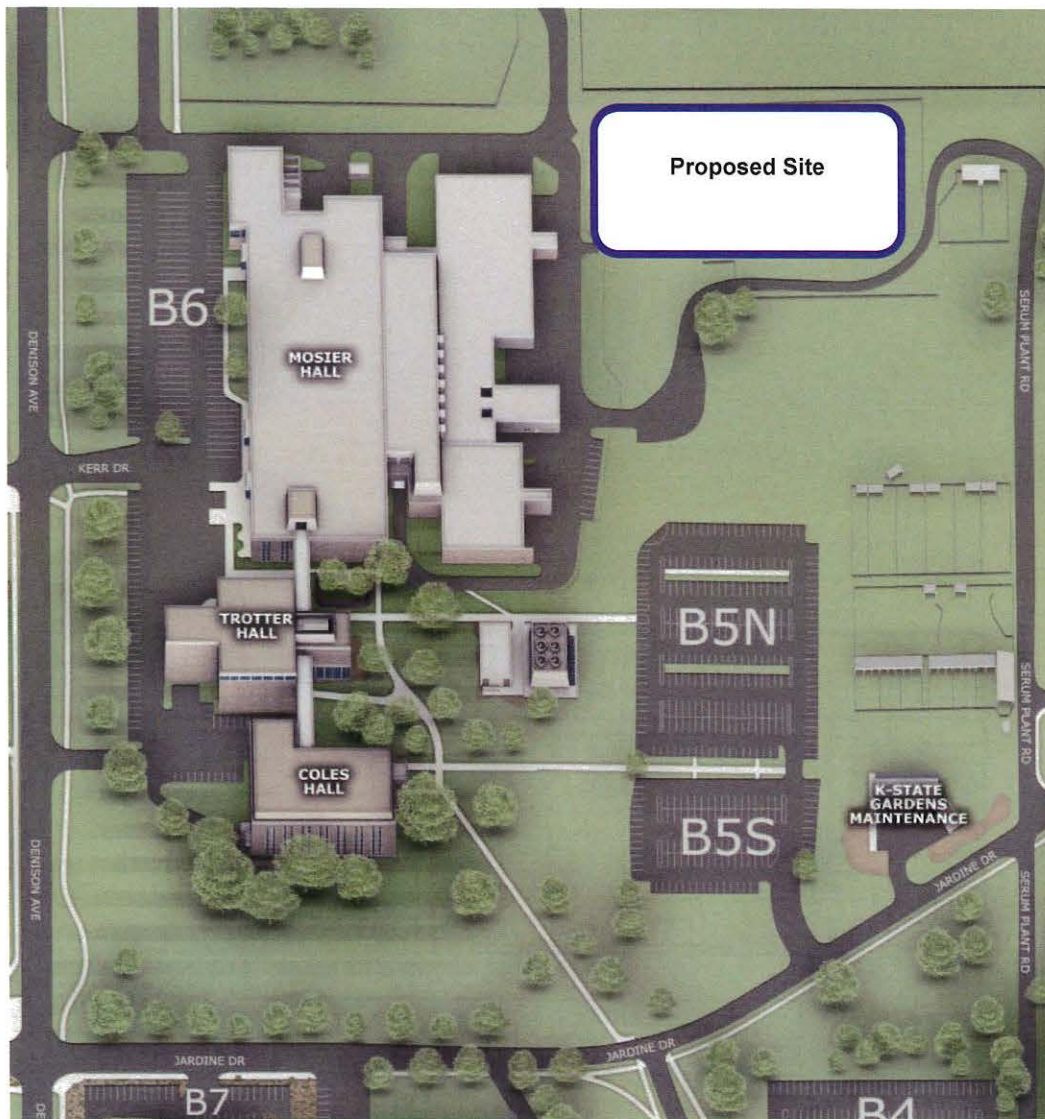

- Estimated project cost: \$43,200,000
- Project entails the construction of a multipurpose 80,833 gross square foot facility to include diagnostic and research labs, offices, and support facilities.
- Major functional areas include bacteriology, clinical pathology, histopathology, molecular diagnostics, necropsy, rabies/wildlife, research, serology and virology.
- It is anticipated that these project will be funded through bonds with debt service repayment from College of Veterinary Medicine funding resources and Veterinary Diagnostic Lab service fees revenue.
- Program complete and approved by BOR.

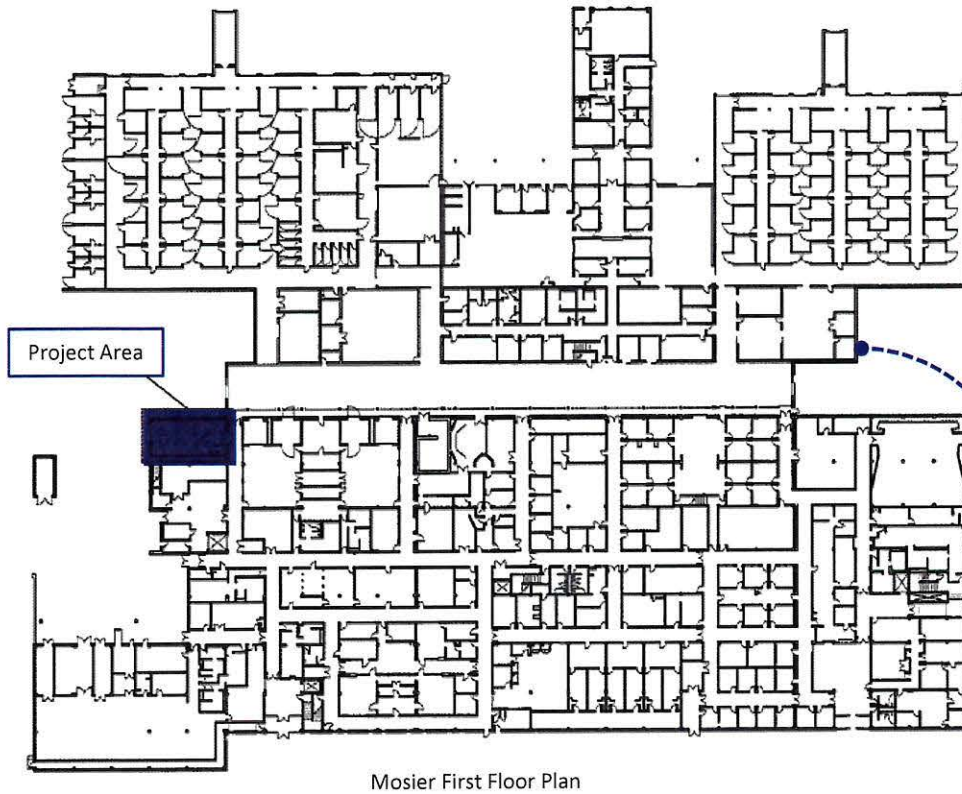

- Estimated project cost: \$2,620,572
- This project includes remodeling an existing portion of Mosier Hall to meet the regulations required for the MRI unit.
- Renovations include adding a table sized for large animals and a metal scanner.
- This project will be funded with Veterinary Health Center Revenue.

06-81

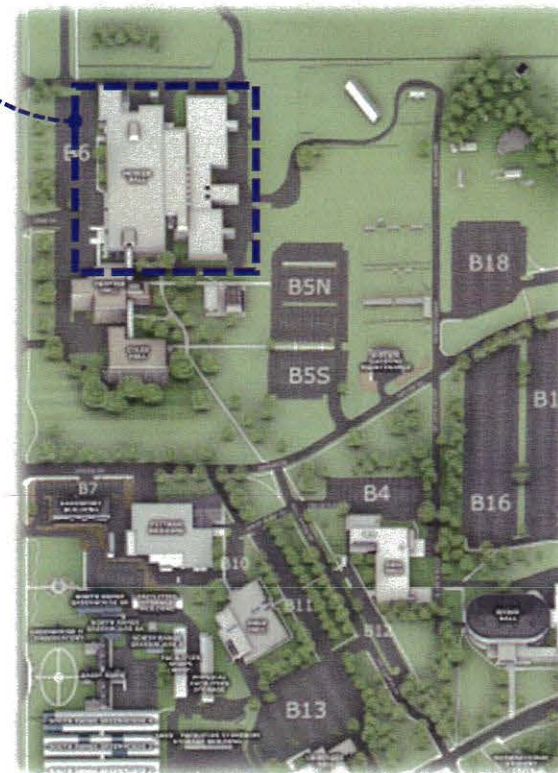

Mosier Hall Magnetic Resonance Imaging Enhancement



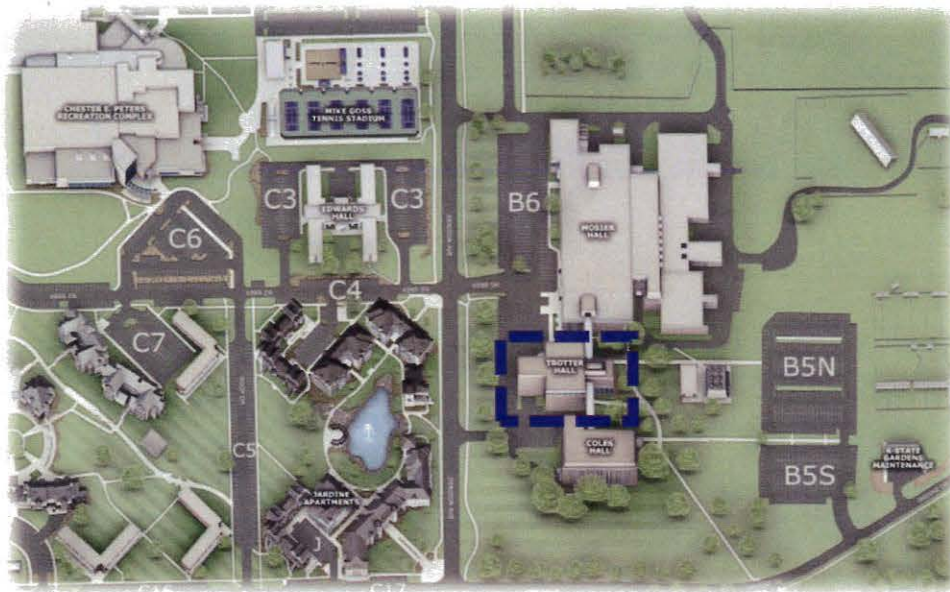

- Estimated project cost: 4,700,000
- This project includes remodeling the existing third floor of Trotter Hall in order to enhance the educational culture with new gross anatomy labs, microanatomy lab, student study space, student shower/restroom areas, prep space, coolers, and storage and display for anatomical models, teaching specimens and other curated items.
- Renovations will also include upgrades to the mechanical, ventilation, plumbing and electrical systems.
- This project will be funded with College of Veterinary Medicine funding resources.

18-21



Trotter 3rd Floor Veterinary Anatomy Lab Renovation



18-281

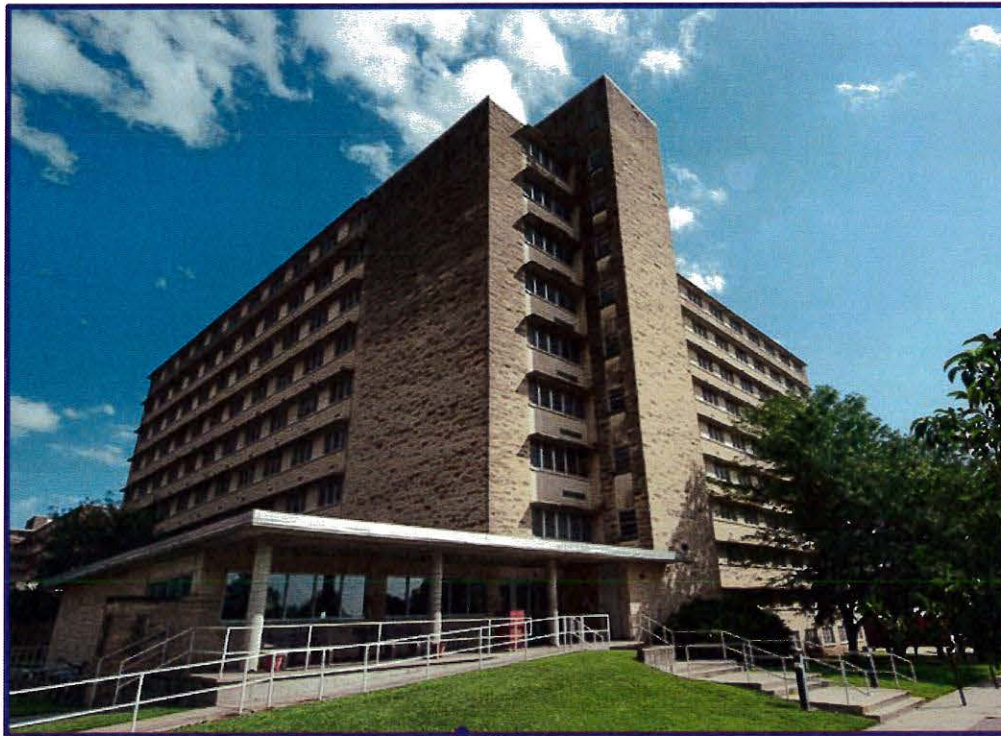

- Estimated project cost: \$1,500,00
- Built in 1965
- Project proposes to remove the sprayed on asbestos on the ceiling, install a new fire alarm system, & install new light fixtures.
- Building contains 125,132 SF

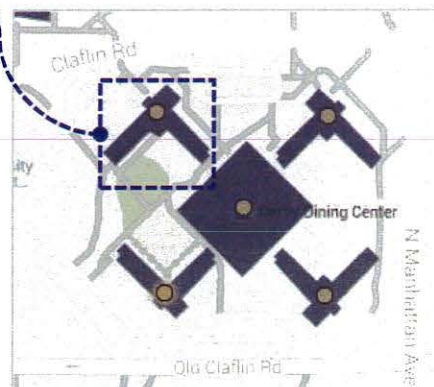

Moore Residence Hall Lighting and Fire Alarm



18-23

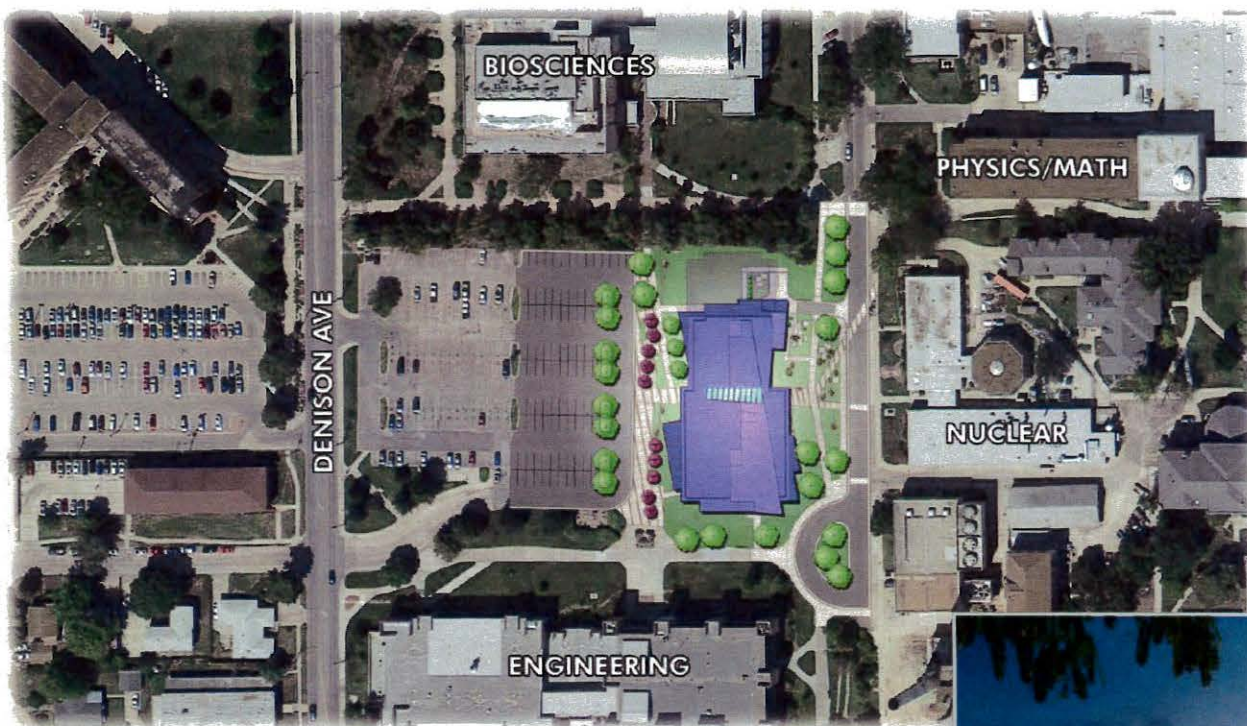

- Estimated project cost: \$45,100,000
- Planned construction: 78,000 SF
- Proposed to house Department of Geology
- Support for STEM fields of multidisciplinary study
- Part of the 2025 Initiative
- Located per KSU Master Plan
- Program Approved November 2014



Geosciences Building



18-24

- Estimated project cost: \$150,000,000
- New food systems research and education facility
- Includes lab space, greenhouses, extension and distance education space, & classrooms
- Project is anticipated to be bonded with funding split between state funds, private gifts, & federal funds
- Program is completed

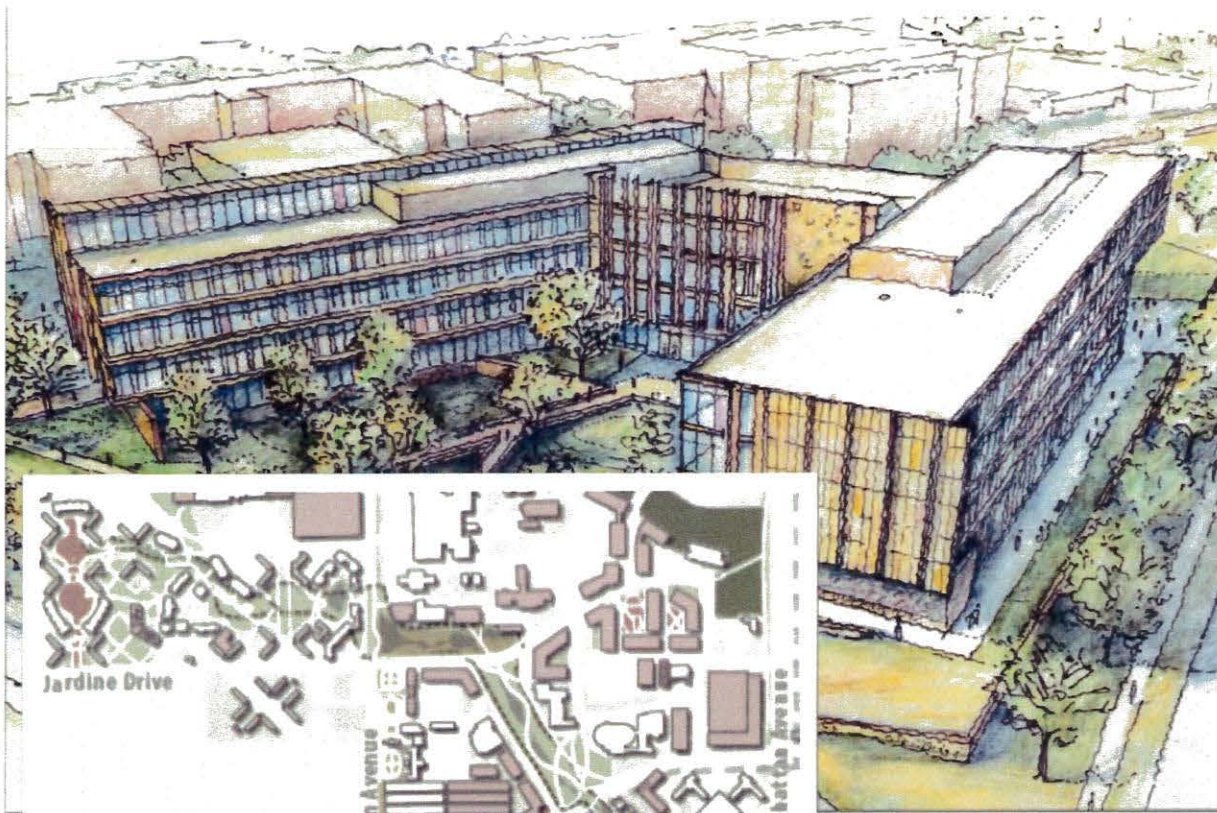

Proposed Site

Agriculture Research & Extension Facility

(New Food Systems Research and Education Facility)



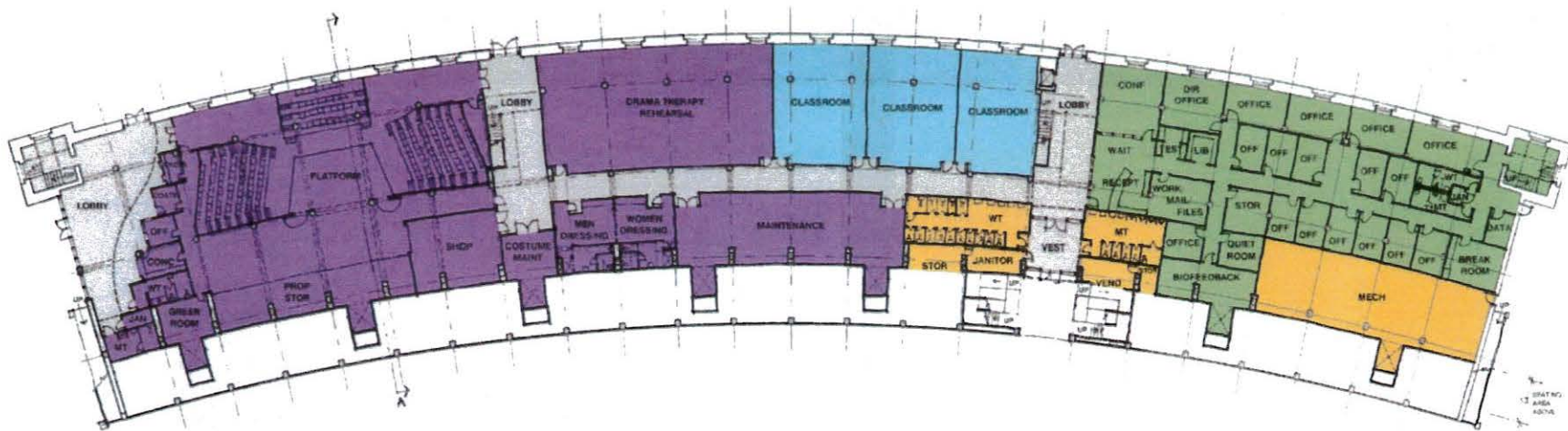

Phase Floor Plan – Phase I (complete), Phase II Yellow/Blue, Phase III Green

Phase II

- Estimated project cost: \$3,500,000
- Phase II provides general use classrooms and the addition of public restrooms and storage spaces
- Includes installation of an ADA compliant elevator

Phase III

- Estimated project cost: \$3,750,000
- Phase III provides office space that can be used for flex space
- Creation of flex space will allow future renovations to proceed at a quicker pace and more economical costs

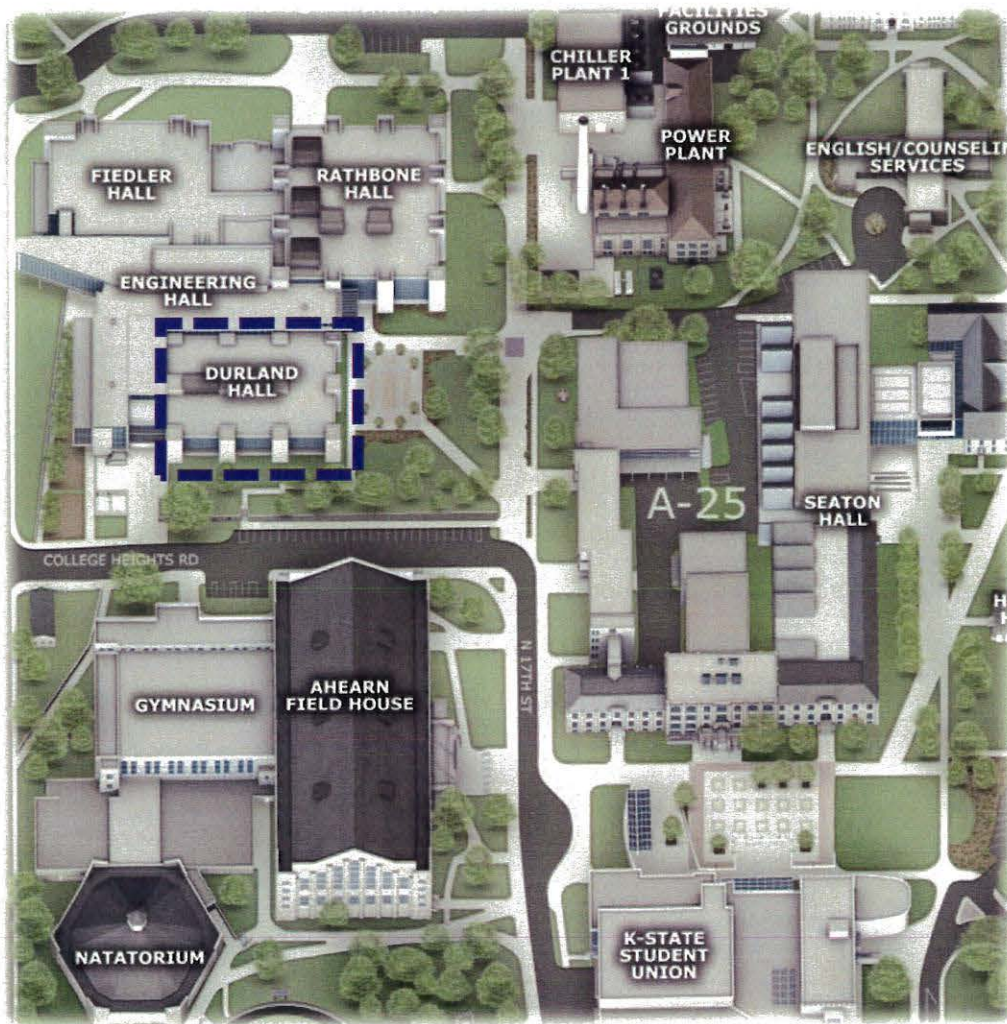

- Estimated Project cost: \$1,500,000
- Renovates existing laboratory space on the second floor of the Durland wing of the Durland Hall engineering complex.
- Updates will also include adding an exit door and additional ventilation.
- This project anticipated to be funded from private gifts.
- Fundraising Phase

92.8/
18.26

Durland – 2nd Floor Remodel



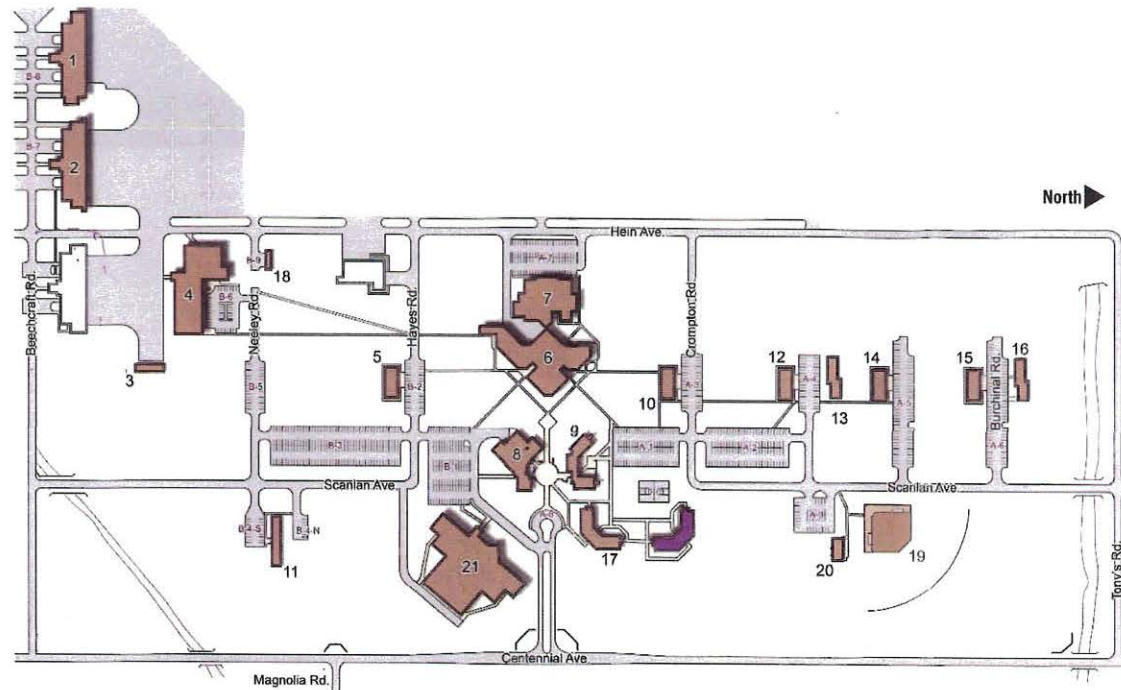

- | | | |
|-----------------------------------|--|--|
| 1 - Aeronautical West Hanger #703 | 8 - College Center #710 | 15 - Facilities Maintenance - Shops #717 |
| 2 - Aeronautical East Hanger #704 | 9 - Residence Hall #711 | 16 - Facilities Maintenance - Offices #718 |
| 3 - Avionics Lab #705 | 10 - Tullis Building #712 | 17 - Harbin Hall #719 |
| 4 - Aeronautical Center #706 | 11 - Technology Assistance Center #713 | 18 - Building Eight Twenty #720 |
| 5 - U.A.S. Laboratory #708 | 12 - Student Activities Center #714 | 19 - Thaemert Park/Sports Field |
| 6 - Technology Center #709 | 13 - Science Center #715 | 20 - Sports Support Facility #721 |
| 7 - Technology Center West #709 | 14 - Construction Lab #716 | 21 - Student Life Center #722 |

- Estimated project cost: \$6,000,000
- 1,400 SF apartment complex
- Complex to provide alternative housing solution for married and non-traditional students
- Includes a mix of 1, 2, & 3 bedroom apartments

KSU Polytechnic Apartment Complex





- Estimated project cost: \$2,028,000
- 8,700 SF Agronomy education center
- Located adjacent to the Ag Research Center on Kimball Ave
- Funding from private gifts/donations
- Currently in fundraising stage

86-81

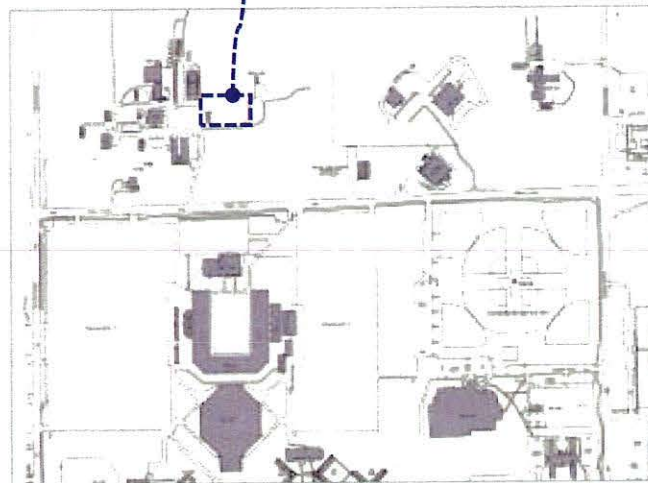

Agronomy Education Center





**Proposed KSU
Foundation Site**

- Building will serve as the on campus center for multi-cultural student activity
- Estimated project cost: \$17,000,000
- Building currently contains multi-purpose meeting space, conference rooms, office space, & media resource rooms
- Includes a reflection space for all faiths
- 100% Privately funded
- Currently in fundraising phase

18-29

Multi-cultural Student Center





- Estimated project cost: \$2,000,000
- Justin Hall was built in 1960
- Sensory Analysis Center will relocate from Justin Hall to Ice Hall
- 5,500 SF of space in Justin Hall to be reallocated
- Existing kitchen labs will be remodeled to accommodate advanced research activities
- In planning phase

Justin Hall Suite Remodel





- Estimated project cost: \$3,111,800
- Weather conditions, use & time have caused significant damage to the runway & aprons
- These conditions are now to the stage where there are areas that are unsafe to operate aircrafts
- Also included in this project are the replacement of the hanger doors
- In programming

13-8/18-31

KSU Polytechnic Runway Improvements





1832

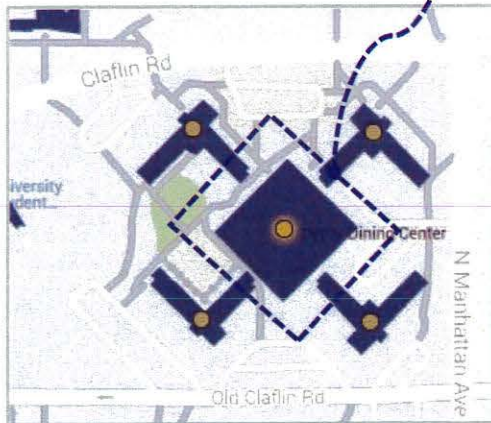

- Estimated project cost: \$34,000,000
- Built in two phases in 1965 & 1966
- 97,567 SF building
- Improvements will include a new kitchen, dining platforms, seating areas, HVAC, & fire & life safety system
- Project will bring the building up to current building, ADA, & energy codes
- In Programming Phase

Derby Dining Service Renovation





- Part of Housing and Dining Master Plan
- New residence hall is intended to house about 600 students
- Funded through housing

New Derby Community 600 Bed Residence Hall



18-33

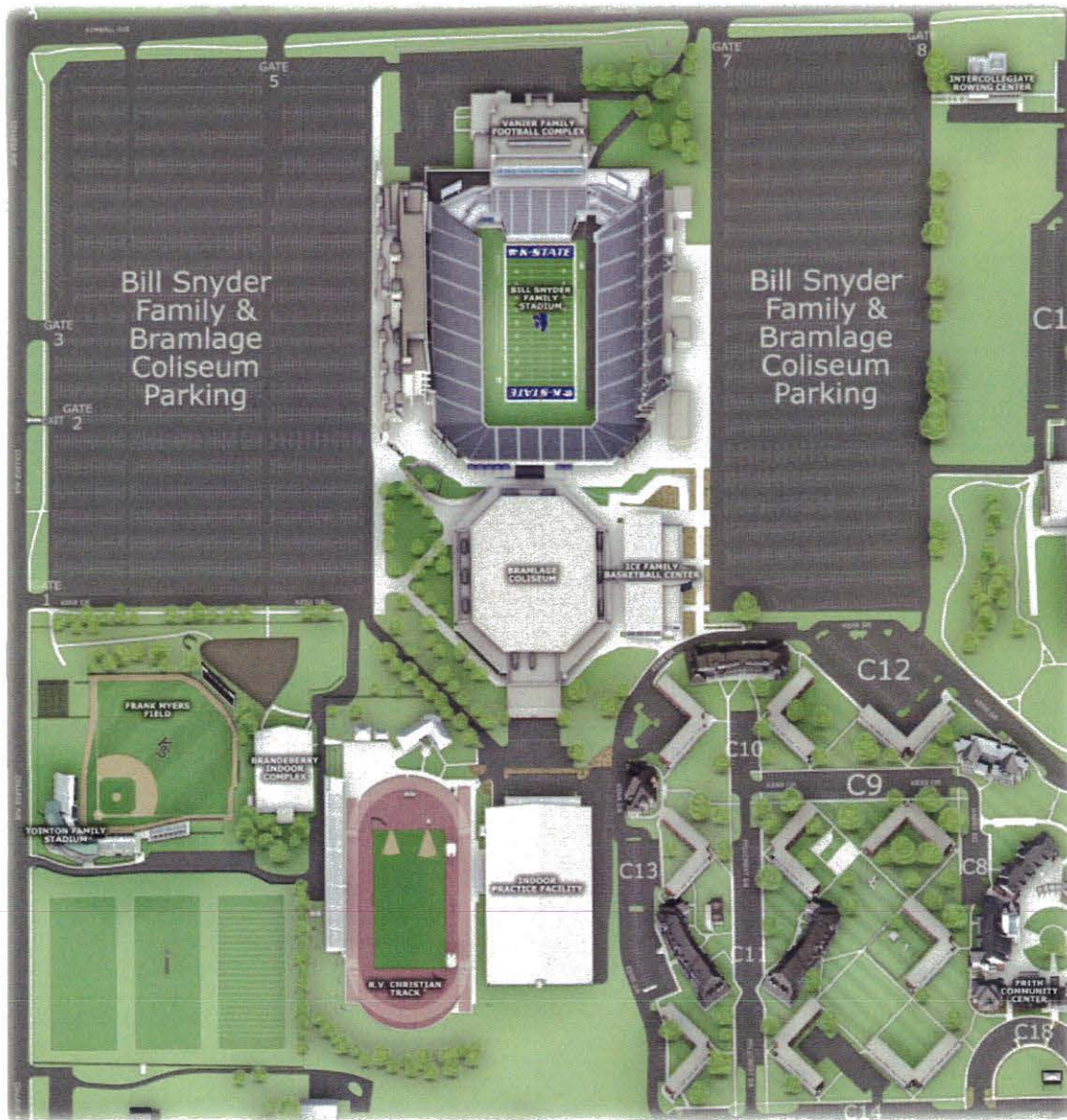

- Estimated project cost: \$8,500,000
- Project includes a 19,000 square foot facility that includes locker rooms, offices, and other support spaces.
- The project is proposed to be funded from private gifts and Athletic funds.

18-34

Soccer / Baseball Team Facility



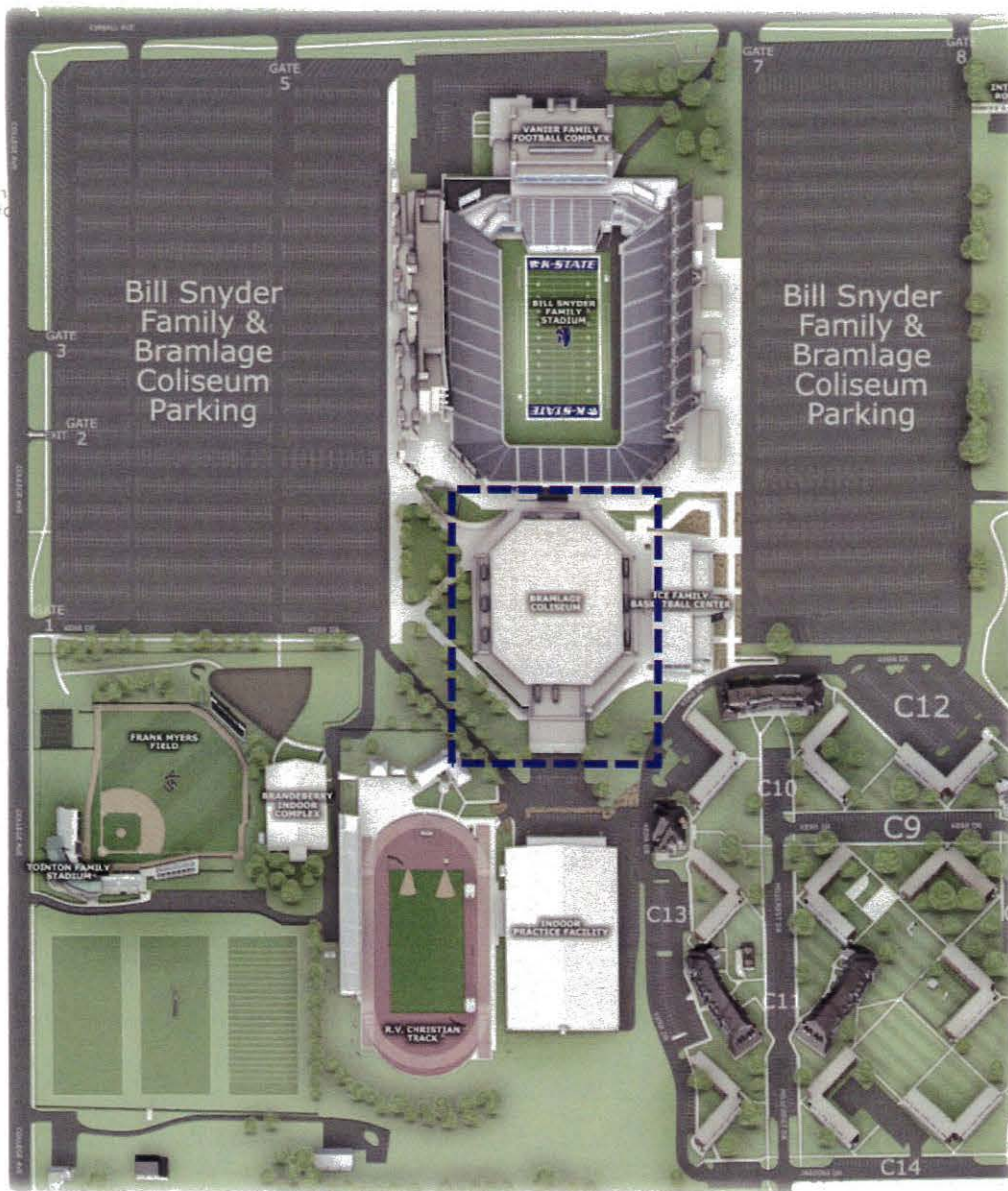

- Estimated project cost: \$3,100,000
- The roof replacement is proposed to be replaced in two phases.
- The first phase will be the roof over the level concrete deck. This includes the areas of the concourse and office area and is approximately 63,500 square feet.
- The second phase will be the sloped metal deck over the basketball arena. This roof area is approximately 90,500 square feet.
- The project is proposed to be funded from private gifts and Athletic funds.

18-35



Bramlage Roof Replacement



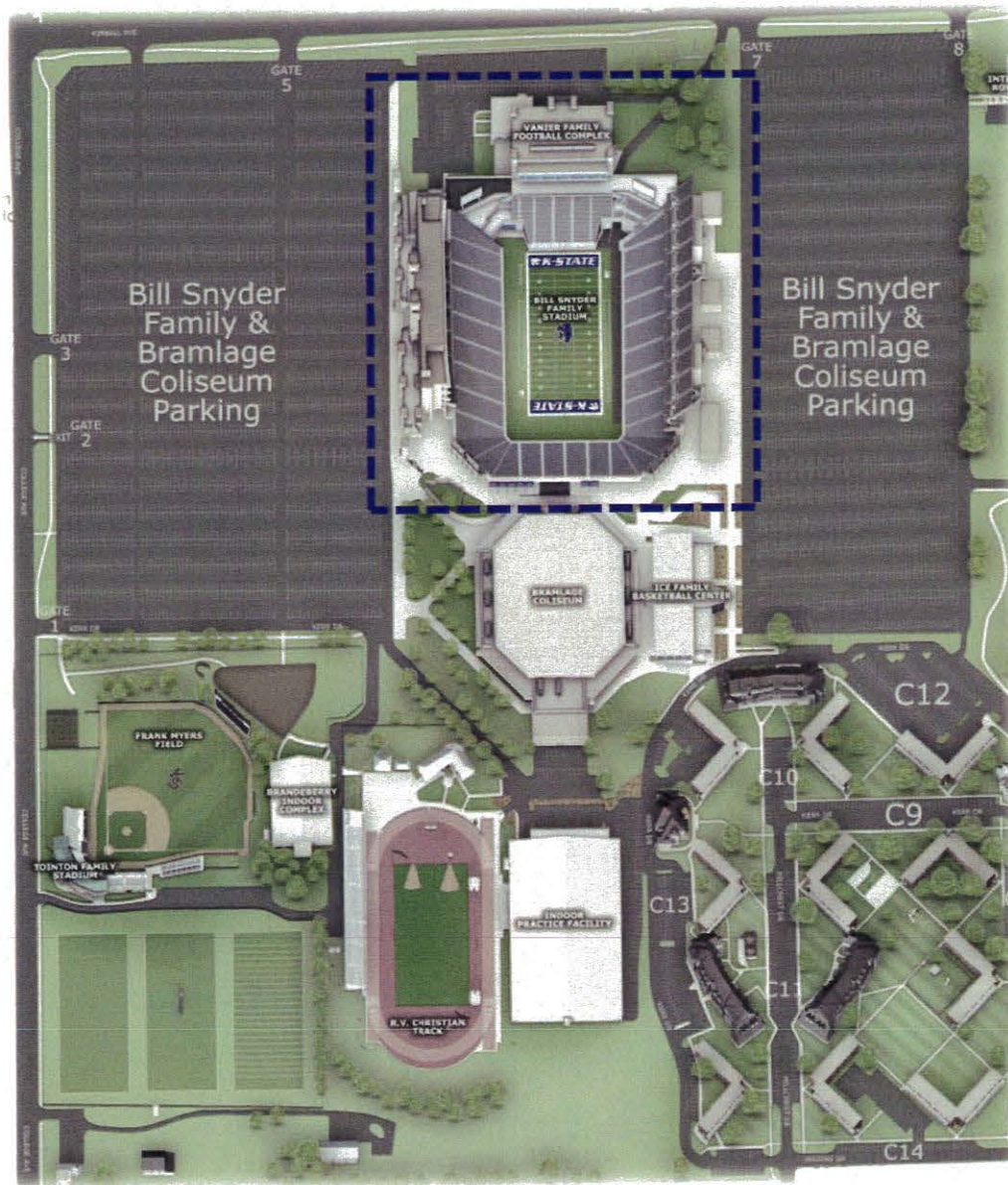

- Estimated project cost: 1,500,000
- Project includes the replacement of the football field turf and construction of a stone wall between the spectator area and the field area.
- The project is proposed to be funded from private gifts and Athletic funds.

18-36



Bill Snyder Family Stadium Field Walls and Turf Replacement



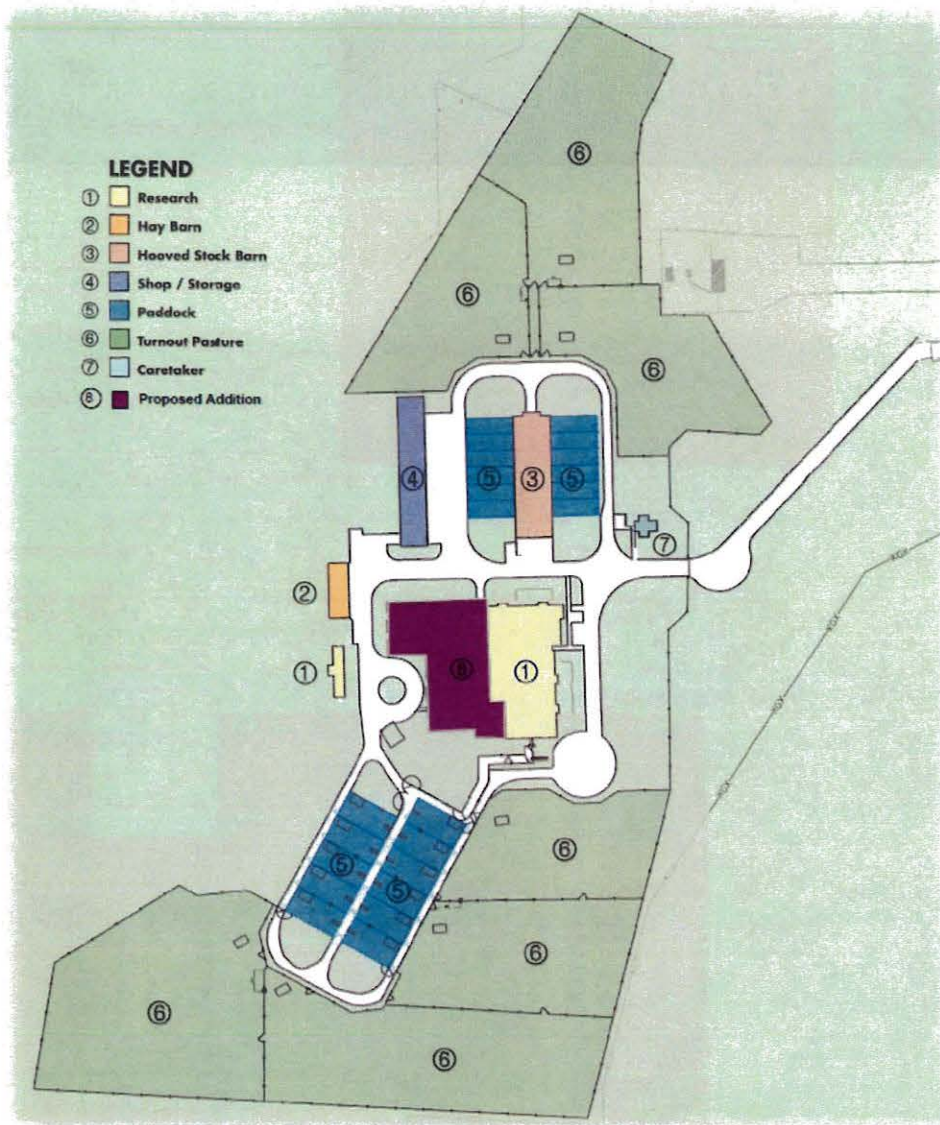

- Estimated project cost: 17,800,000
- The project consists of renovation and upgrades to the existing facility, a 28,500 square foot addition to the building which would house necropsy and surgery suites, support space and small and large animal holding rooms, a new 800 square foot facility for tick rearing and a new 1,200 square foot facility for deer holding.
- Project is funding anticipated through restricted fees.

18-30

Large Animal Research Center Expansion – PH 1 and PH 2



1838

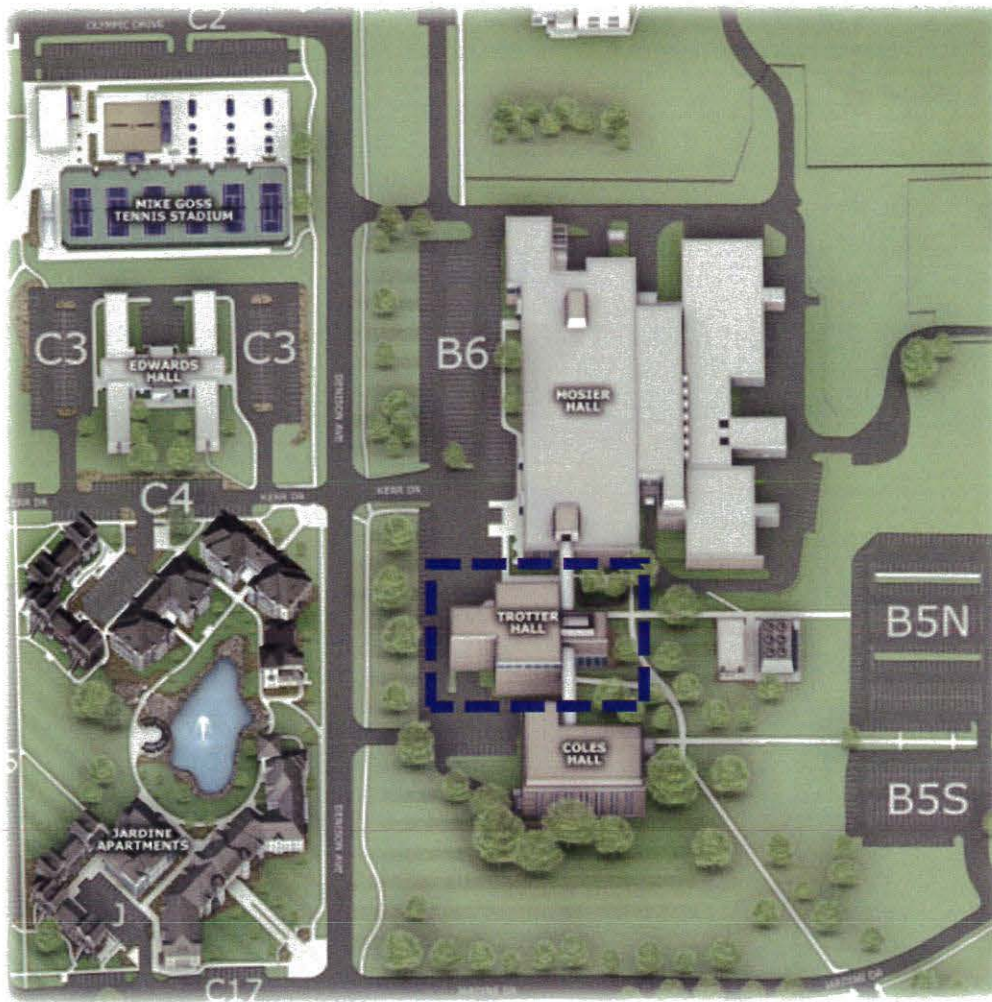

- Estimated project cost: 2,500,000
- The renovation will include the lobby on the first floor, support and office space, as well as upgrades to the mechanical, ventilation, plumbing and electrical systems.
- The anticipated square footage for remodel is approximately 7,000 square feet.
- The project will be funded with College of Veterinary Medicine funding resources.

Trotter 1st Floor Clinical Skill Lab/Lobby Renovation



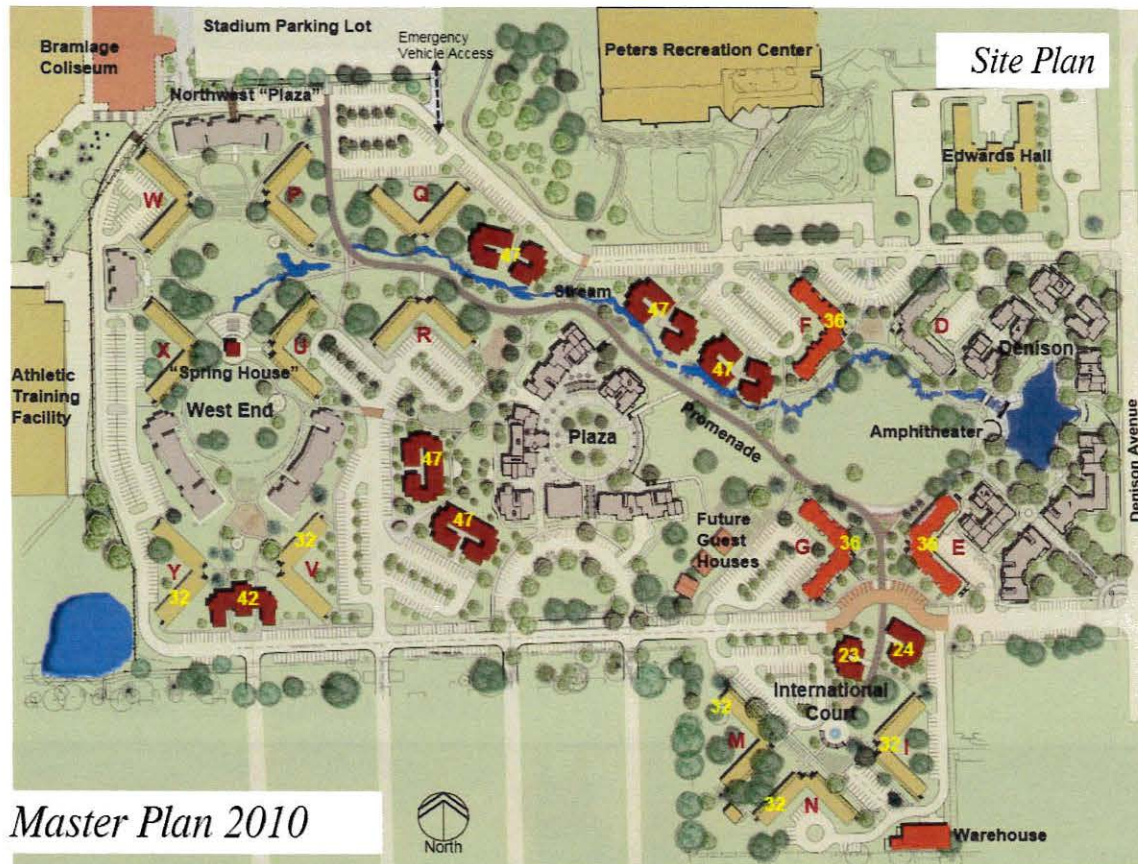

- Project cost: \$18,500,000
- New construction - 180 bed apartment building
- Will result in the removal of 2 existing buildings – S & T
- Funded from housing revenue

18-39

New Jardine Apartment/Residence Hall



18-40

- Estimated project cost: \$15,900,000
- Proposed 24,000 SF addition to the West face of McCain Auditorium
- Addition will feature a new reception space, admin offices, box office, & public restrooms
- Will alleviate circulation problems for events and provide updates to existing facility for code compliance
- Funded with private gifts – currently in fundraising phase

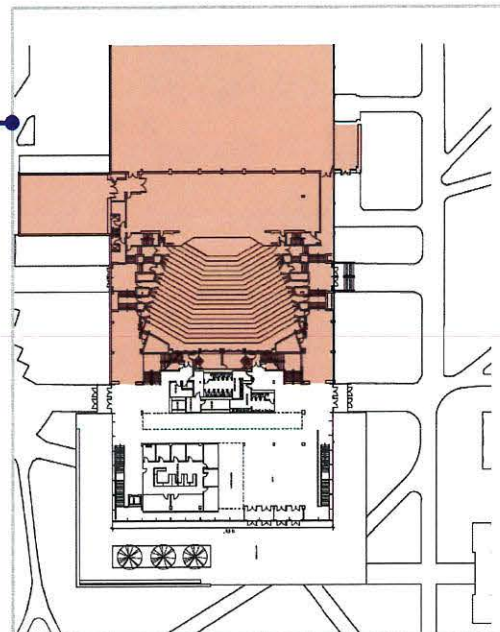
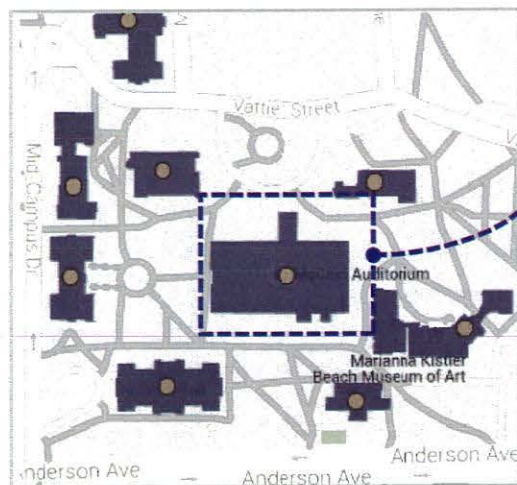

McCain Additions and Code Compliance





- Estimated project cost: \$5,500,000
- This project includes remodeling of the first floor to create a more open entry to the library and provide space that meets the student's academic and University research needs.
- Funding Source: private gifts

18-41



Hale Library 1st Floor Remodel





- Estimated project cost: \$1,180,000
- This project will replace the existing elevators with compliant accessible elevators.
- The project will be funded from housing revenues.

18-42



Boyd Elevator





- Estimated project cost: \$1,250,000
- This project will replace the existing elevators with compliant accessible elevators.
- The project will be funded from housing revenues.

18-43



Putnam Elevator

