

# MEMO



**DATE:** July 27, 2015

**TO:** Johnnie Goddard, Deputy Secretary-Facility Mgmt.

**FROM:** Rex Pryor, Warden-LCF *Rex Pryor*

**CC:** File

**RE:** East Unit Visiting Building

P.O. Box 2  
Lansing, KS 66043-0002  
(913) 727-3235  
Fax: (913) 250-2562  
[www.doc.ks.gov/facilities/lcf](http://www.doc.ks.gov/facilities/lcf)

A proposal is being submitted to build a free standing building at the East Unit at the Lansing Correctional Facility. This building will house the minimum visiting program and remove the visiting program from being on the compound. The primary reasons to justify purchasing and building this structure are as follows:

1. Currently there are multiple events that take place in Phillips Hall, which is also the visiting area, on a regular basis. These include but are not limited to: BIB classes; intramural sports activities; additional programs. During visiting hours all of these programs and activities are canceled.
2. The present location of Phillips Hall is located in the middle of the East Unit compound. This requires all visitors to enter the minimum compound and walk past one living unit to reach Phillips Hall for their visit. It is also directly across from the dining facility so inmates walk past the visiting areas while visiting is taking place. There is a security staff presence but the foot traffic is difficult to monitor.
3. The minimum compound (East Unit) is now housing a very large number of sex offenders, who could have direct access to the visitors as they walk to and from the current visiting room. The visitors could be subjected to remarks from other inmates.
4. Phillips Hall was not designed to be utilized as a visiting center; it is designed to be an activity/sports center. It has no location designed to be a secure shakedown area for processing inmates in and out of their visit. It is not conducive for optimum security due to the layout.
5. The current visitor reception area is not handicap accessible. Any visitors who have disabilities, that require handicap accessible access to the facility, have to park at the opposite end of the compound and enter through the staff handicap entrance. From this point they again have to proceed through the compound to reach Phillips Hall for their visit. Processing visitors in at this point of entry requires the control officer to be taken away from their job priorities.
6. This building would also give the facility the ability to increase some volunteer led programs. We cannot schedule these programs now, due to lack of meeting space at the facility.

26  
Attachment *[initials]*  
JCSOC 10-21-15

7. The building would allow for non-contact visiting to occur in the appropriate non-contact rooms located on the North West corner of the building. Currently the facility has to transport the offenders to the Maximum Security Visiting Room located at the Central Unit.

Listed are a number of safety and security related issues that are dealt with every time visiting occurs at the minimum compound. A new visiting facility located outside the compound would eliminate these issues/concerns and make the visiting operation a much safer and more efficient operation. This would also improve the overall quality of the visiting experience which would have a positive impact on the facility in general.

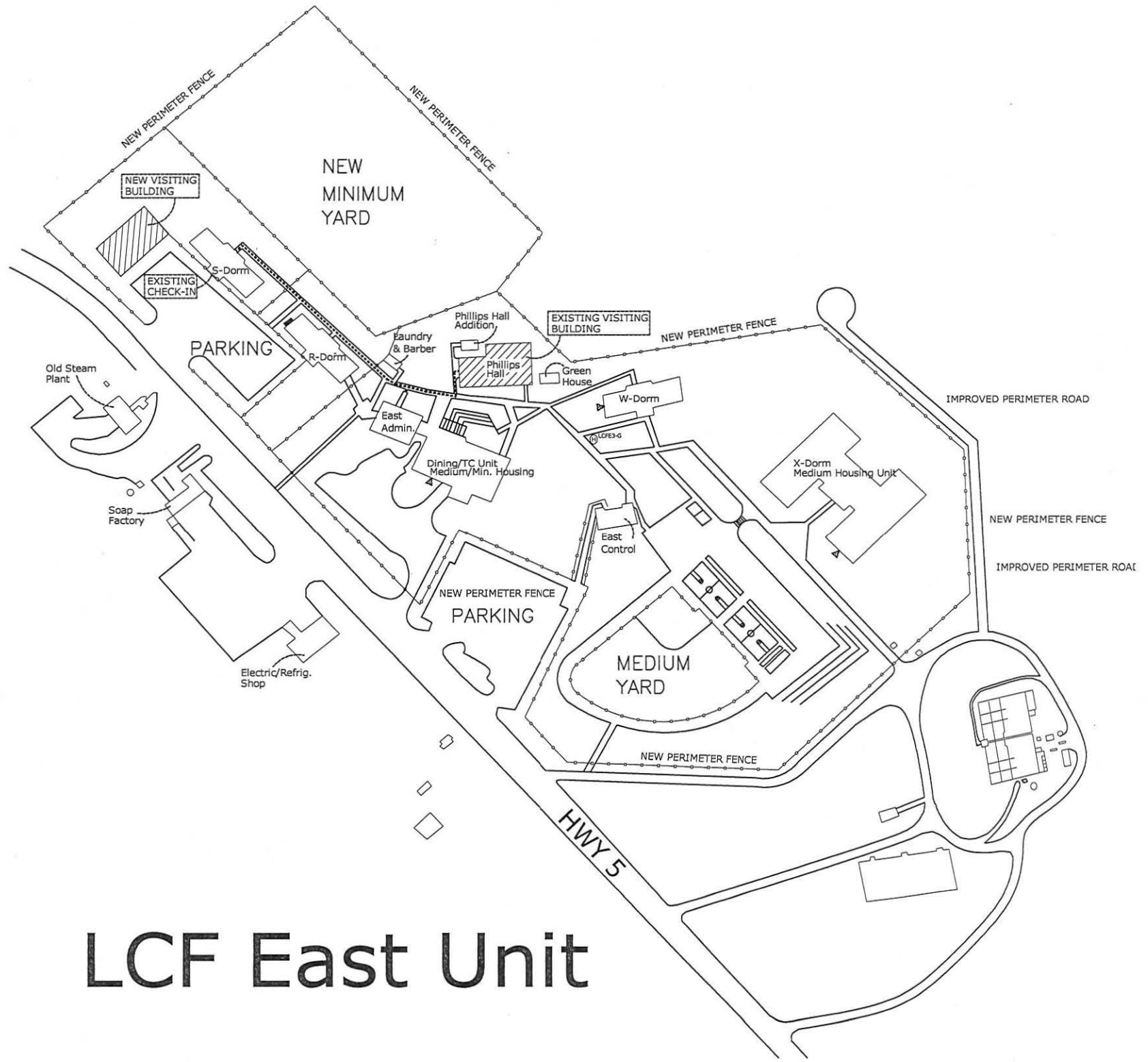

LCF East Unit

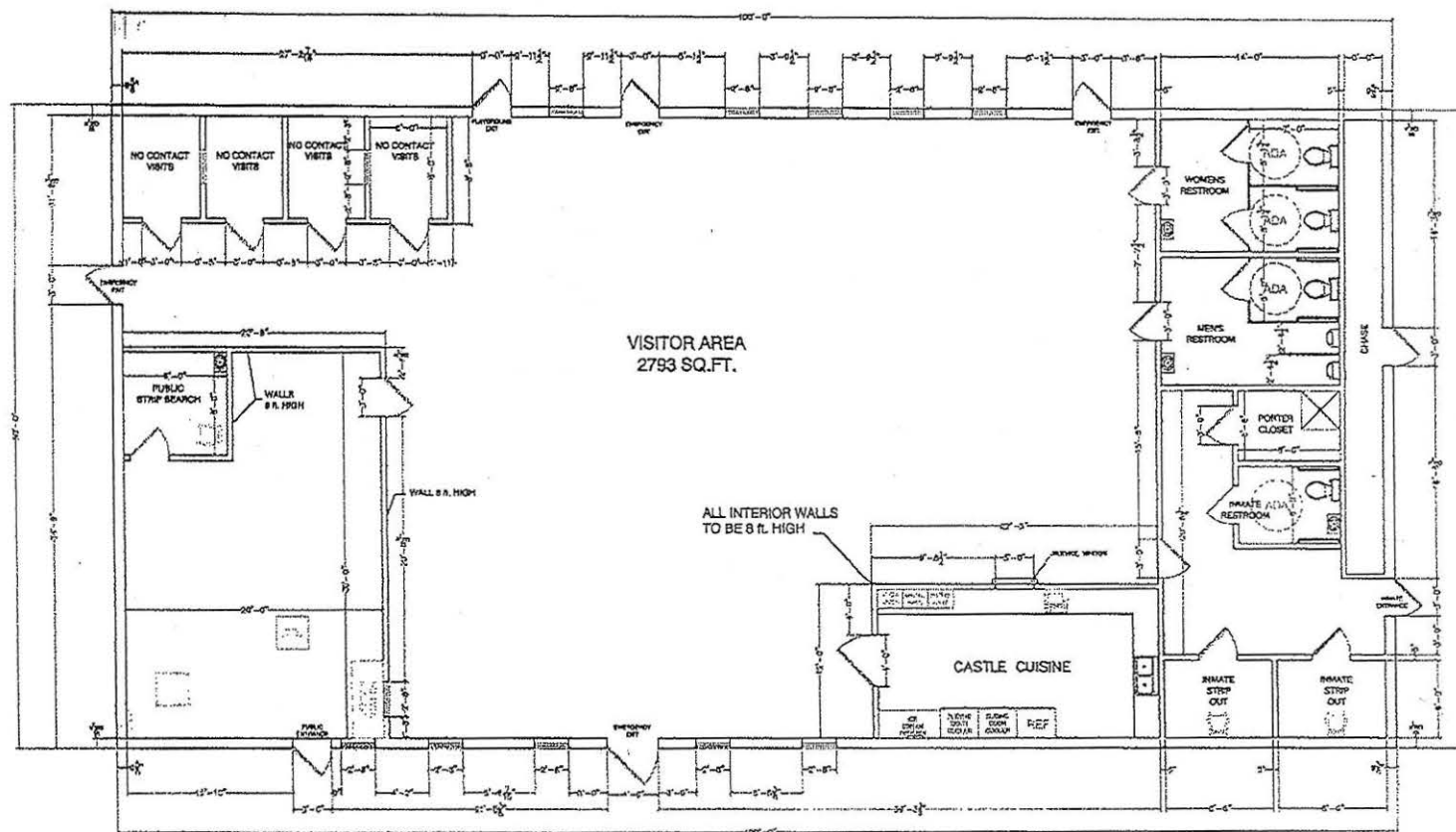

SYMBOL DESCRIPTION		
SYMBOL	DESCRIPTION	QTY
^	EXT. DOOR 4'0" L	1
^	INT. DOOR 4'0" R	1
^	EXT. DOOR 3'0" L	7
^	EXT. DOOR 3'0" R	5
^	INT. DOOR 3'0" L	3
^	INT. DOOR 3'0" R	4
^	BATH ROOM DOOR 3'0" L	3
^	BATH ROOM DOOR 3'0" R	1
—	WINDOW 3'2"	15
⊠	LAVATORY	4
⊠	SINK - DOUBLE	1
⊠	TOILET	4
⊠	URINAL	2
⊠	MOP SINK	1
⊠	COMPUTER	1

East Visitation Building Proposal  
 50 ft. x 100 ft. Building Rev. B  
 Drawn by: A. METCALF  
 04-15-15

26-4

EAST VISITING BUILDING		7/27/2015
Item	Cost	
Building Price 50x100	\$	55,000.00
Interior Lighting (LED)	\$	12,000.00
Exterior Lighting (LED)	\$	2,500.00
Electrical Rough-in & Finish	\$	68,000.00
HVAC	\$	15,000.00
Concrete and rebar - contracted	\$	32,000.00
Plumbing rough in and finish	\$	10,000.00
Dirt Work, Fuel and Parts	\$	10,000.00
Gutters and Down Spouts	\$	6,000.00
Cameral and COAX	\$	12,000.00
Grand Total	\$	222,500.00

# MEMO



**DATE:** September 15, 2015

**TO:** Johnnie Goddard, Deputy Secretary-Facilities Mgmt.

**FROM:** Rex Pryor, Warden - LCF

**CC:** File

**RE:** East Unit Visiting Building Funding Source

P.O. Box 2

Lansing, KS 66043-0002

(913) 727-3235

Fax: (913) 250-2562

[www.doc.ks.gov/facilities/lcf](http://www.doc.ks.gov/facilities/lcf)

In reference to the facility's request for the construction of a visiting building at the LCF East Unit, it has been determined that funding would be available from the agency Inmate Benefit Fund (IBF). The main source of revenue for this fund comes from the commissions from canteen and monthly package program. Revenues in the current fiscal year from this source are on target to meet estimates. This will result in an adequate ending cash balance that will support this project.

The project was also included in the FY 2016/17 IBF request and was funded in the approved budget.

Utility expenditures for the completed project would be paid from the State General Fund.

### Building Description

The proposed building will be constructed as a combined in-house and contracted effort. The dirt work for the building will be completed in-house to include site leveling and the digging of footers and underground utilities to this building.

The concrete work will be accomplished by a contractor to form, place, and finish the concrete. The finished slab will be the finished floor for the visiting building.

The building shell shall be a 50'x100' free spanning wood framed structure with metal skins, roofing and insulation. The building will include the interior finishes and partition walls.

Lighting both interior and exterior shall be LED lighting which will minimize maintenance requirements and utility costs associated with lighting.

The heating and cooling systems will consist of two 3½ ton air handlers and natural gas heat. Each of these will be piped along the ceiling centrally located for minimized cost of installation and visual disruption.